

STATE OF WISCONSIN
DEPARTMENT OF NATURAL RESOURCES

LAKE SURVEY MAP

BLACK RIVER FLOWAGE
LAKE
JACKSON COUNTY
SEG. 36.31.12.11.14 T-21.22-N. R-3,4-E.W.
15
(Sheet 3 of 3)

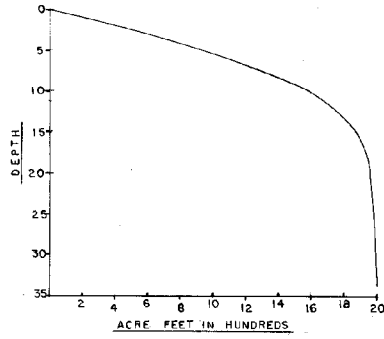
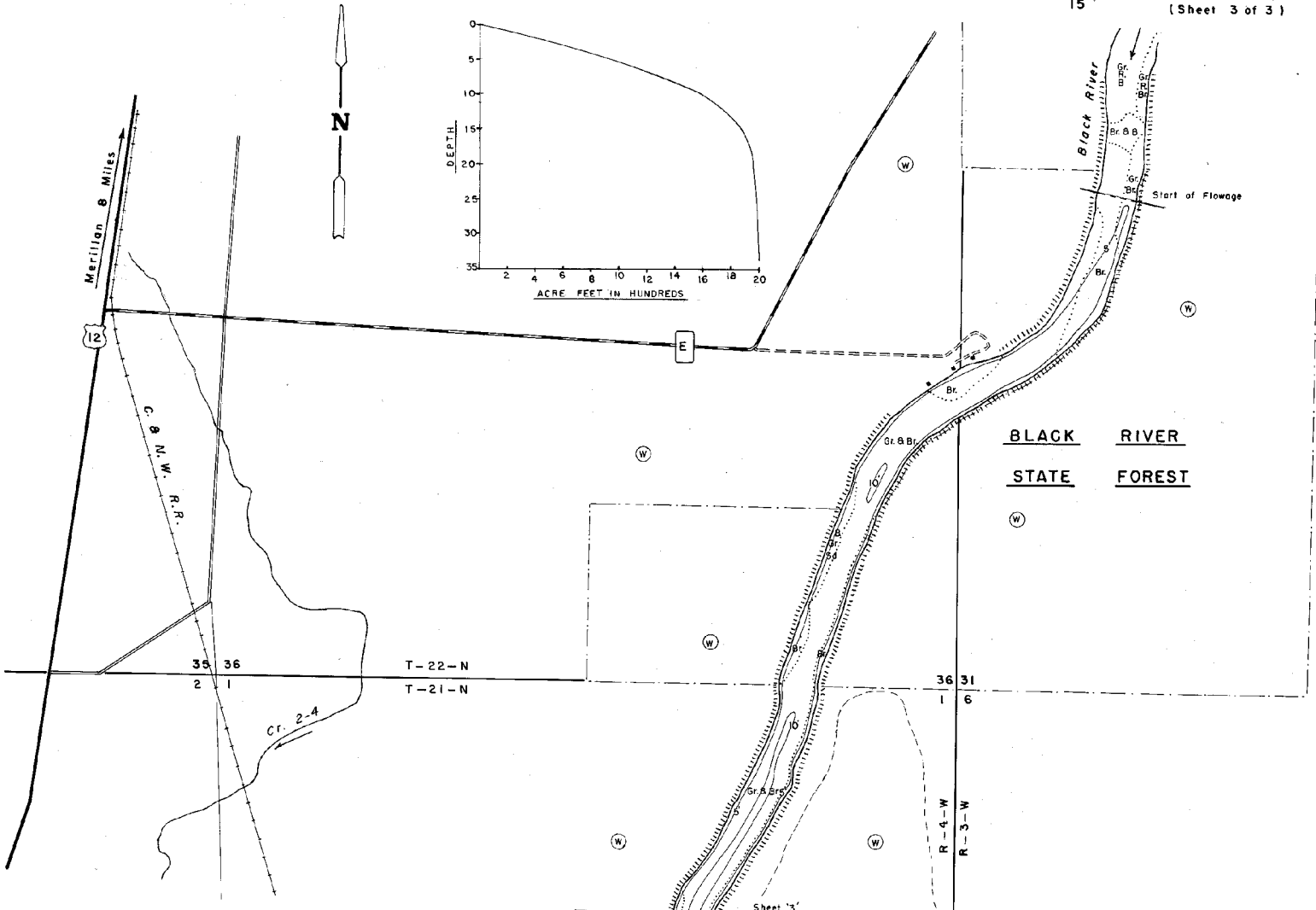

EQUIPMENT	SONAR	POLE	MAPPED	MONTH	YEAR
				JULY	1969
TOPOGRAPHIC SYMBOLS					
(B) Brush					Steep slope
(PW) Partially wooded				-----	Indefinite shoreline
(W) Wooded				-----	Marsh
(C) Cleared				-----	Spring
(P) Pastured				-----	Intermittent stream
(A) Agricultural				-----	Permanent inlet
B.M. Bench Mark				-----	Permanent outlet
■ Dwelling				-----	Dam
□ Resort				-----	D.N.R. State owned land
□ Camp					
LAKE BOTTOM SYMBOLS					
P. Peat				B	Boulders
Mk. Muck				⊙	Stumps & Snags
C. Clay				⊙	Rock danger to navigation
M. Marl				T	Submergent vegetation
Sd. Sand				⊥	Emergent vegetation
Sl. Silt				⊥	Floating vegetation
Gr. Gravel				⊥	Brush shelters
R. Rubble					
Br. Bedrock					

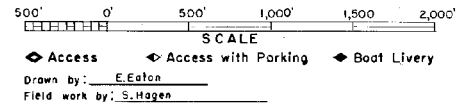

SPECIES OF FISH	PRESENT	
	Abundant	Common
Muskie	X	X
N. Pike	X	X
Walleye	X	X
L.M. Bass	X	X
S.M. Bass	X	X
Panfish	X	X
Trout		

WATER AREA 198.2 ACRES
UNDER 3 FT. 8 %
OVER 20 FT. 3 %
MAX. DEPTH 34 FEET
TOTAL ALK. 30 P.P.M.
VOLUME 1,980 ACRE FT.
SHORELINE 9.69 MILES
WITH ISL. 10.26 MILES

Maps are not for navigation
Source-Wisconsin Department of Natural Resources
Hunt Fish Camp Wisconsin .Com 2005