

WISCONSIN CONSERVATION DEPARTMENT

LAKE SURVEY MAP

BEULAH LAKE
WALWORTH COUNTY
SEC. 4, 8, 9, 17, 18 T. -4- N. R. -18- E.#.
(Sheet 1 of 2)

B.M. 'X' FX-N-37 Also P.S.C. B.M.
Bronze tablet top center guard rail of S. side
bridge on C.T.H. 'J'
Elevation 814.39

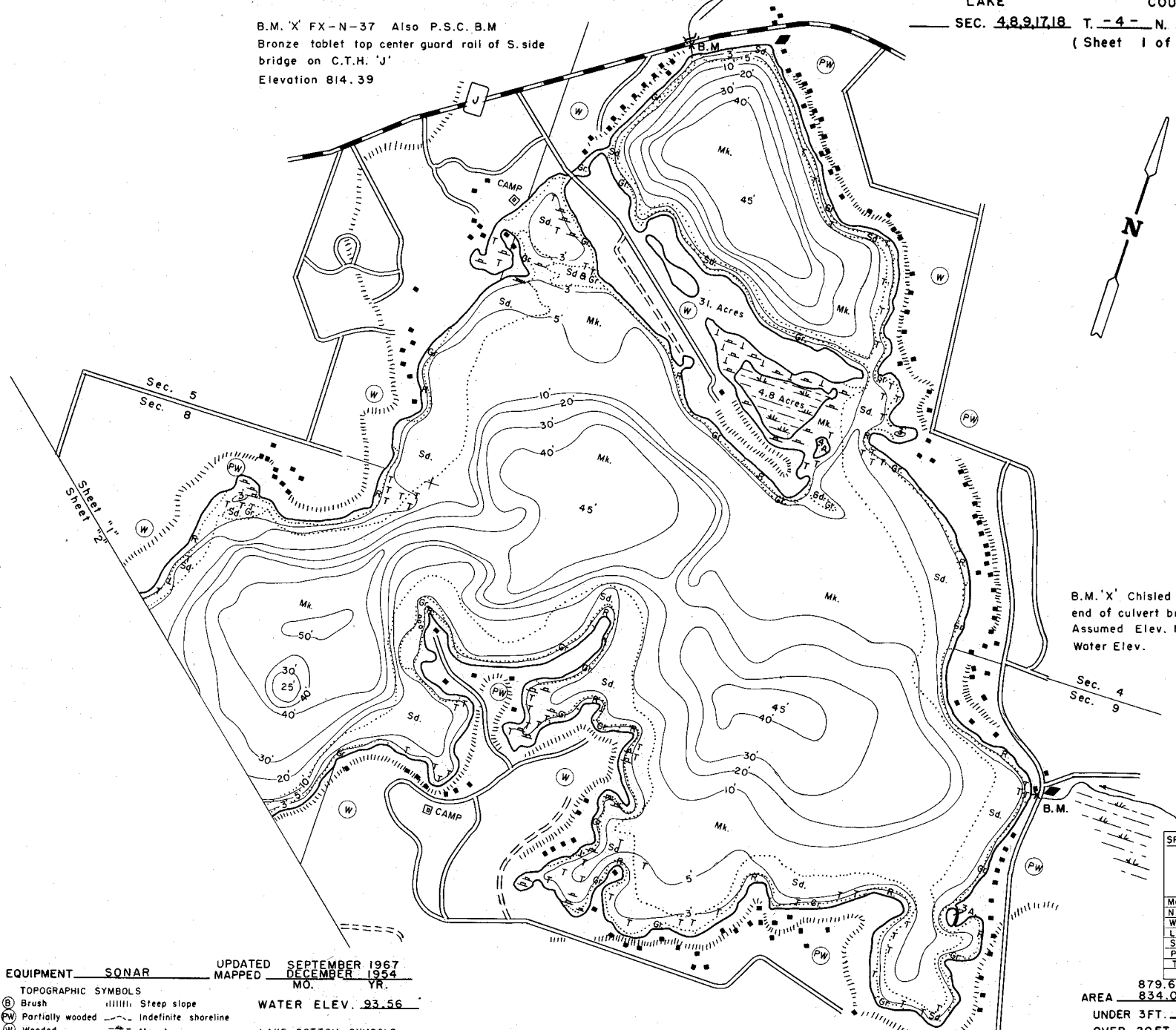

B.M. 'X' Chisled □ on N.W.
end of culvert bridge
Assumed Elev. 100.00'
Water Elev. 93.56'

EQUIPMENT SONAR
UPDATED SEPTEMBER 1967
MAPPED DECEMBER 1954
MO. YR.

- TOPOGRAPHIC SYMBOLS
- ⊙ Brush
 - ⊙ Partially wooded
 - ⊙ Wooded
 - ⊙ Cleared
 - ⊙ Pastured
 - ⊙ Agricultural
 - B.M. Bench Mark

- LAKE BOTTOM SYMBOLS
- P. Peat
 - Mk. Muck
 - C. Clay
 - M. Marl
 - Gr. Gravel
 - R. Rubble
 - Br. Bedrock
 - T. Submergent vegetation
 - Stumps & Snags

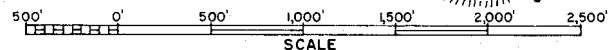

879.6 WITH ISL.
AREA 834.0 ACRES
UNDER 3 FT. 13 %
OVER 20 FT. 34 %
VOLUME 14,279.0 ACRE FT.
TOTAL ALK. 168 P.P.M.
SHORELINE 15.3 MILES

SPECIES OF FISH	Abundant	Common	Rare
Muskie			
N. Pike			X
Walleye			X
L. M. Bass	X		
S. M. Bass	X		
Panfish	X		
Trout			