

STATE OF WISCONSIN
DEPARTMENT OF NATURAL RESOURCES

LAKE SURVEY MAP

ARBUTUS LAKE CLARK JACKSON COUNTY
SEC. 24, 25, 35, 36, 2, 3 T. -22, 23- N. R. - 3 - E.W.
(Sheet 3 of 3)

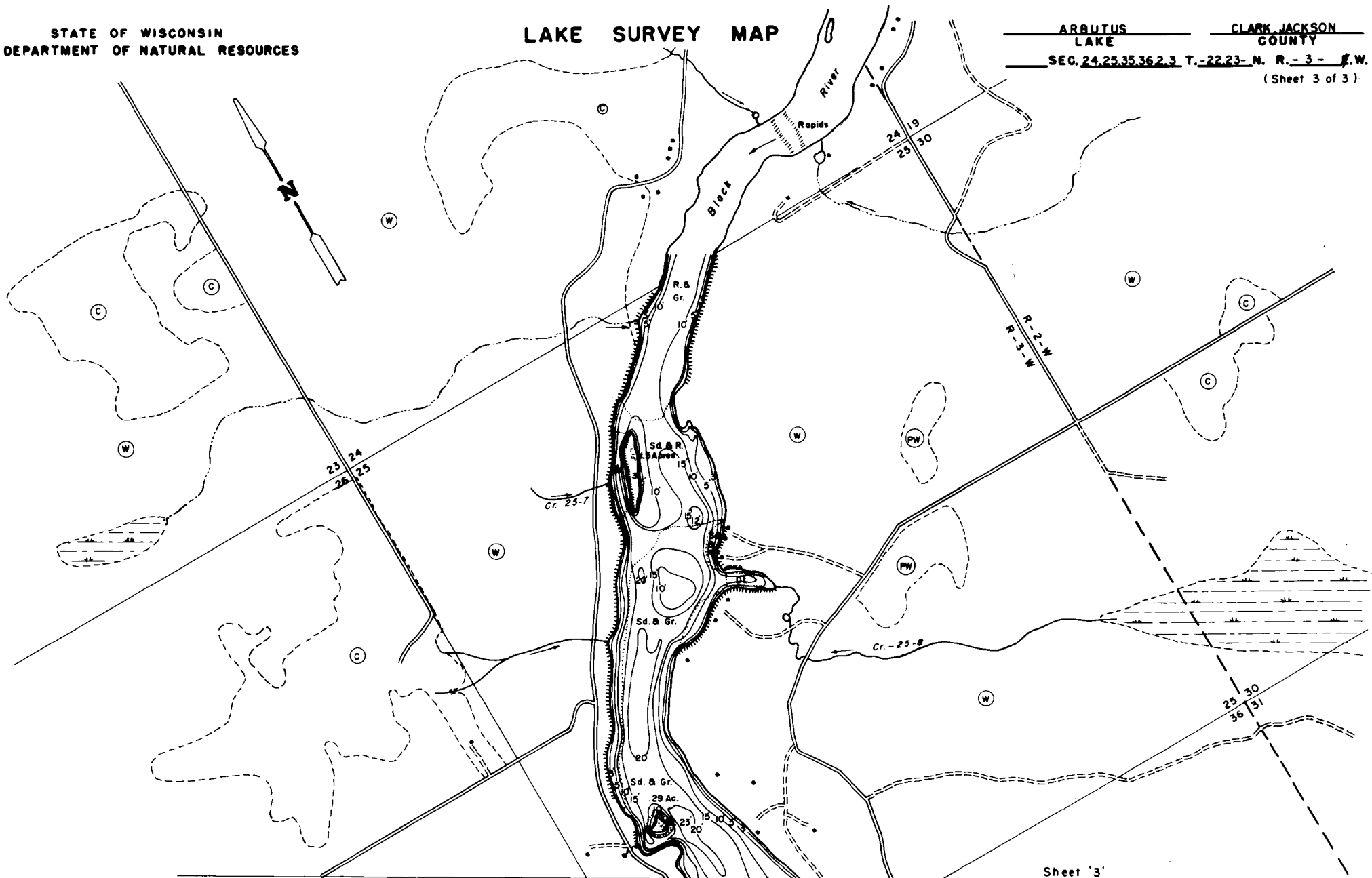

Sheet '3'
Sheet '2'

EQUIPMENT RECORDING SONAR MAPPED JULY 1973

- | TOPOGRAPHIC SYMBOLS | | MONTH | YEAR | LAKE BOTTOM SYMBOLS | |
|-----------------------|------------------------|------------|------|-----------------------------|--|
| (B) Brush | Sleep slope | P. Peat | | B Boulders | |
| (PW) Partially wooded | ~ Indefinite shoreline | Mk. Muck | | ⌘ Slumps & Snags | |
| (W) Wooded | ~ Marsh | C. Clay | | ⊗ Rock danger to navigation | |
| (C) Cleared | ~ Spring | M. Marl | | T Submergent vegetation | |
| (P) Pastured | ~ Intermittent stream | Sd. Sand | | I Emergent vegetation | |
| (A) Agricultural | ~ Permanent inlet | St. Silt | | F Floating vegetation | |
| B.M. Bench Mark | ~ Permanent outlet | Gr. Gravel | | ⌘ Brush shelters | |



| SPECIES OF FISH | ABUNDANT | | PRESENT | |
|-----------------|----------|---|---------|---|
| | X | ✓ | X | ✓ |
| Muskie | | | X | |
| N. Pine | | | X | |
| Walleye | X | | X | |
| L. M. Bass | | | X | |
| S. M. Bass | | | X | |

WATER AREA 839.24 ACRES
 UNDER 3 FT. 6 %
 OVER 20 FT. 32 %
 MAX. DEPTH 50 FEET.
 TOTAL ALK. 19 P.P.M.
 VOLUME 13,397 ACRE FT.