

STATE OF WISCONSIN
DEPARTMENT OF NATURAL RESOURCES

LAKE SURVEY MAP

UNDERWOOD LAKE OCONTO COUNTY
SEC. 30 T. 30 N. R. 19 E.W.

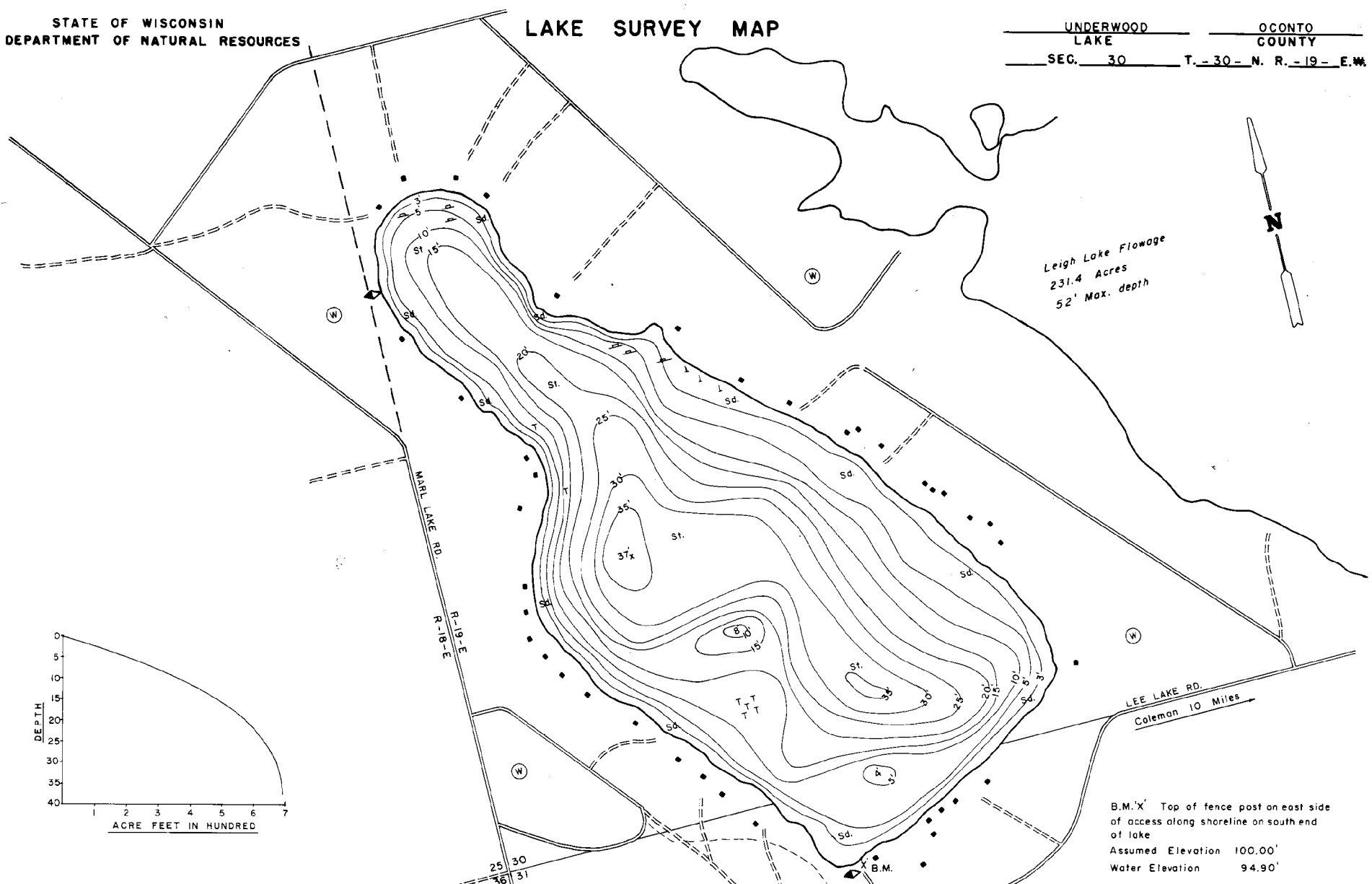

Leigh Lake Flowage
231.4 Acres
52' Max. depth

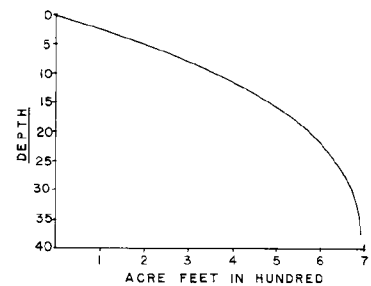

B.M. 'X' Top of fence post on east side of access along shoreline on south end of lake
Assumed Elevation 100.00'
Water Elevation 94.90'

- | | | |
|---|----------------------------|-------------------------------|
| EQUIPMENT RECORDING SONAR MAPPED | JUNE 1974 | MONTH YEAR |
| TOPOGRAPHIC SYMBOLS | LAKE BOTTOM SYMBOLS | |
| (B) Brush | Steep slope | P. Peat |
| (W) Partially wooded | ----- Indefinite shoreline | Mk. Muck |
| (W) Wooded | (M) Marsh | S. Stumps & Snags |
| (C) Cleared | (S) Spring | (R) Rock danger to navigation |
| (A) Pastured | (I) Intermittent stream | (T) Submergent vegetation |
| (A) Agricultural | (PI) Permanent inlet | (E) Emergent vegetation |
| B.M. Bench Mark | (PO) Permanent outlet | (F) Floating vegetation |
| (D) Dwelling | (D) Dam | (BS) Brush shelters |
| (R) Resort | (D.N.R.) State owned land | |
| (C) Camp | | |

200' 0' 200' 400' 600' 800'
SCALE
◆ Access ◆ Access with Parking ◆ Boat Livery
Drawn by: E. Eaton
Field work by: A. Baese, R. Thrun

| SPECIES OF FISH | Abundance | |
|-----------------|-----------|---------|
| | Abundant | Present |
| Muskie | | |
| N. Pike | | X |
| Walleye | | X |
| L. M. Bass | X | |
| S. M. Bass | X | |
| Panfish | X | |
| Trout | | |

WATER AREA 44.6 ACRES
UNDER 3 FT. 9 %
OVER 20 FT. 32 %
MAX. DEPTH 37 FEET.
TOTAL ALK. 86 P.P.M.
VOLUME 692.3 ACRE FT.
MAIN SHORELINE 1.25 MI.
ISLAND SHORELINE MI.