

STATE OF WISCONSIN
DEPARTMENT OF NATURAL RESOURCES

LAKE SURVEY MAP

TWO BOYS LAKE SAWYER COUNTY
SEC. 3, 34, 35 T. 40 N. R. 7 W.

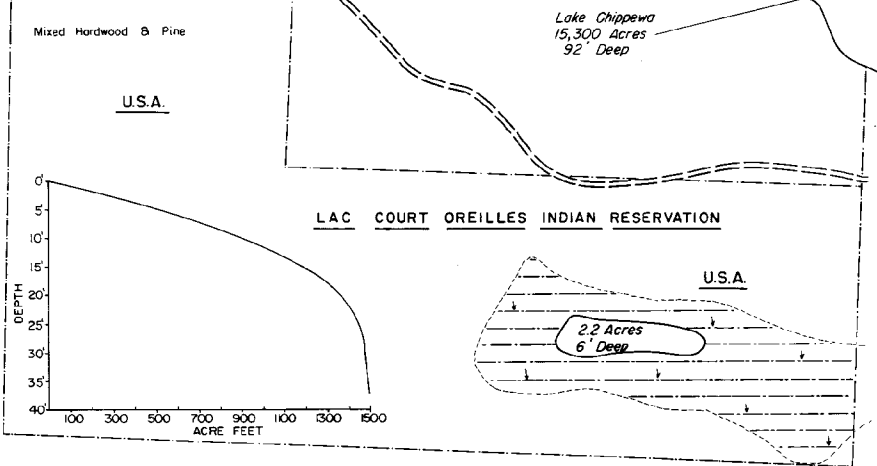
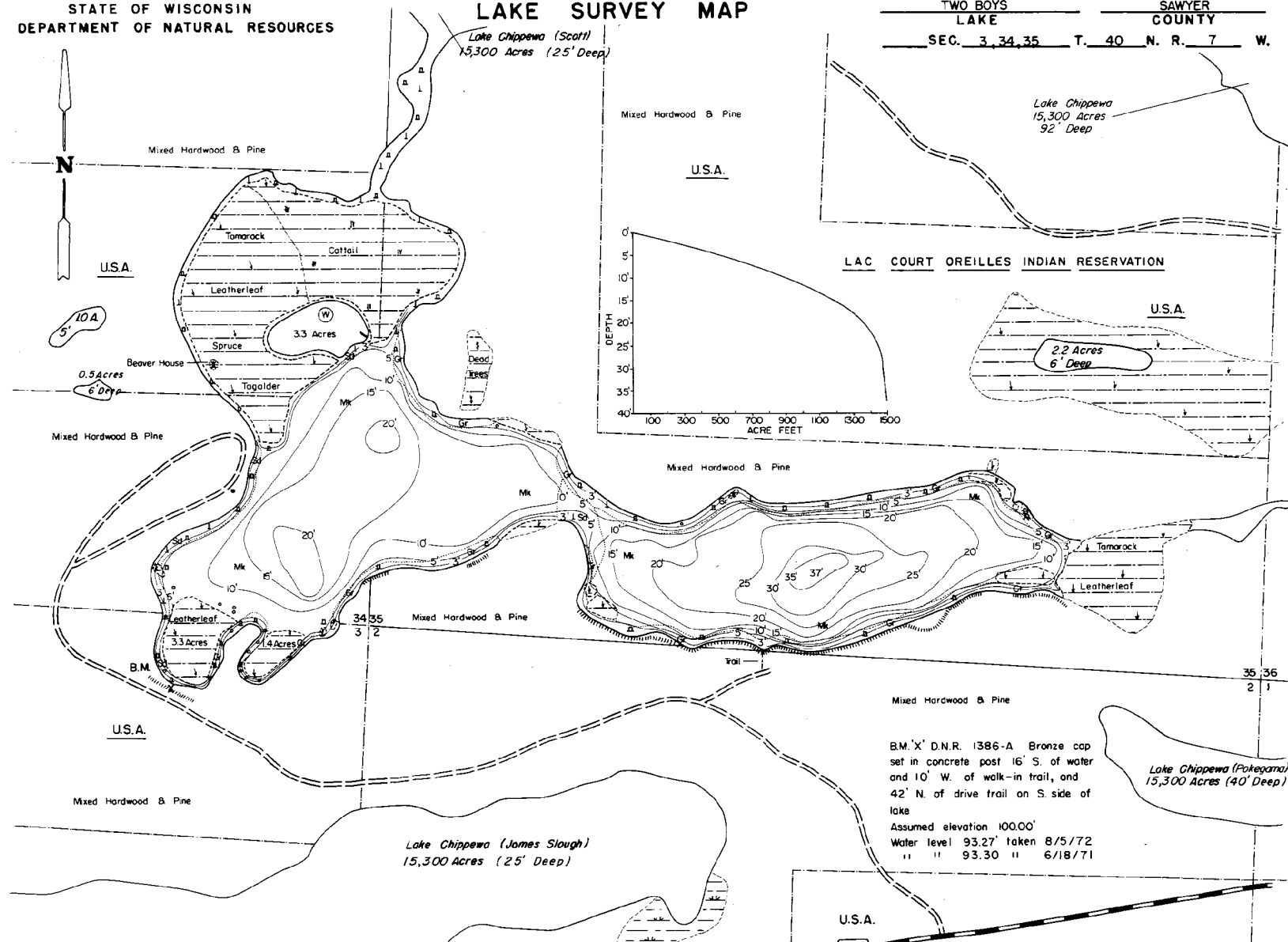

B.M. 'X' D.N.R. 1386-A Bronze cap set in concrete post 16' S. of water and 10' W. of walk-in trail, and 42' N. of drive trail on S. side of lake
Assumed elevation 100.00'
Water level 93.27' taken 8/5/72
" " 93.30 " 6/18/71

EQUIPMENT RECORDING SONAR MAPPED JUNE 1971

- | TOPOGRAPHIC SYMBOLS | | LAKE BOTTOM SYMBOLS | |
|-----------------------|---------------------------|---------------------|-----------------------------|
| (B) Brush | Steep slope | P. Peat | B Boulders |
| (PW) Partially wooded | ~ Indefinite shoreline | Mk. Muck | ⚡ Stumps & Snags |
| (W) Wooded | ~ Marsh | C. Clay | ⚡ Rock danger to navigation |
| (C) Cleared | ~ Spring | M. Marl | T Submergent vegetation |
| (P) Pastured | ~ Intermittent stream | Sd. Sand | ↑ Emergent vegetation |
| (A) Agricultural | ~ Permanent inlet | St. Silt | ↑ Floating vegetation |
| B.M. Bench Mark | ~ Permanent outlet | Gr. Gravel | ↑ Brush shelters |
| ■ Dwelling | ~ Dam | R. Rubble | |
| ■ Resort | ~ D.N.R. State owned land | Br. Bedrock | |
| ■ Camp | | | |



Drawn by: C. Holt
Field work by: C. Busch, G. Lund, J. Sather

SPECIES OF FISH	STATUS	
	1971	Present
Muskie		X
N. Pike		X
Walleye		X
L. M. Bass		X
S. M. Bass		X
Panfish		X
Trout		

WATER AREA 102.3 ACRES
UNDER 3 FT. 14.3 %
OVER 20 FT. 20.8 %
MAX. DEPTH 37 FEET.
TOTAL ALK. 15 P.P.M.
VOLUME 1492 ACRE FT.
SHORELINE 3.32 MILES
SHORELINE 5.62 MILES WITH IS.