

STATE OF WISCONSIN
DEPARTMENT OF NATURAL RESOURCES

LAKE SURVEY MAP

TOTAGATIC FLOWAGE SAWYER, WASHBURN
LAKE COUNTY
SEC. 12, 13, 18, 19, 20 T. - 42 - N. R. - 9, 10 - E. W.

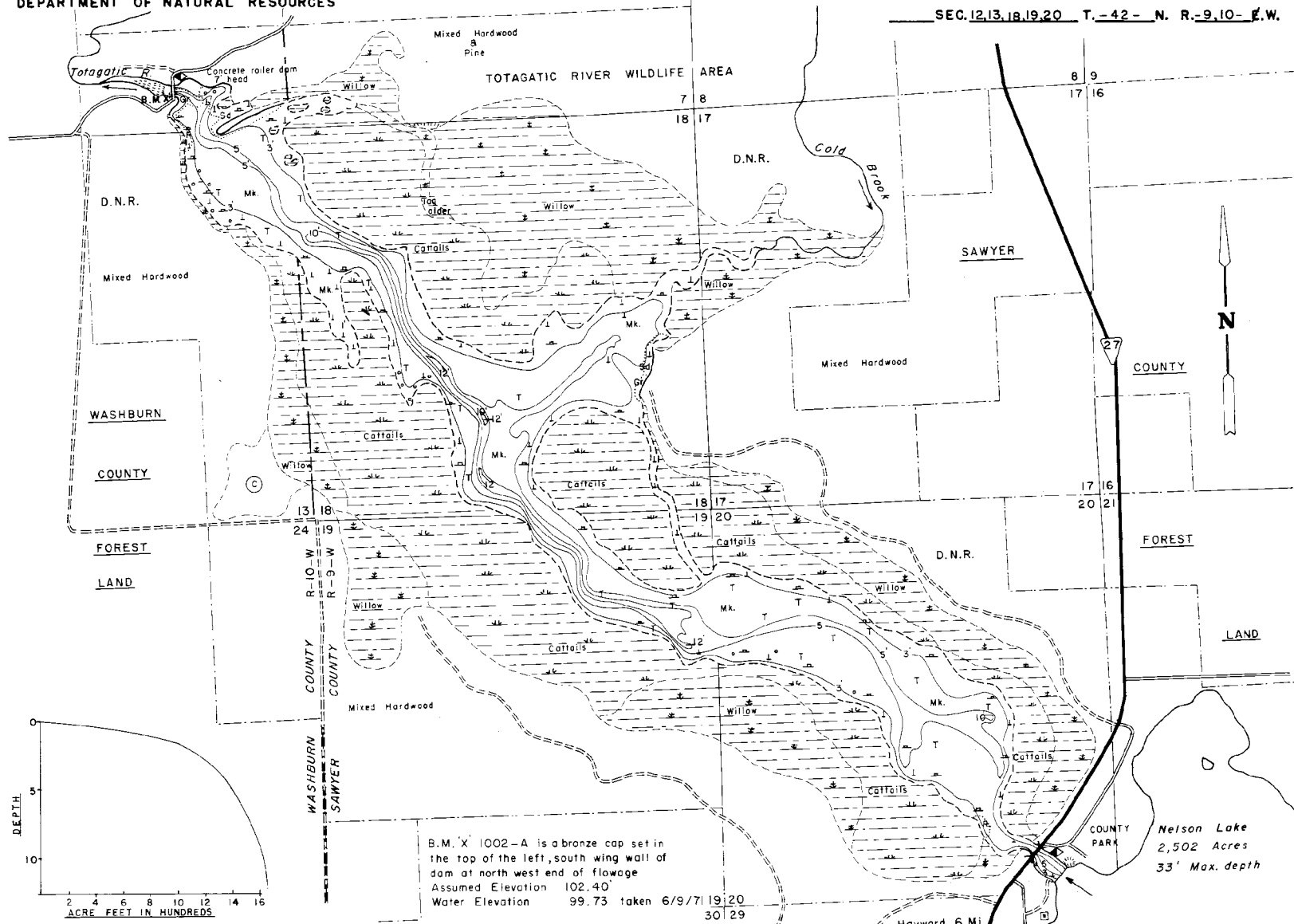

B.M. X 1002-A is a bronze cap set in the top of the left, south wing wall of dam at north west end of flowage
Assumed Elevation 102.40
Water Elevation 99.73 taken 6/9/71 19:20
30:29

Nelson Lake
2,502 Acres
33' Max. depth

- EQUIPMENT RECORDING SONAR MAPPED JUNE 1971
- | TOPOGRAPHIC SYMBOLS | | LAKE BOTTOM SYMBOLS | |
|-----------------------|---------------------------|---------------------|-----------------------------|
| (B) Brush | Steep slope | P. Peat | B Boulders |
| (PW) Partially wooded | ~ Indefinite shoreline | Mk. Muck | o Stumps & Snags |
| (W) Wooded | ~ Marsh | C. Clay | ⚡ Rock danger to navigation |
| (C) Cleared | ~ Spring | M. Marl | T Submergent vegetation |
| (P) Pastured | ~ Intermittent stream | Sd. Sand | ⌋ Emergent vegetation |
| (A) Agricultural | ~ Permanent inlet | St. Silt | ~ Floating vegetation |
| B.M. Bench Mark | ~ Permanent outlet | Gr. Gravel | ⚡ Brush shelters |
| (D) Dwelling | ~ Dam | R. Rubble | |
| (R) Resort | ~ D.N.R. State owned land | Bc. Bedrock | |
| (C) Camp | | | |



Drawn by: E. Eaton
Field work by: C. Busch, G. Lund, L. Sather

SPECIES OF FISH

	Abundant	Common	Present
Muskie			
N. Pike	X		
Walleye	X	X	
L. M. Bass		X	
S. M. Bass			
Panfish	X		
Trout			

WATER AREA 392.7 ACRES
UNDER 3 FT. 27 %
OVER 20 FT. 0 %
MAX. DEPTH 12 FEET.
TOTAL ALK. 33 P.P.M.
VOLUME 1,636 ACRE FT.
SHORELINE 9.43 MILES