

STATE OF WISCONSIN
DEPARTMENT OF NATURAL RESOURCES

LAKE SURVEY MAP

TILLEDA POND
LAKE
SEC. 15 T. 27 N. R. 13 E. #

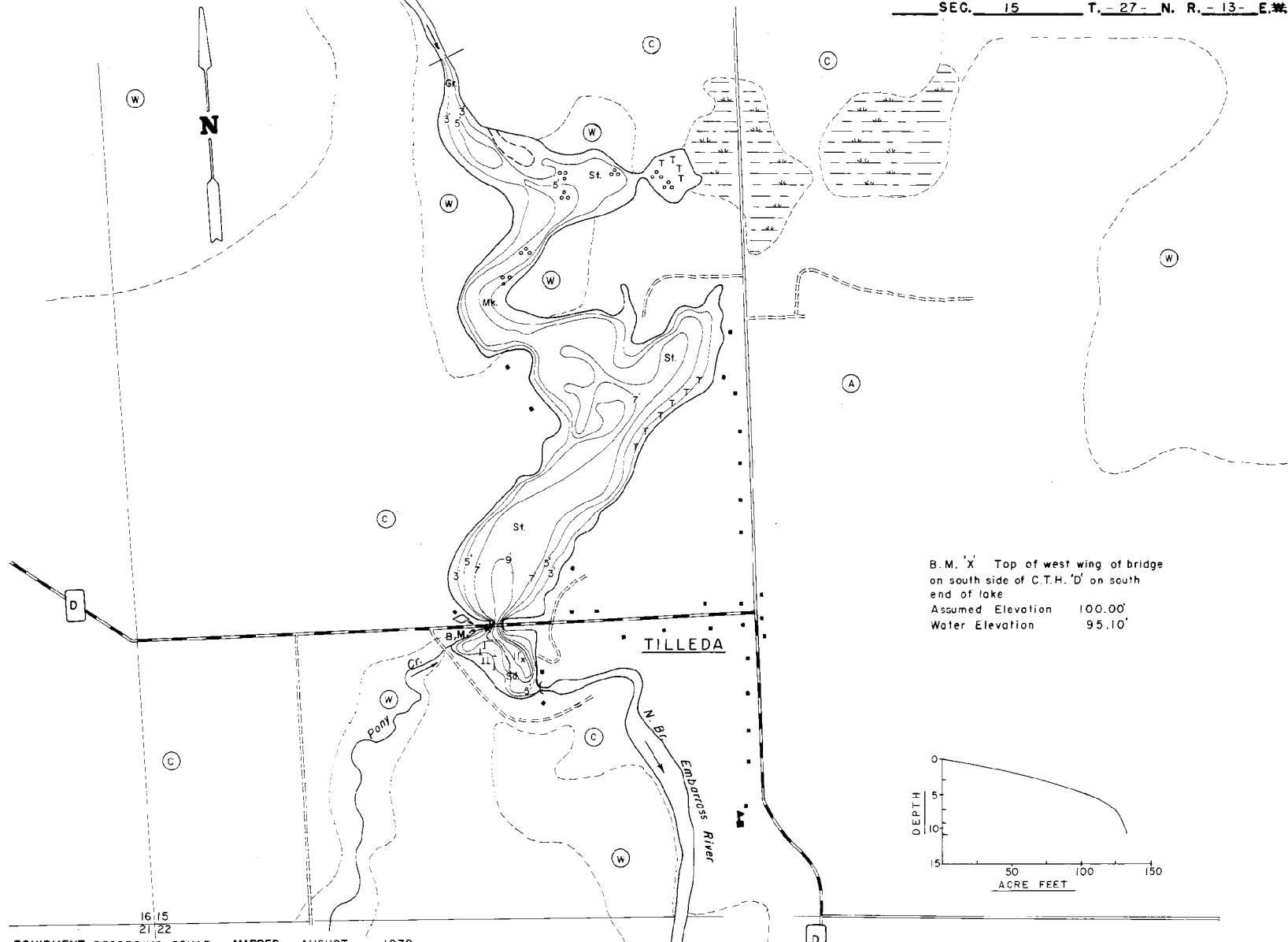

B. M. 'X' Top of west wing of bridge
on south side of C.T.H. 'D' on south
end of lake
Assumed Elevation 100.00'
Water Elevation 95.10'

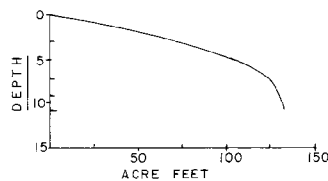

EQUIPMENT RECORDING SONAR MAPPED AUGUST 1972
MONTH YEAR
LAKE BOTTOM SYMBOLS

- | | | | |
|---|--|---|--|
| <ul style="list-style-type: none"> (B) Brush (W) Partially wooded (W) Wooded (C) Cleared (P) Pastured (A) Agricultural B.M. Bench Mark (D) Dwelling (R) Resort | <ul style="list-style-type: none"> Steep slope ----- Indefinite shoreline Marsh Spring Intermittent stream Permanent inlet Permanent outlet Dam D.N.R. State owned land | <ul style="list-style-type: none"> P. Peat Mk. Muck C. Clay M. Marl Sd. Sand St. Silt Gr. Gravel R. Rubble Bc. Bedrock | <ul style="list-style-type: none"> B Boulders Stumps & Snags Rock danger to navigation T Submergent vegetation Emergent vegetation Floating vegetation Brush shelters |
|---|--|---|--|



Access Access with Parking Boat Livery

Drawn by: E. Eaton
Field work by: D. Boese, M. Schrage

SPECIES OF FISH	ABUNDANCE		
	Abundant	Common	Present
Muskie			
N. Pike			
Walleye			
L. M. Bass	X		
S. M. Bass	X		
Panfish			X
Trout			X

WATER AREA 27.8 ACRES
UNDER 3 FT. 25 %
OVER 20 FT. 0 %
MAX. DEPTH 11 FEET.
TOTAL ALK. 103 P.P.M.
VOLUME 132.5 ACRE FT.
SHORELINE 1.99 MILES