

STATE OF WISCONSIN  
DEPARTMENT OF NATURAL RESOURCES

LAKE SURVEY MAP

SUMMIT LAKE COUNTY  
SEC. 14 T. 38 N. R. 9 E.W.

B.M. X is a 2' sq. cut on top of a concrete platform, located 12' E. of lake and 84' S. of public boat landing.  
Assumed elevation 100.00  
Water level 94.94'  
taken 8/20/70

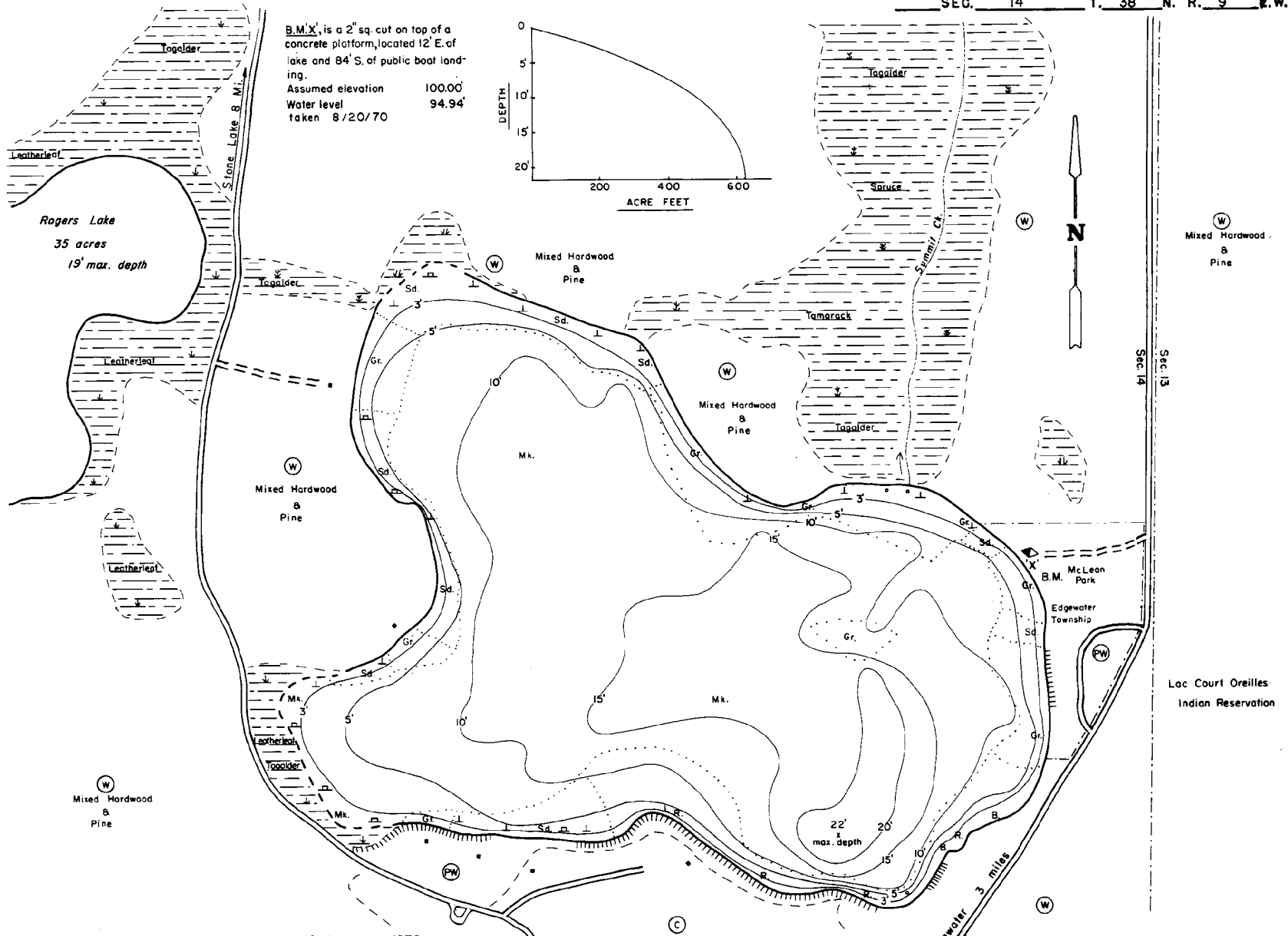
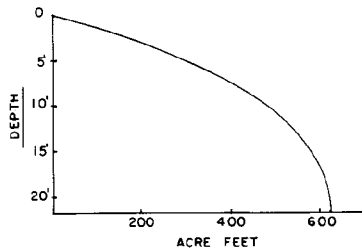

EQUIPMENT RECORDING SONAR MAPPED AUG. 1970

TOPOGRAPHIC SYMBOLS

- (B) Brush
- (PW) Partially wooded
- (W) Wooded
- (C) Cleared
- (P) Pastured
- (A) Agricultural
- B.M. Bench Mark
- (D) Dwelling
- (R) Resort
- (D.N.R.) State owned land

LAKE BOTTOM SYMBOLS

- P. Peat
- Mk. Muck
- C. Clay
- M. Marl
- Sd. Sand
- St. Silt
- Gr. Gravel
- R. Rubble
- Bc Bedrock
- Steep slope
- Indefinite shoreline
- Marsh
- Spring
- Intermittent stream
- Permanent inlet
- Permanent outlet
- Dam
- D.N.R. State owned land
- B Boulders
- Stumps & Snags
- Rock danger to navigation
- T Submergent vegetation
- I Emergent vegetation
- F Floating vegetation
- Brush shelters



Access Access with Parking Boat Livery

Drawn by: T. Ginder  
Field work by: C. Busch, C. Stocks, & L. Sather

SPECIES OF FISH	Abundance		
	Abundant	Common	Present
Muskie			
N. Pike			
Walleye			
L. M. Bass	X		
S. M. Bass	X		
Panfish	X		
Trout			

WATER AREA 60.5 ACRES  
UNDER 3 FT. 11 %  
OVER 20 FT. 4 %  
MAX. DEPTH 22 FEET.  
TOTAL ALK. 11 P.P.M.  
VOLUME 619.2 ACRE FT.  
SHORELINE 1.39 MILES