

STATE OF WISCONSIN  
DEPARTMENT OF NATURAL RESOURCES

LAKE SURVEY MAP

SPRING LAKE BARRON COUNTY  
SEC. 24.25 T. -36 - N. R. -14- W.

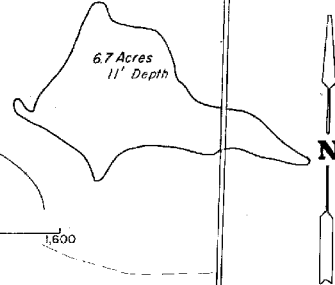
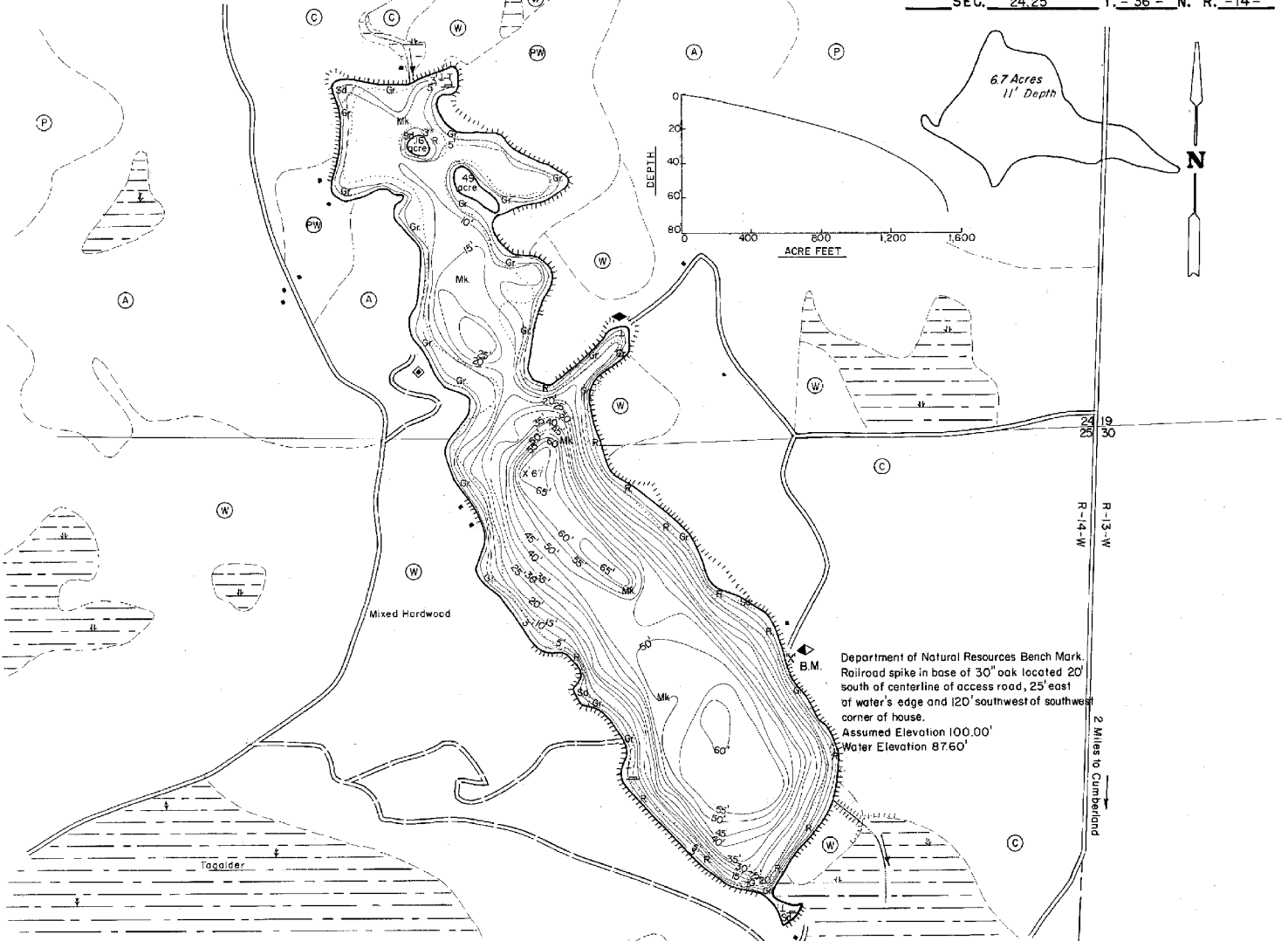

Department of Natural Resources Bench Mark.  
Railroad spike in base of 30" oak located 20'  
south of centerline of access road, 25' east  
of water's edge and 120' southwest of southwest  
corner of house.  
Assumed Elevation 100.00'  
Water Elevation 87.60'

EQUIPMENT RECORDING SONAR MAPPED	MONTH	YEAR
TOPOGRAPHIC SYMBOLS	LAKE	BOTTOM
(B) Brush	iiiiiii	Sleep slope
(PW) Partially wooded	-----	Indefinite shoreline
(W) Wooded		Marsh
(C) Cleared	o	Spring
(P) Pastured	-----	Intermittent stream
(A) Agricultural	=====	Permanent inlet
B.M. Bench Mark	-----	Permanent outlet
(D) Dwelling	-----	Dam
(R) Resort	-----	D.N.R. State owned land
(C) Camp	-----	
	P	Peat
	Mk.	Muck
	C	Clay
	M	Mari
	Sd.	Sand
	St.	Silt
	Gr.	Gravel
	R	Rubble
	Bc	Bedrock
	B	Boulders
	o	Stumps & Snags
	o	Rock danger to navigation
	T	Submergent vegetation
	I	Emergent vegetation
	o	Floating vegetation
	o	Brush shelters

300' 0 300' 600' 900' 1,200'  
SCALE  
◆ Access ◆ Access with Parking ◆ Boat Livery  
Drawn by: J. Roth  
Field work by: C. Busch, C. Reiter

SPECIES OF FISH	ABUNDANCE		
	Abundant	Common	Present
Muskie			
N. Pike	X		
Walleye	X		
L.M. Bass	X		
S.M. Bass	X		
Pontfish	X		
Trout			

WATER AREA 60.3 ACRES  
UNDER 3 FT. 13 %  
OVER 20 FT. 51 %  
MAX. DEPTH 67 FEET  
TOTAL ALK. 10 P.P.M.  
VOLUME 1,520.6 ACRE FT.  
SHORELINE 2.30 MILES  
WITHOUT ISL. 2.13 MILES

Maps are not for navigation  
Source-Wisconsin Department of Natural Resources  
Hunt Fish Camp Wisconsin .Com 2005