

WISCONSIN CONSERVATION DEPARTMENT

LAKE SURVEY MAP

SPIRIT LAKE PRICE, TAYLOR COUNTY  
 SEC. 5, 32 T-33, 34 - N. R. 3 - E.

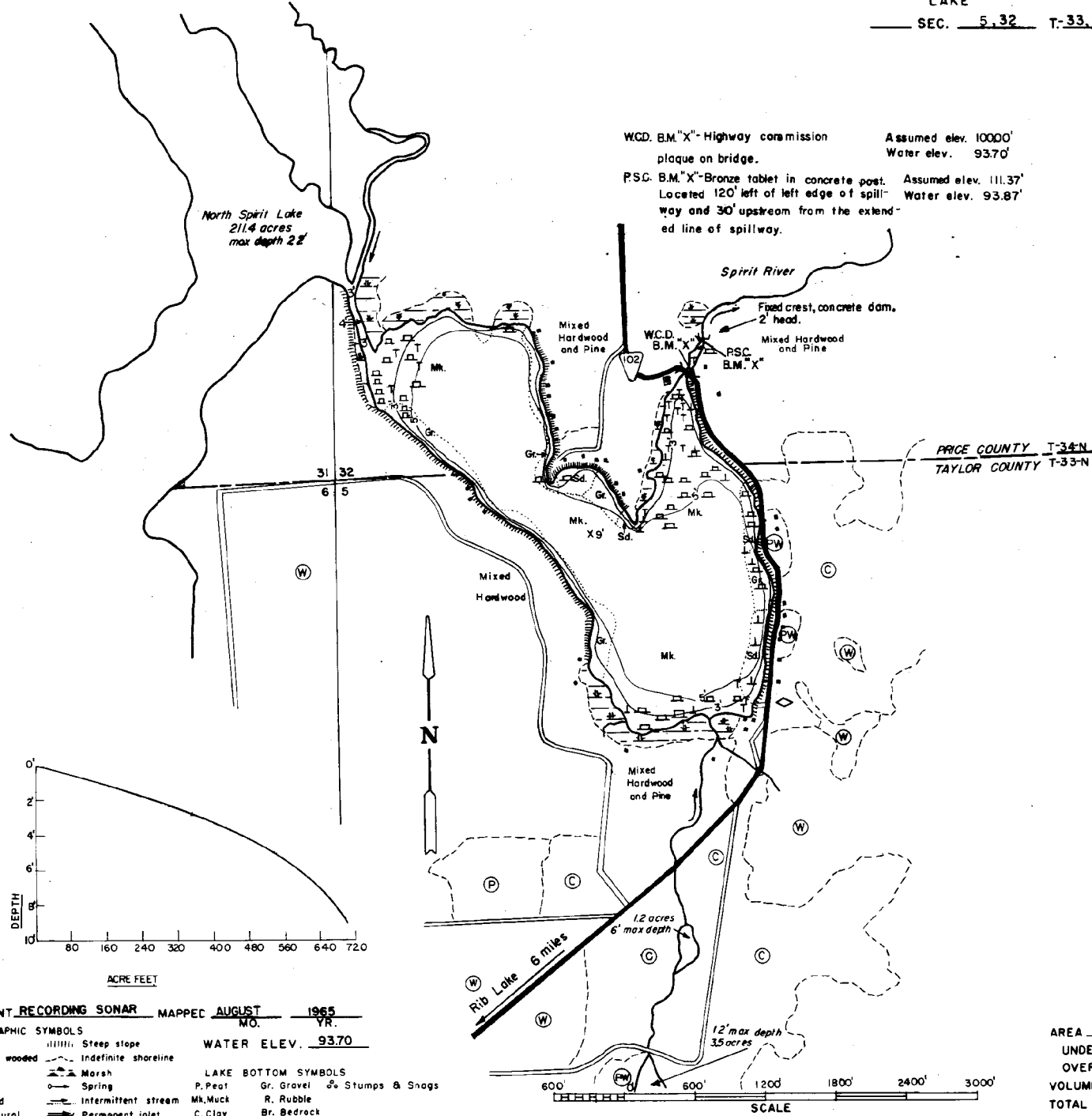

W.C.D. B.M. "X" - Highway commission  
 plaque on bridge. Assumed elev. 10000'  
 Water elev. 93.70'

P.S.C. B.M. "X" - Bronze tablet in concrete post.  
 Located 120' left of left edge of spillway  
 and 30' upstream from the extended  
 line of spillway. Assumed elev. 111.37'  
 Water elev. 93.87'

PRICE COUNTY T-34-N  
 TAYLOR COUNTY T-33-N

EQUIPMENT RECORDING SONAR MAPPED AUGUST 1965  
 MO. YR.  
 WATER ELEV. 93.70

TOPOGRAPHIC SYMBOLS  
 (B) Brush (|||||) Steep slope  
 (W) Partially wooded (---) Indefinite shoreline  
 (V) Wooded (---) Marsh  
 (C) Cleared (---) Spring  
 (P) Pastured (---) Intermittent stream  
 (A) Agricultural (---) Permanent inlet

LAKE BOTTOM SYMBOLS  
 P. Peat Gr. Gravel & Stumps & Snags  
 Mk. Muck R. Rubble  
 C. Clay Br. Bedrock

| SPECIES OF FISH |   | Abundant | Common | Rare |
|-----------------|---|----------|--------|------|
| Muskie          |   |          |        | X    |
| N. Pike         |   |          |        |      |
| Walleye         |   | X        |        |      |
| L. M. Bass      |   |          |        |      |
| S. M. Bass      |   |          |        |      |
| Panfish         | X |          |        |      |
| Trout           |   |          |        |      |

AREA 126.38 ACRES  
 UNDER 3FT. 15.6 %  
 OVER 20FT. 0.0 %  
 VOLUME 701.51 ACRE FT.  
 TOTAL ALK. 4.7 P.P.M.  
 SHORELINE 3.51 MILES