

WISCONSIN CONSERVATION DEPARTMENT

LAKE SURVEY MAP

SCOTT LAKE BARRON COUNTY
 SEC. 16 T. - 35 - N. R. - 14 - P.W.

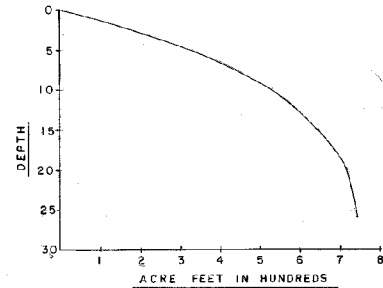
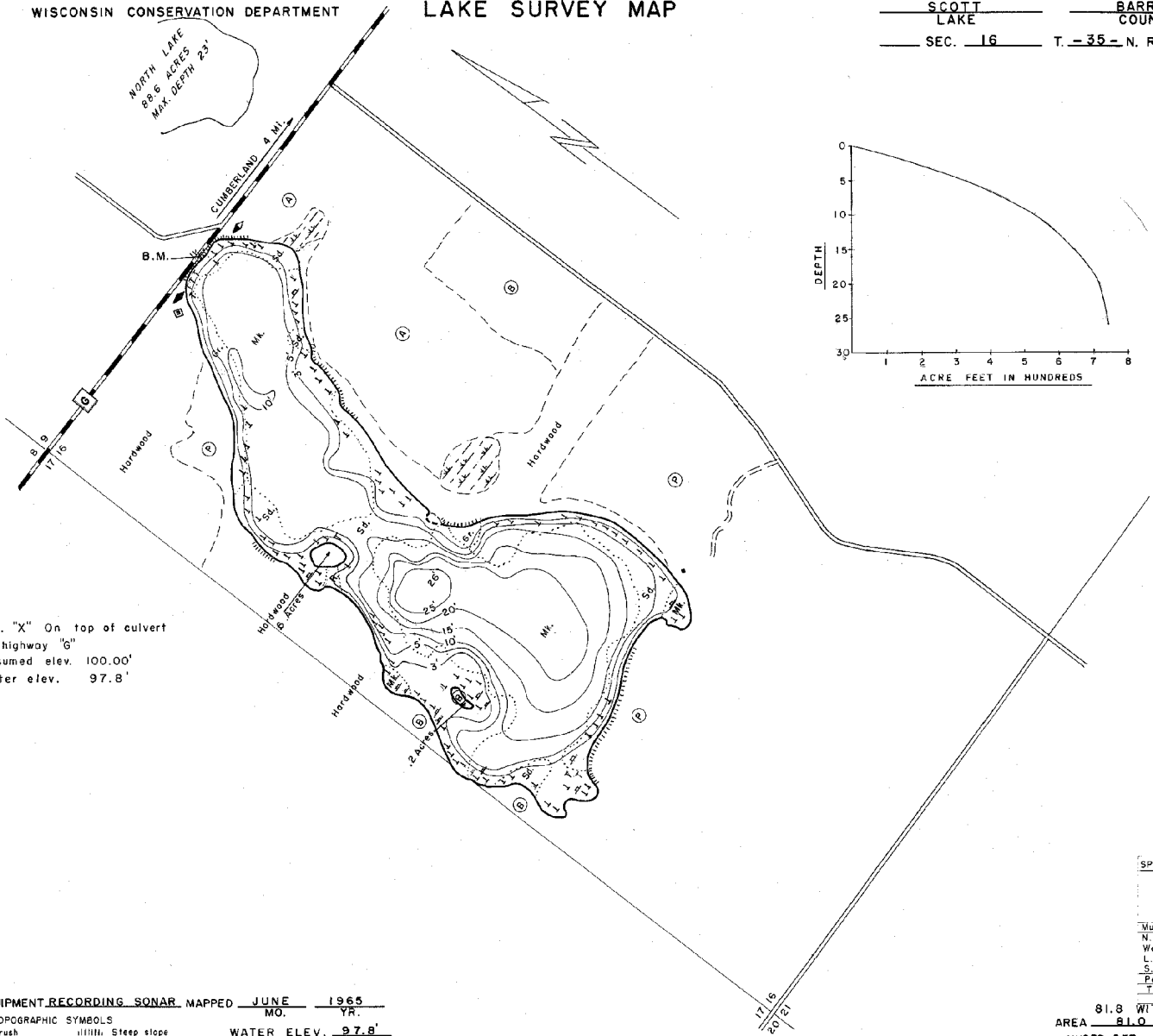

B.M. "X" On top of culvert on highway "G"
 Assumed elev. 100.00'
 Water elev. 97.8'

EQUIPMENT RECORDING SONAR MAPPED JUNE 1965
 MO. YR.

- TOPOGRAPHIC SYMBOLS
- (B) Brush
 - (PW) Partly wooded
 - (W) Wooded
 - (C) Cleared
 - (P) Pastured
 - (A) Agricultural
 - B.M. Bench Mark
 - Dwelling
 - Resort
- WATER ELEV. 97.8'
- LAKE BOTTOM SYMBOLS
- P, Peat
 - Gr. Gravel
 - Mk. Muck
 - R. Rubble
 - C. Clay
 - Br. Bedrock
 - M. Marl
 - T. Submergent vegetation
 - Sd. Sand
 - ↓ Emergent vegetation
 - St. Silt
 - △ Floating vegetation
- TOPOGRAPHIC SYMBOLS (continued):
- Steep slope
 - Indefinite shoreline
 - Marsh
 - Spring
 - Intermittent stream
 - Permanent inlet
 - Permanent outlet
 - Dam

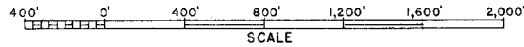

◇ Access ◀ Access with Parking ◆ Boat Livery
 Field work by G. Miller, M. Perkins, L. Saiter Drawn by: F. Eaton

SPECIES OF FISH		Abundant	Common	Rare
Muskie				
N. Pike	X			
Walleye		X		
L.M. Bass			X	
S.M. Bass				X
Fanfish	X			
Trout				

81.8 WITH ISLANDS
 AREA 81.0 ACRES
 UNDER 3 FT. 22 %
 OVER 20 FT. 11 %
 VOLUME 739.1 ACRE FT.
 TOTAL ALK. 9 P.P.M
 SHORELINE 2.1 MILES
 MAX. DEPTH 26 FEET

Maps are not for navigation
 Source-Wisconsin Department of Natural Resources
 Hunt Fish Camp Wisconsin .Com 2005