

STATE OF WISCONSIN
DEPARTMENT OF NATURAL RESOURCES

LAKE SURVEY MAP

SAUNTRY'S POCKET
LAKE

DOUGLAS
COUNTY

TOWN OF WASCOTT

SEC. 12

T. 43

N. R. 11

W.

TOWN
OF
WASCOTT

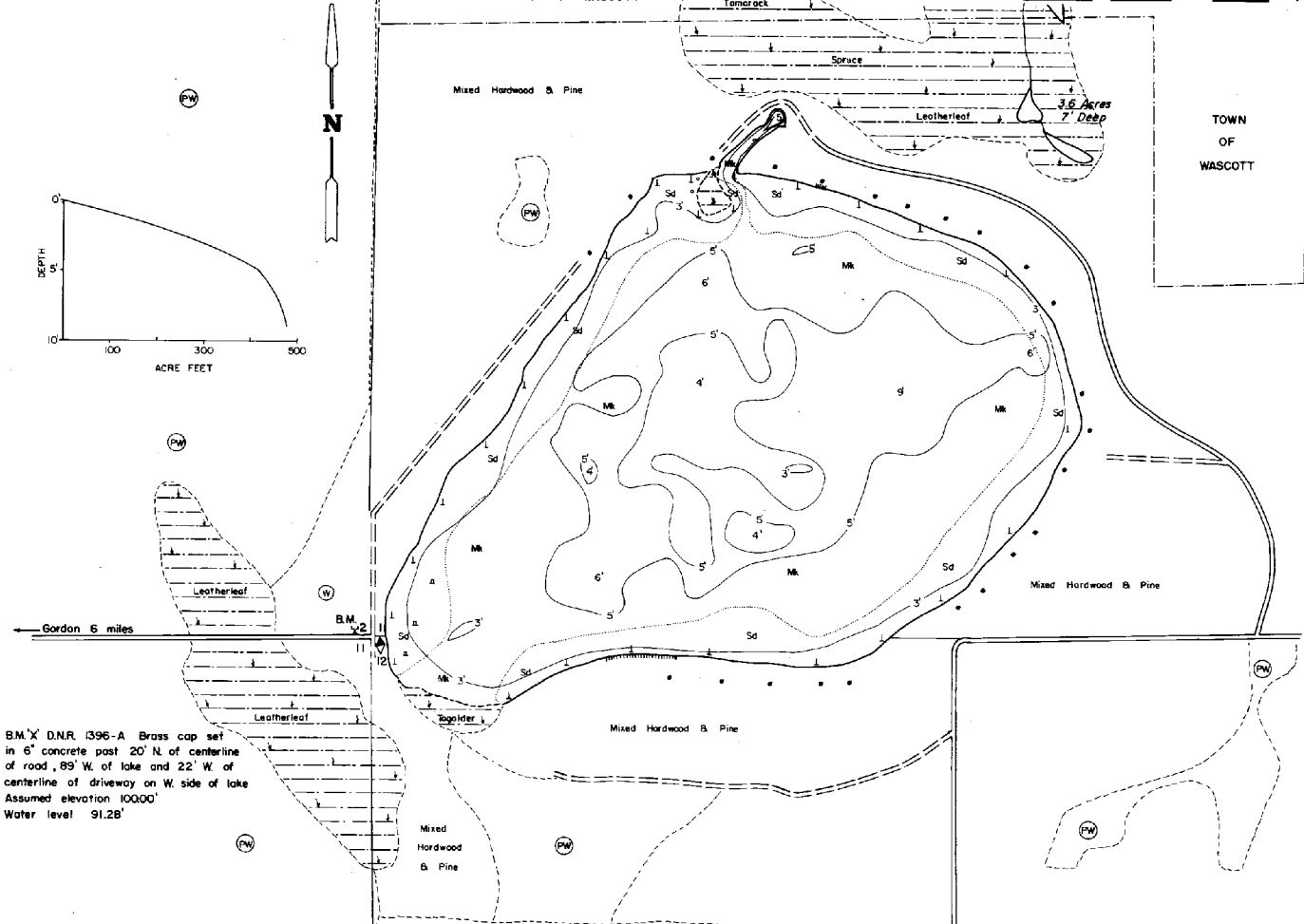
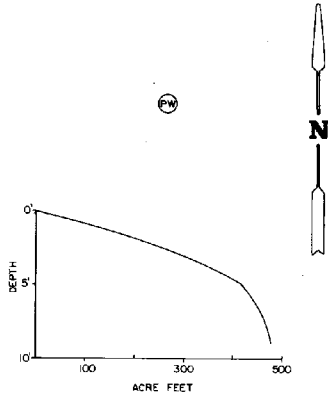

B.M. X D.N.R. 1396-A Brass cap set
in 6" concrete post 20' N. of centerline
of road, 89' W. of lake and 22' W. of
centerline of driveway on W. side of lake
Assumed elevation 100.00'
Water level 91.28'

EQUIPMENT RECORDING SONAR MAPPED JUNE 1972

- TOPOGRAPHIC SYMBOLS**
- (B) Brush
 - (PW) Partially wooded
 - (W) Wooded
 - (C) Cleared
 - (P) Pastured
 - (A) Agricultural
 - B.M. Bench Mark
 - (D) Dwelling
 - (R) Resort
 - (C) Camp
- LAKE BOTTOM SYMBOLS**
- P. Peat
 - Mk. Muck
 - C. Clay
 - M. Marl
 - Sd. Sand
 - Sl. Silt
 - Gr. Gravel
 - R. Rubble
 - Bc. Bedrock

- NORTH YEAR 1972**
- LAKE BOTTOM SYMBOLS**
- B Boulders
 - S Stumps & Snags
 - RD Rock danger to navigation
 - T Submergent vegetation
 - E Emergent vegetation
 - F Floating vegetation
 - BS Brush shelters

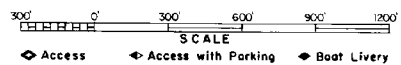

Access Access with Parking Boat Livery
Drawn by: C. Holt
Field work by: C. Busch, G. Lud, I. Sather

SPECIES OF FISH	
Abundant	Scarcity
Muskie	
N. Pike	X
Walleye	X
S. M. Bass	X
Panfish	X
Trout	

WATER AREA 109.8 ACRES
UNDER 3 FT. 18 %
OVER 20 FT. 0 %
MAX. DEPTH 9 FEET.
TOTAL ALK. 18 P.P.M.
VOLUME 480 ACRE FT.
SHORELINE 1.63 MILES

Maps are not for navigation
Source-Wisconsin Department of Natural Resources
Hunt Fish Camp Wisconsin .Com 2005