

Hunt Fish Camp Wisconsin

STATE OF WISCONSIN
DEPARTMENT OF NATURAL RESOURCES

LAKE SURVEY MAP

SAND LAKE BURNETT COUNTY
SEC. 23, 24, 25, 26, 35, 36 T. 40 N. R. 15 W.
SHEET 2 OF 2

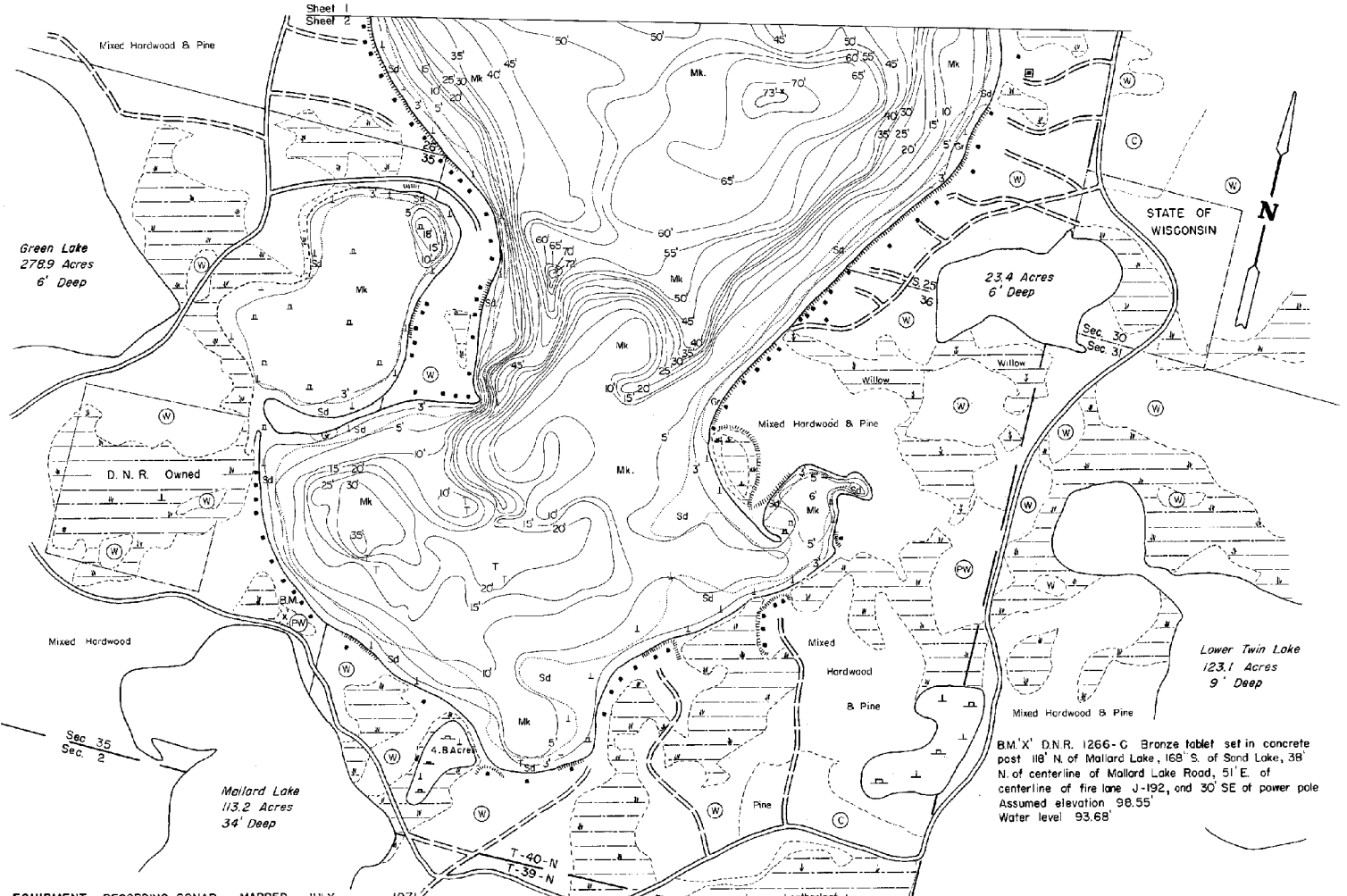

B.M. X' D.N.R. 1266-G Bronze tablet set in concrete post 116' N. of Mallard Lake, 168' S. of Sand Lake, 38' N. of centerline of Mallard Lake Road, 51' E. of centerline of fire lane J-192, and 30' SE of power pole Assumed elevation 98.55' Water level 93.68'

EQUIPMENT	RECORDING	SONAR	MAPPED	JULY	1971
			MONTH	YEAR	
			LAKE	BOTTOM	
(B) Brush	Sleep slope	P. Peat		B. Boulders	
(PW) Partially wooded	- - - Indefinite shoreline	Mk. Muck		⊙ Stumps & Snags	
(W) Wooded	⊙ Marsh	C. Clay		⊙ Rock danger to navigation	
(C) Cleared	⊙ Spring	M. Marl		T Submergent vegetation	
(P) Pastured	- - - Intermittent stream	Sd. Sand		⊙ Emergent vegetation	
(A) Agricultural	⊙ Permanent inlet	Sl. Silt		⊙ Floating vegetation	
B.M. Bench Mark	⊙ Permanent outlet	Gr. Gravel		⊙ Brush shelters	
■ Dwelling	⊙ Dam	R. Rubble			
■ Resort	⊙ D.N.R. State owned land	Bc. Bedrock			
■ Camp					

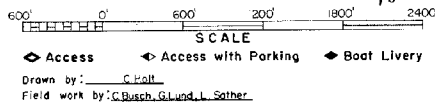

SPECIES OF FISH	ABUNDANCE		
	Abundant	Common	Scattered
Muskie			
N. Pike	X		
Walleye	X		
L. M. Bass	X		
S. M. Bass	X		
Panfish	X		
Trout			

WATER AREA	961.5	ACRES
UNDER 3 FT.	7	%
OVER 20 FT.	48	%
MAX. DEPTH	73	FEET.
TOTAL ALK.	42	P.P.M.
VOLUME	22,993	ACRE FT.
SHORELINE	8.30	MILES

Maps are not for navigation
Source-Wisconsin Department of Natural Resources
Hunt Fish Camp Wisconsin .Com 2005