

STATE OF WISCONSIN
DEPARTMENT OF NATURAL RESOURCES

LAKE SURVEY MAP

ROUND LAKE PRICE COUNTY
SEC. 26, 25, 23, 24, 14 T. 40 N. R. 3 E.

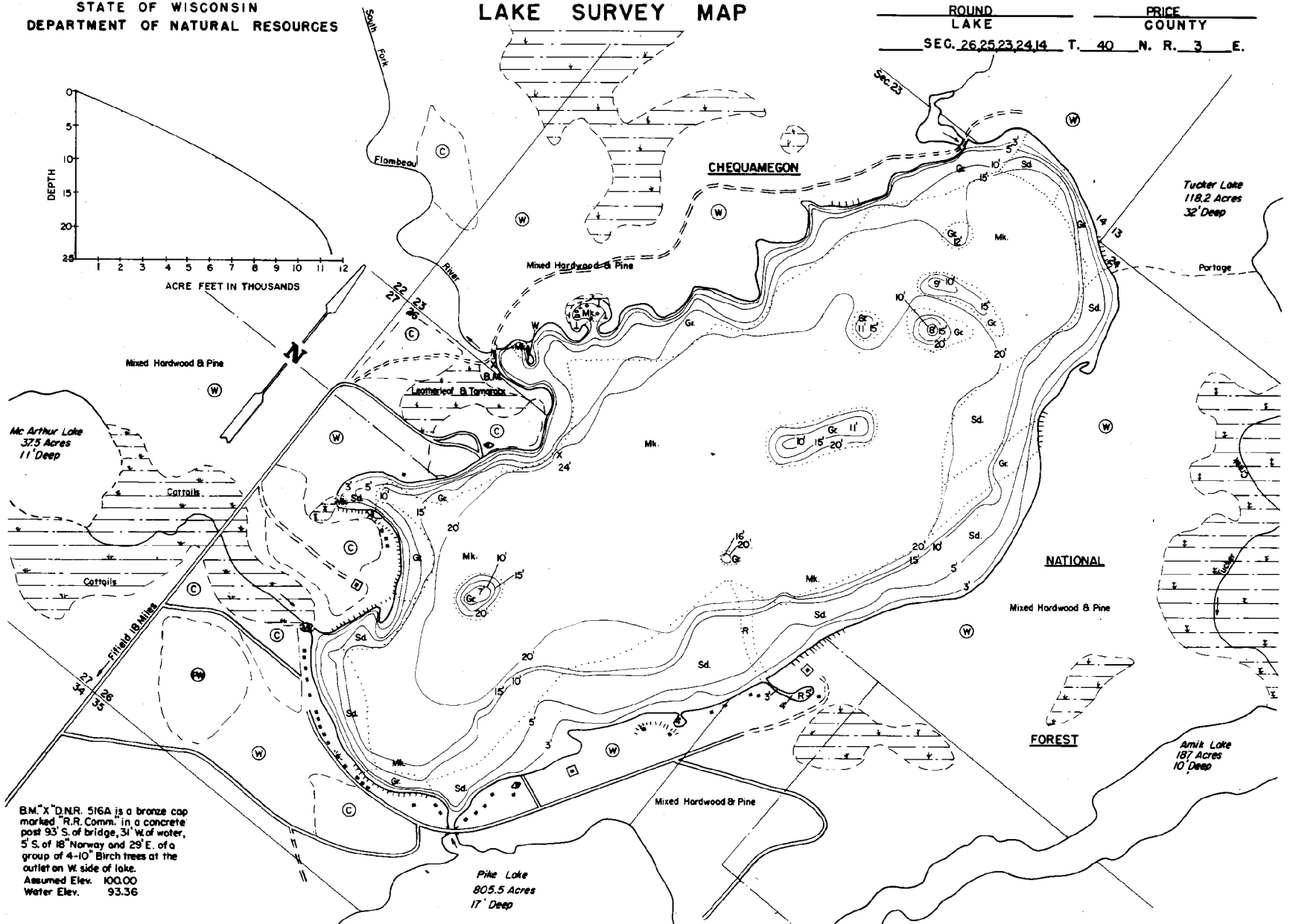

B.M. "X" D.N.R. 516A is a bronze cap marked "R.R. Comm. in a concrete post 93' S. of bridge, 31' W. of water, 5' S. of 18" Norway and 29' E. of a group of 4-10" Birch trees at the outlet on W. side of lake. Assumed Elev. 100.00 Water Elev. 93.36

EQUIPMENT RECORDING SONAR MAPPED SEPTEMBER 1972
LAKE BOTTOM YEAR

- | TOPOGRAPHIC SYMBOLS | | LAKE BOTTOM SYMBOLS | |
|----------------------|-------------------------------|---------------------|-----------------------------|
| (B) Brush | Steep slope | P. Peat | B Boulders |
| (W) Partially wooded | ----- Indefinite shoreline | Mk. Muck | ⚡ Stumps & Snags |
| (C) Cleared | ----- Marsh | C. Clay | ⚡ Rock danger to navigation |
| (S) Spring | ----- Spring | M. Marl | T Submergent vegetation |
| (P) Pastured | ----- Intermittent stream | Sd. Sand | 1 Emergent vegetation |
| (A) Agricultural | ----- Permanent inlet | St. Silt | ⚡ Floating vegetation |
| B.M. Bench Mark | ----- Permanent outlet | Gr. Gravel | ⚡ Brush shelters |
| ■ Dwelling | ----- Dam | R. Rubble | |
| ■ Resort | ----- D.N.R. State owned land | Bc Bedrock | |



Drawn by: J. Kuehn
Field work by: C. Bush, B. G. and P. Sutter

SPECIES OF FISH	ABUNDANCE	
	Abundant	Common Present
Muskie	X	X
N. Pike	X	X
Walleye	X	X
L.M. Bass	X	X
S.M. Bass	X	X
Panfish	X	X
Trout		

WATER AREA 725.6 ACRES
UNDER 3 FT. 6 %
OVER 20 FT. 43 %
MAX. DEPTH 24 FEET
TOTAL ALK. 21 P.P.M.
VOLUME 11528.2 ACRE FT.
SHORELINE 508 MILES