

WISCONSIN CONSERVATION DEPARTMENT

LAKE SURVEY MAP

ROUND LAKE ONEIDA COUNTY
 SEC. 29 T. 39 N. R. 11 E.

PLANTING GROUND LAKE
 1011.7 ACRES
 37' DEEP

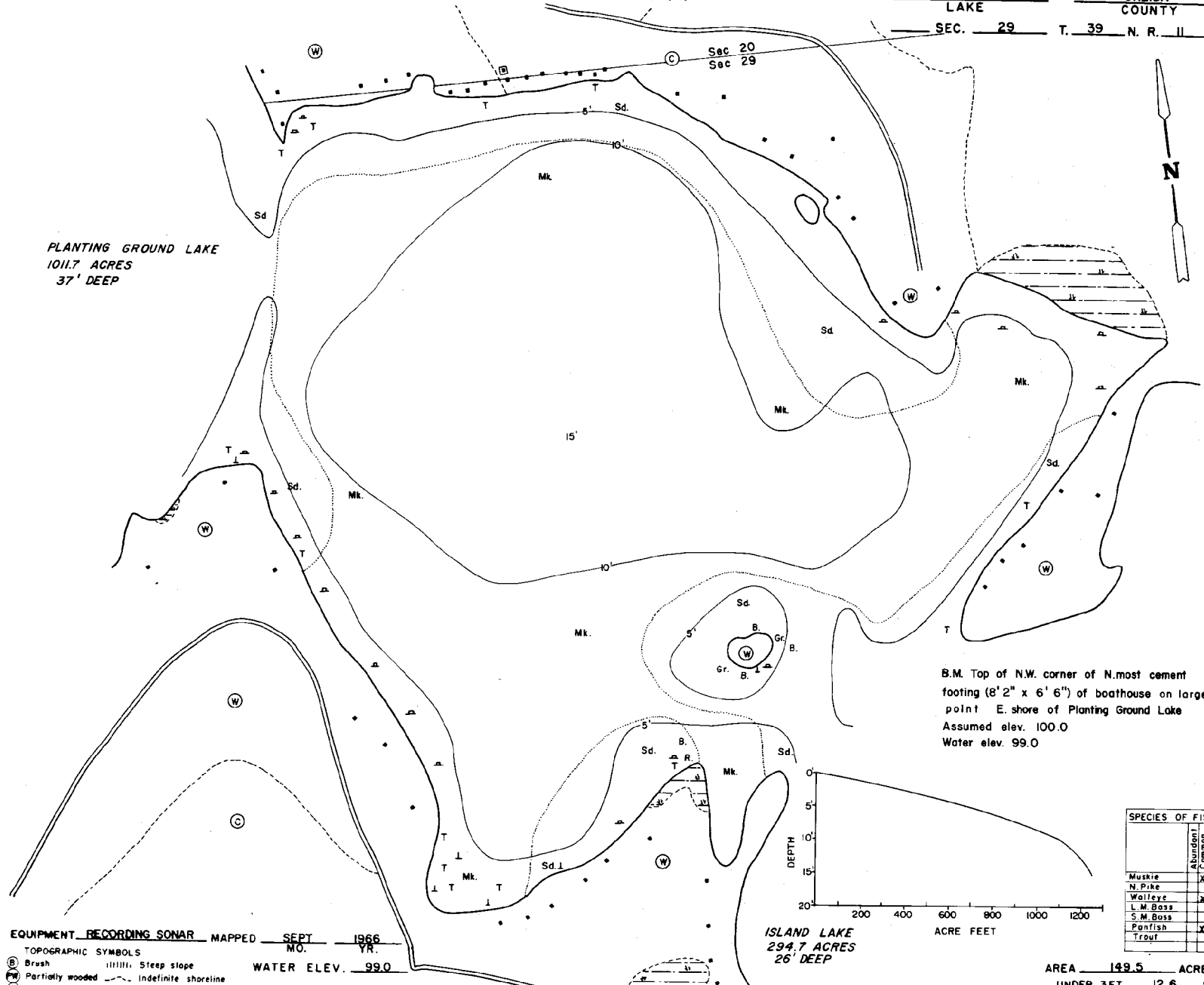

B.M. Top of N.W. corner of N. most cement footing (8' 2" x 6") of boathouse on large point E. shore of Planting Ground Lake
 Assumed elev. 100.0
 Water elev. 99.0

ISLAND LAKE
 294.7 ACRES
 26' DEEP

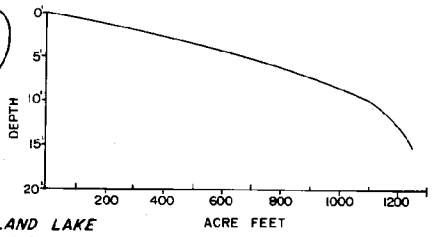

EQUIPMENT RECORDING SONAR MAPPED SEPT 1966
 MO. YR.

TOPOGRAPHIC SYMBOLS
 (B) Brush
 (W) Partly wooded
 (C) Cleared
 (P) Pastured
 (A) Agricultural
 B.M. Bench Mark
 (•) Dwelling

TOPOGRAPHIC SYMBOLS
 (|||||) Steep slope
 (---) Indefinite shoreline
 (---) Marsh
 (o) Spring
 (---) Intermittent stream
 (---) Permanent inlet
 (---) Permanent outlet
 (---) Dam

WATER ELEV. 99.0
 LAKE BOTTOM SYMBOLS
 P. Peat Gr. Gravel Stumps & Snags
 MK. Muck R. Rubble B. Boulders
 C. Clay Br. Bedrock
 M. Marl T. Submergent vegetation
 Sd. Sand I. Emersept vegetation

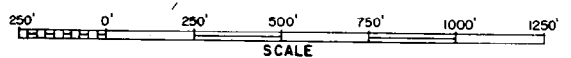

SPECIES OF FISH	Abundance	
	Common	Rare
Muskie	X	
N. Pike	X	
Walleye	X	
L.M. Bass	X	
S.M. Bass	X	
Punfish	X	
Trout		

AREA 149.5 ACRES
 UNDER 3FT. 12.6 %
 OVER 20FT. 0 %
 VOLUME 1250.5 ACRE FT.
 TOTAL ALK. 29 P.P.M.
 SHORELINE 2.2 MILES

Access Access with Boathouse Boat Lanes