

STATE OF WISCONSIN  
DEPARTMENT OF NATURAL RESOURCES

LAKE SURVEY MAP

ROCKY RIDGE LAKE  
WASHBURN COUNTY  
SEC. 5.8 T. 39 N. R. 13 W.

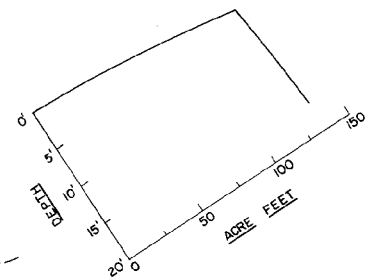
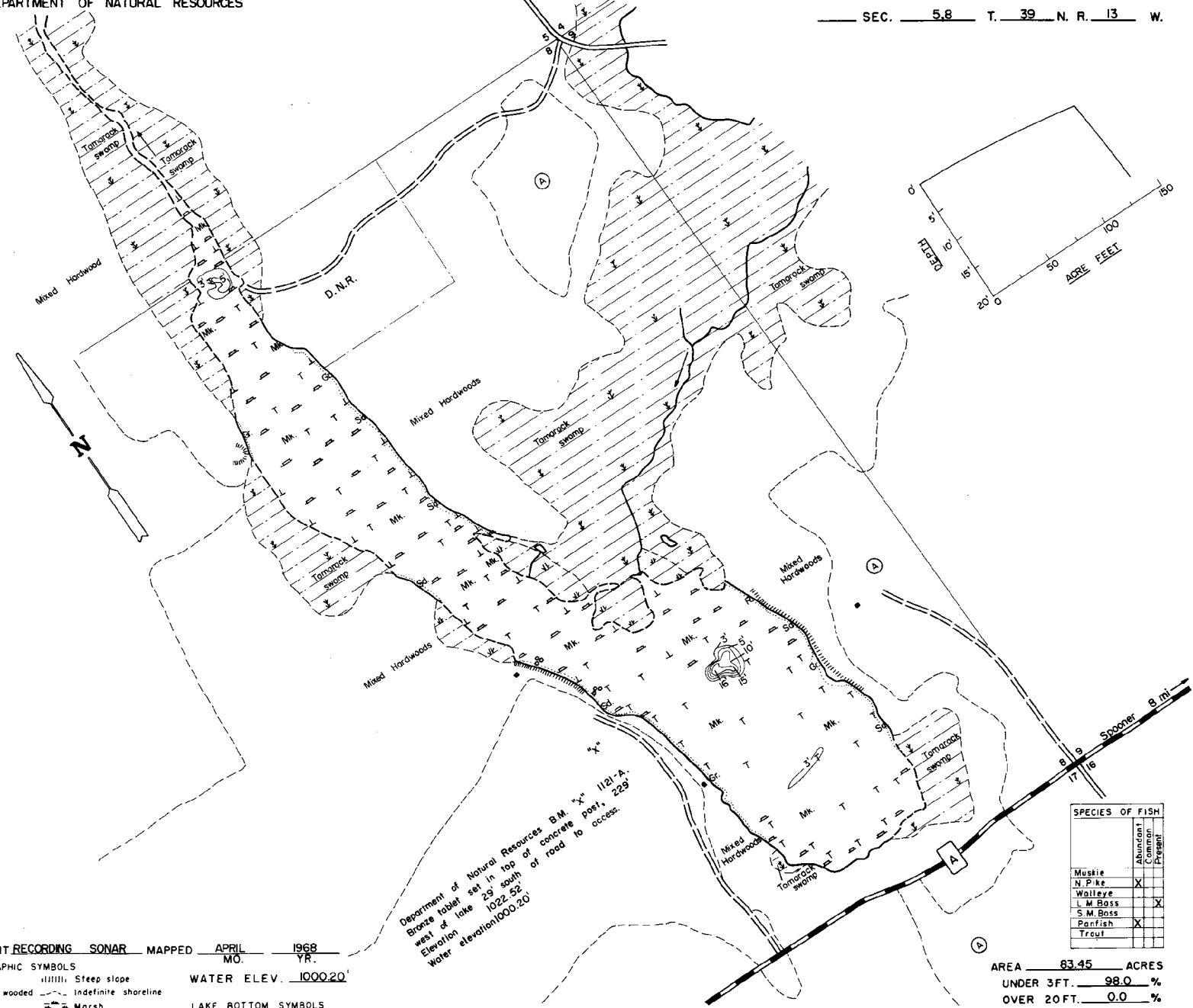

Department of Natural Resources B.M. "X" 1121-A.  
Bronze tower set in top of concrete post, 229'  
west of lake  
Elevation 1022.52'  
Water elevation 1000.20'

EQUIPMENT RECORDING SONAR MAPPED APRIL 1968  
MO. YR.

- TOPOGRAPHIC SYMBOLS
- (B) Brush
  - (P) Partially wooded
  - (W) Wooded
  - (C) Cleared
  - (P) Pastured
  - (A) Agricultural
  - B.M. Berch Mark
  - (D) Dwelling
  - (R) Resort

- LAKE BOTTOM SYMBOLS
- P. Peat
  - Mk. Muck
  - C. Clay
  - M. Marl
  - Sd. Sand
  - St. Silt
  - Gr. Gravel
  - R. Rubble
  - Br. Bedrock
  - Submergent vegetation
  - Emergent vegetation
  - Floating vegetation
  - Stumps & Snags

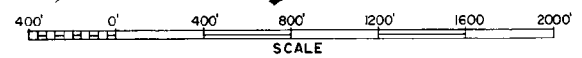

◇ Access      ◀ Access with Parking      ◆ Boat Livery  
Field work by C. Busch, C. Olson, L. Sather      Drawn by: R. Ripp

SPECIES OF FISH	ABUNDANCE	
	Common	Present
Muskie		
N. Pike	X	
Walleye		
L. M. Bass		X
S. M. Bass		
Parfish	X	
Trout		

AREA 83.45 ACRES  
UNDER 3FT. 98.0 %  
OVER 20FT. 0.0 %  
VOLUME 133.23 ACRE FT.  
TOTAL ALK. 79 P.P.M.  
SHORELINE 2.45 MILES  
MAX. DEPTH 16 FEET