

WISCONSIN CONSERVATION DEPARTMENT

LAKE SURVEY MAP

ROCK LAKE  
 KENOSHA COUNTY  
 SEC. 34 T. 1 N. R. 20 E.

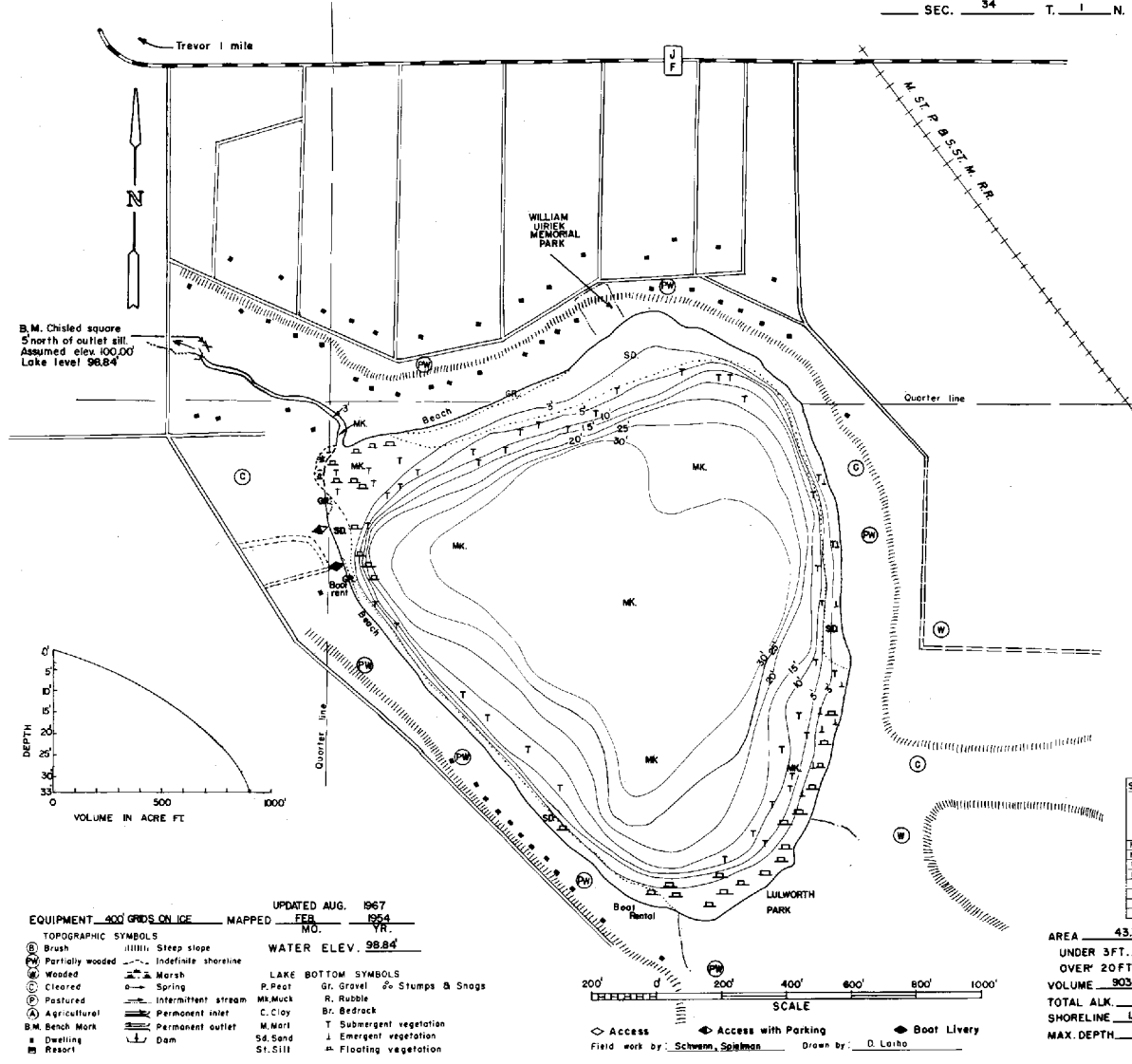

SPECIES OF FISH	
	ABUNDANT Common Rare
Muskie	
N Pike	X
Walleye	
L.M. Bass	X
S.M. Bass	X
Frogbit	X
Trout	X

AREA 43.71 ACRES  
 UNDER 3 FT. 11 %  
 OVER 20 FT. 41 %  
 VOLUME 903.55 ACRE FT.  
 TOTAL ALK. 158 P.P.M.  
 SHORELINE 12.4 MILES  
 MAX. DEPTH 33 FEET

EQUIPMENT 300 GRIDS ON ICE MAPPED FEB 1954  
 UPDATED AUG. 1967  
 WATER ELEV. 98.84'  
 TOPOGRAPHIC SYMBOLS  
 (B) Brush (|||||) Steep slope  
 (PW) Partially wooded Indefinite shoreline  
 (W) Wooded Marsh  
 (C) Cleared Spring  
 (P) Pastured Intermittent stream  
 (A) Agricultural Permanent inlet  
 B.M. Bench Mark Permanent outlet  
 (D) Dwelling Dam  
 (R) Resort  
 LAKE BOTTOM SYMBOLS  
 P. Peat Gr. Gravel St. Stumps & Snags  
 Mk. Muck R. Rubble B. Bedrock  
 C. Clay T. Submergent vegetation  
 M. Marl E. Emergent vegetation  
 Sd. Sand F. Floating vegetation  
 St. Sill

200' 400' 600' 800' 1000'  
 SCALE  
 Access Access with Parking Boat Livery  
 Field work by: Schwab, Spilman Drawn by: D. Laiba

Maps are not for navigation  
 Source-Wisconsin Department of Natural Resources  
 Hunt Fish Camp Wisconsin .Com 2005