

WISCONSIN CONSERVATION DEPARTMENT

LAKE SURVEY MAP

LAKE RED CEDAR
 SECTIONS 2,3,10,11,15,22,27
 TOWNSHIP T-36-N
 RANGE R-10-W
 TOWN CEDAR LAKE
 COUNTY BARRON

(Sheet 1 of 2)

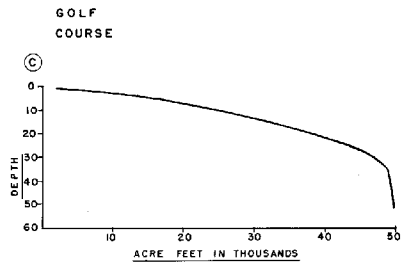
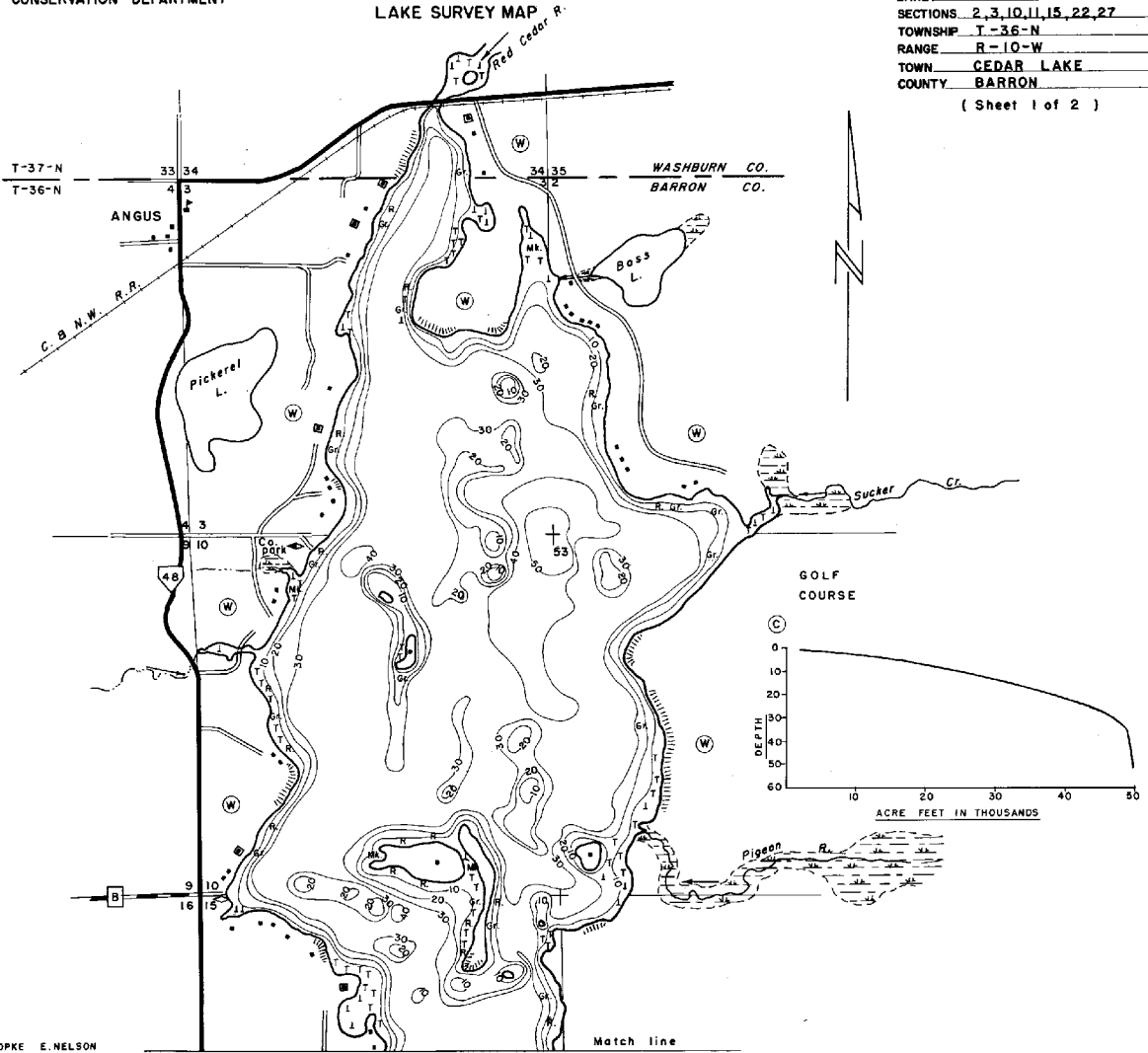

FIELD WORK BY: R.HOPKE E.NELSON
 DRAWN BY: E.EATON
 LAKE MAPPED OCTOBER 1964
 SOURCE OF INFORMATION W.C.D.
 SOUNDINGS RECORDING SONAR
 TOTAL ALK. 6.6 P.P.M.

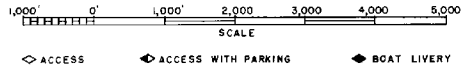

AREA 1,841 ACRES
 TOTAL SHORELINE 15.9 MILES
 MAX. DEPTH 53 FEET
 SCALE: AS SHOWN

Maps are not for navigation
 Source-Wisconsin Department of Natural Resources
 Hunt Fish Camp Wisconsin .Com 2005