

STATE OF WISCONSIN
DEPARTMENT OF NATURAL RESOURCES

LAKE SURVEY MAP

POPPLE LAKE
CHIPPEWA COUNTY
SEG. 24, 25 T. 30 N. R. 8 W.

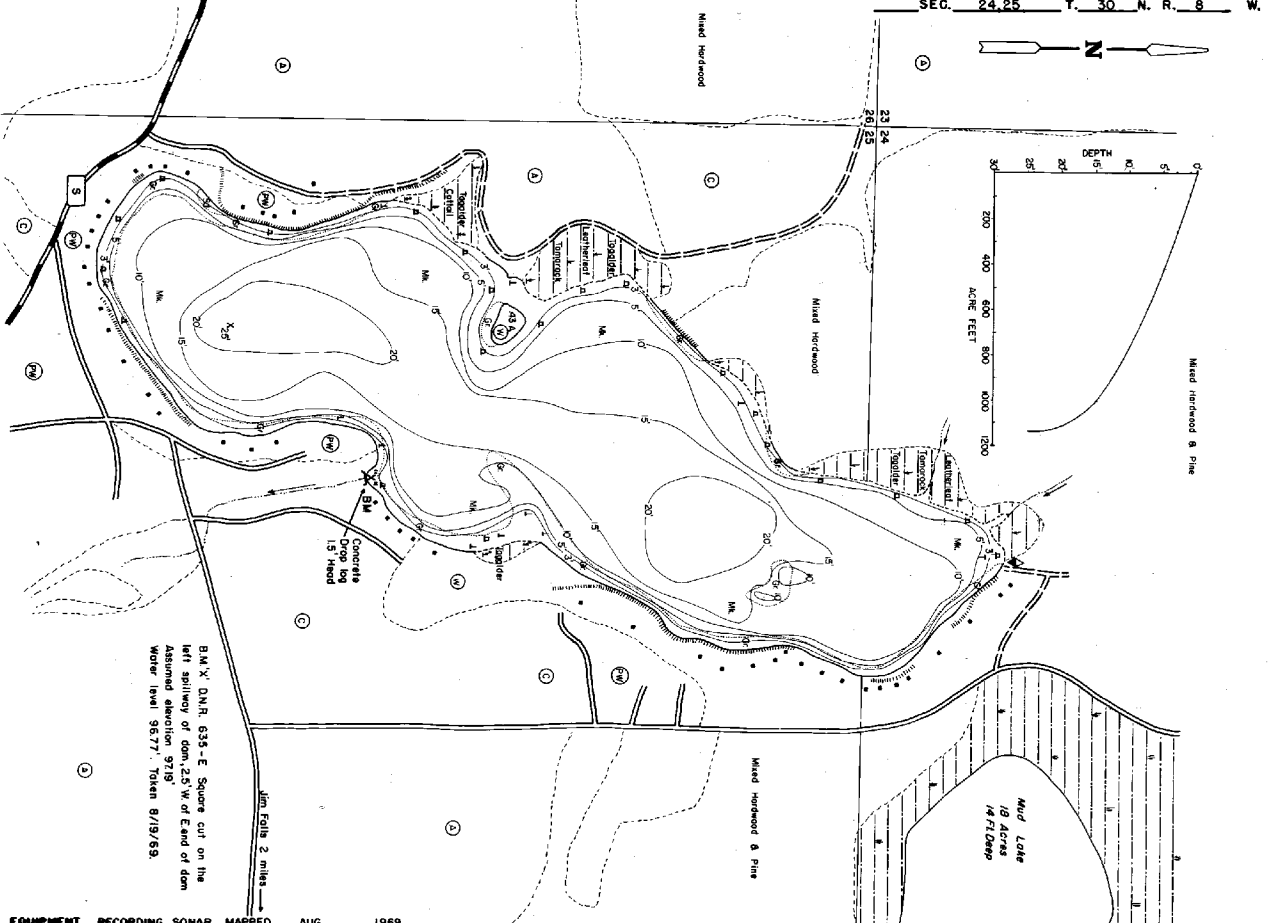

EQUIPMENT	RECORDING SONAR	MAPPED	MUS	1969
		MONTH	YEAR	
Topographic Symbols				
Brush	5 steep slope	P. Peat	B Boulders	
Partially wooded	Underwater shoreline	Mk. Muck	⚡ Stumps & Snags	
Wooded	Shoal	C. Clay	⚠ Rock danger to navigation	
Clearwood	Spring	M. Marl	T Subergent vegetation	
Publicland	Intermittent stream	Sd. Sand	L Emergent vegetation	
Agricultural	Perennial inlet	Sl. Silt	⚓ Floating vegetation	
B.M. Bench Mark	Perennial outlet	Gr. Gravel	⚡ Brush shelters	
Dredging	Dam	R. Rubble		
Reclaim	D.R.R. Shore owned land	Bk. Bedrock		
Culvert				

300' 600' 900' 1200'
SCALE
Access Access with Parking Boat Livery
Drawn by: C.Hall
Field work by: C.Busch, C.Beller, S.Johnson.

SPECIES OF FISH	1969	1970	1971	1972	1973	1974	1975	1976	1977	1978	1979	1980
Muskie												
N. Pike												
Walleye												
L. W. Bass												
S. W. Bass												
Panfish												
Trout												

WATER AREA 900 ACRES
UNDER 3 FT. 9 %
OVER 20 FT. 10 %
MAX. DEPTH 25 FEET.
TOTAL ALK. 54 P.P.M.
VOLUME 1399 ACRE FT.
SHORELINE 1.97 MILES
SHORELINE 2.06 MILES WITH IS.

Maps are not for navigation
Source-Wisconsin Department of Natural Resources
Hunt Fish Camp Wisconsin .Com 2005