

STATE OF WISCONSIN
DEPARTMENT OF NATURAL RESOURCES

LAKE SURVEY MAP

PARTRIDGE LAKE
VILAS COUNTY
SEC. 28, 32, 33 T. 42 N. R. 8 E. 34



NORTHERN

HIGHLAND

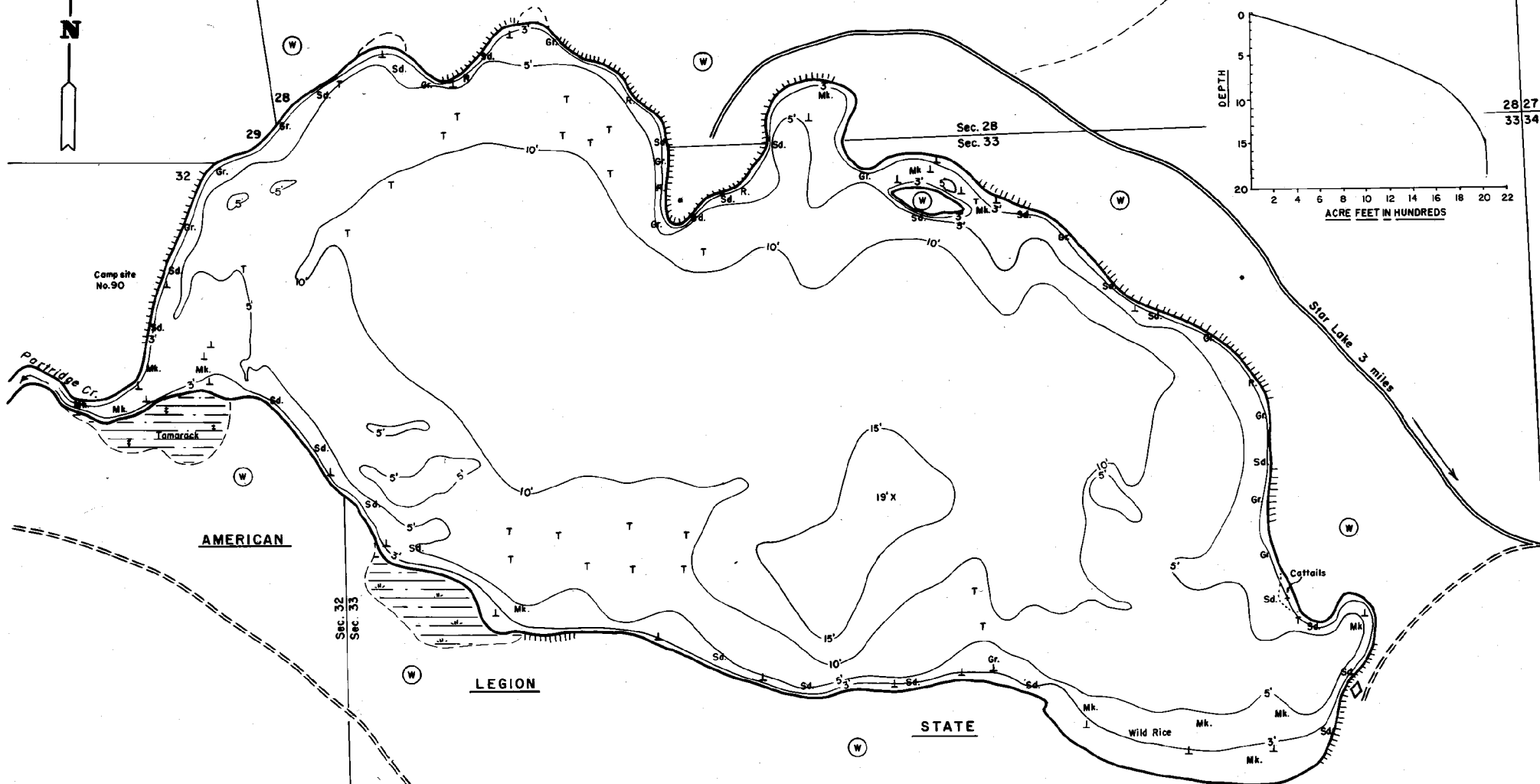
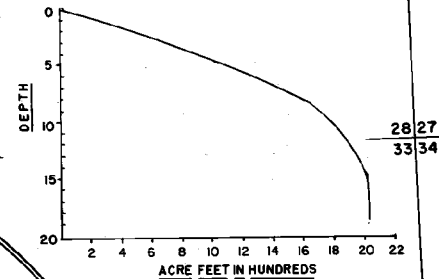

T.B.M. "X" is a square nail in a 12" spruce
just north of boat landing.
Assumed elevation = 100.00'
Water level = 97.13'

EQUIPMENT RECORDING SONAR MAPPED JUNE 1977

- | TOPOGRAPHIC SYMBOLS | | LAKE BOTTOM SYMBOLS | |
|---------------------|-----------------------|---------------------|-----------------------------|
| ⊙ Brook | ⊘ Steep slope | P. Peat | B Boulders |
| ⊙ Partially wooded | ⊘ Substrate shoreline | M. Muck | ⊘ Stumps & Snags |
| ⊙ Wooded | ⊘ Marsh | C. Clay | ⊘ Rock danger to navigation |
| ⊙ Cleared | ⊘ Spring | M. Marl | T Submergent vegetation |
| ⊙ Pastured | ⊘ Intermittent stream | Sd. Sand | ⊘ Floating vegetation |
| ⊙ Agricultural | ⊘ Permanent inlet | Sl. Silt | ⊘ Floating vegetation |
| ⊙ Orchard | ⊘ Permanent outlet | Gr. Gravel | ⊘ Brush shelters |
| ⊙ Orchard | ⊘ Dam | R. Rubble | |

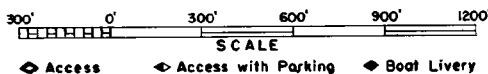

SPECIES OF FISH	Abundance	
	Common	Present
Muskie	X	X
N. Pike	X	X
Walleye	X	X
L. M. Bass	X	X
S. M. Bass	X	X
Panfish	X	X

WATER AREA 233.82 ACRES
UNDER 3 FT. 5 %
OVER 20 FT. 0 %
MAX. DEPTH 19 FEET.
TOTAL ALK. 48 P.P.M.
VOLUME 2,118.81 ACRE FT.
MAIN SHORELINE 2.9 MI.