

LAKE SURVEY MAP

LAKE ONE MILE
 SECTION 1-12
 TOWNSHIP 43 N
 RANGE 12 W
 TOWN OF GORDON, WASCOTT
 COUNTY DOUGLAS

FORM FI-117

WISCONSIN CONSERVATION DEPARTMENT
 BIOLOGY DIVISION
 LAKE AND STREAM IMPROVEMENT SECTION

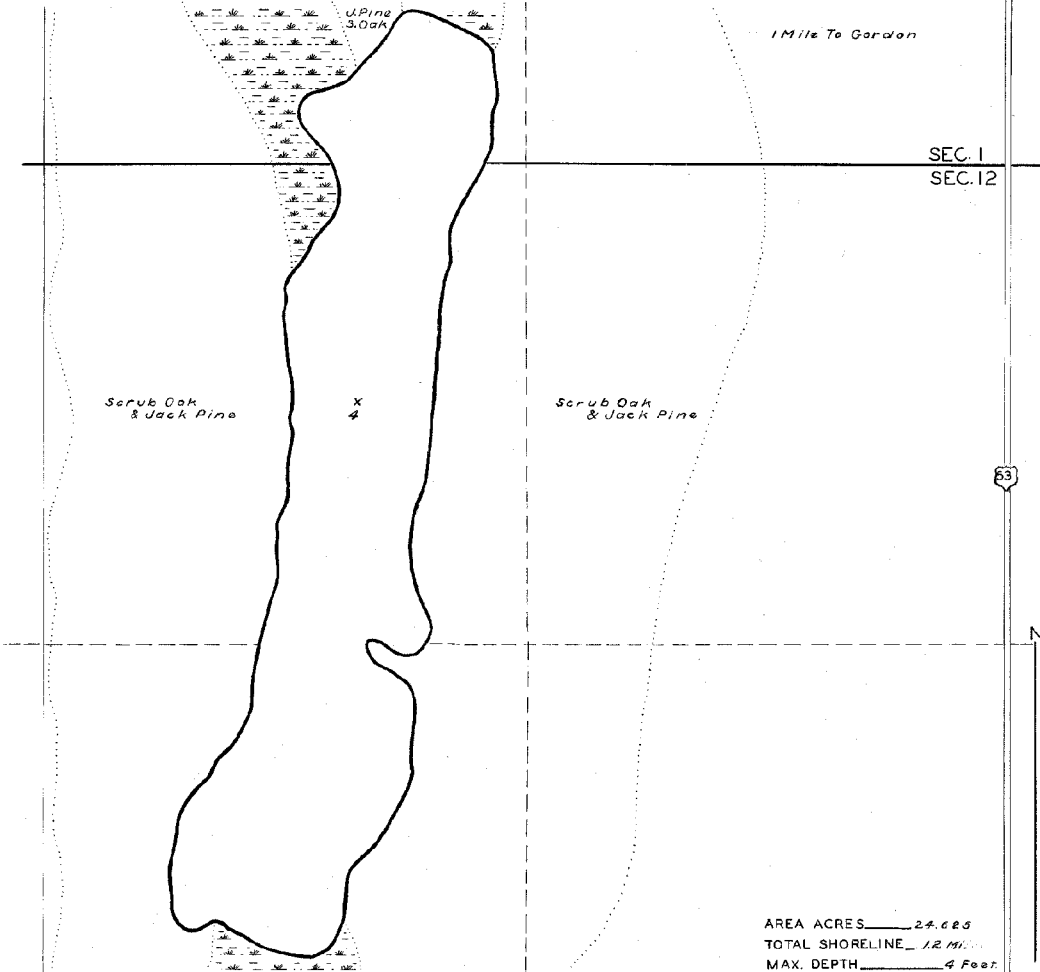

AREA ACRES 24.625
 TOTAL SHORELINE 1.2 Miles
 MAX. DEPTH 4 Feet

SCALE 1 inch Equals 220 Feet

DATE Aug 13 1941
 COMPILED BY _____
 TRACED BY WLM (WPA)
 SOURCE OF INFORMATION WPA Lake Survey Project

 SOUNDING At 16.5 Foot Intervals

 DATES OF MAP REVISION _____

 WORK AGENCY W.P.A.

LAKE IMPROVEMENT RECORD

TYPE	DATE	DATE	DATE	DATE
⊕ BRUSH REFUGES	_____	_____	_____	_____
~ SAPLING TANGLES	_____	_____	_____	_____
□ SPAWNING BOXES	_____	_____	_____	_____
* MINNOW SPAWERS	_____	_____	_____	_____
TOTAL	_____	_____	_____	_____

LEGEND

⊕	WEED BEDS
⊕	ROCKY SHOALS
⊕	SAND
⊕	CLAY
⊕	GRAVEL
MA	MUCK
■	DWELLING
□	ABANDONED DWELLING

Checked
 W.P.S.
 E.M.K.
 7/2/41