

WISCONSIN CONSERVATION DEPARTMENT

LAKE SURVEY MAP

NESHONOG LAKE LACROSSE COUNTY
 SEC. 26, 27, 33, 36, 35, 34 T. 17 N. R. 5, 6 E.W.

BM "X" - Top of concrete walk on dam at south end.
 Assumed elev. 100'
 Water elev. 91.3'

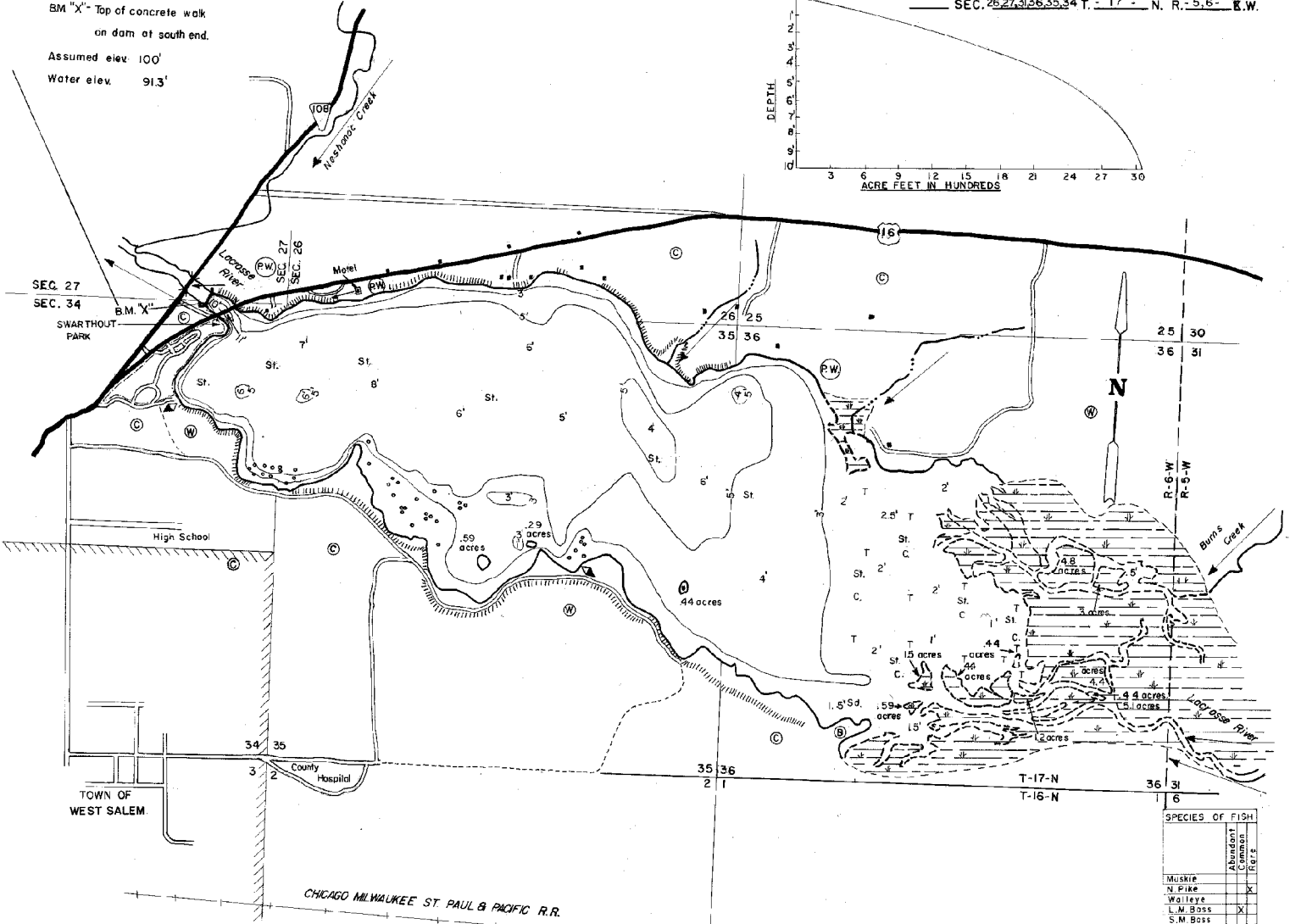
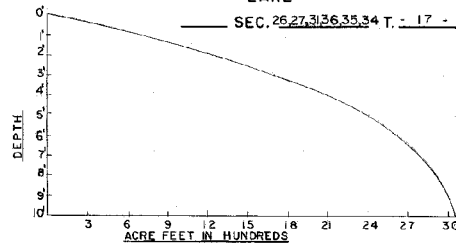

SPECIES OF FISH		
	Abundant	Common
Muskie		
N. Pike		X
Walleye		X
S.M. Bass		X
Panfish	X	
Trout		

RECORDING ECHO SOUNDER
 EQUIPMENT AND POLE SOUNDINGS - MAPPED JUNE 1966
 MO. YR.
 WATER ELEV. 91.3 FT.

- TOPOGRAPHIC SYMBOLS**
- Brush
 - Partially wooded
 - Wooded
 - Cleared
 - Pastured
 - Agricultural
 - B.M. Bench Mark
 - Dwelling
 - Resort
- LAKE BOTTOM SYMBOLS**
- P. Peat
 - Mk. Muck
 - C. Clay
 - M. Morl
 - Sd. Sand
 - St. Silt
 - Gr. Gravel
 - R. Rubble
 - Br. Bedrock
 - T. Submergent vegetation
 - i. Emergent vegetation
 - F. Floating vegetation
 - Stumps & Snags

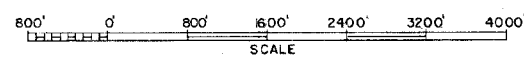

Access Access with Parking Boat Livery
 Field work by: R.C.IAP Drawn by: D. LAIHO

AREA WITHOUT IS.	6872	ACRES
TOTAL AREA	7374	ACRES
UNDER 3 FT.	36.3	%
OVER 20 FT.	0	%
VOLUME	3,104.5	ACRE FT.
TOTAL ALK.	92	P.P.M
SHORELINE	12.3	MILES
MAX. DEPTH	11	FEET

Maps are not for navigation
 Source-Wisconsin Department of Natural Resources
 Hunt Fish Camp Wisconsin .Com 2005