

STATE OF WISCONSIN
DEPARTMENT OF NATURAL RESOURCES

LAKE SURVEY MAP

MUD LAKE WASHINGTON COUNTY
SEC. 24 T. 9 N. R. 19 E.

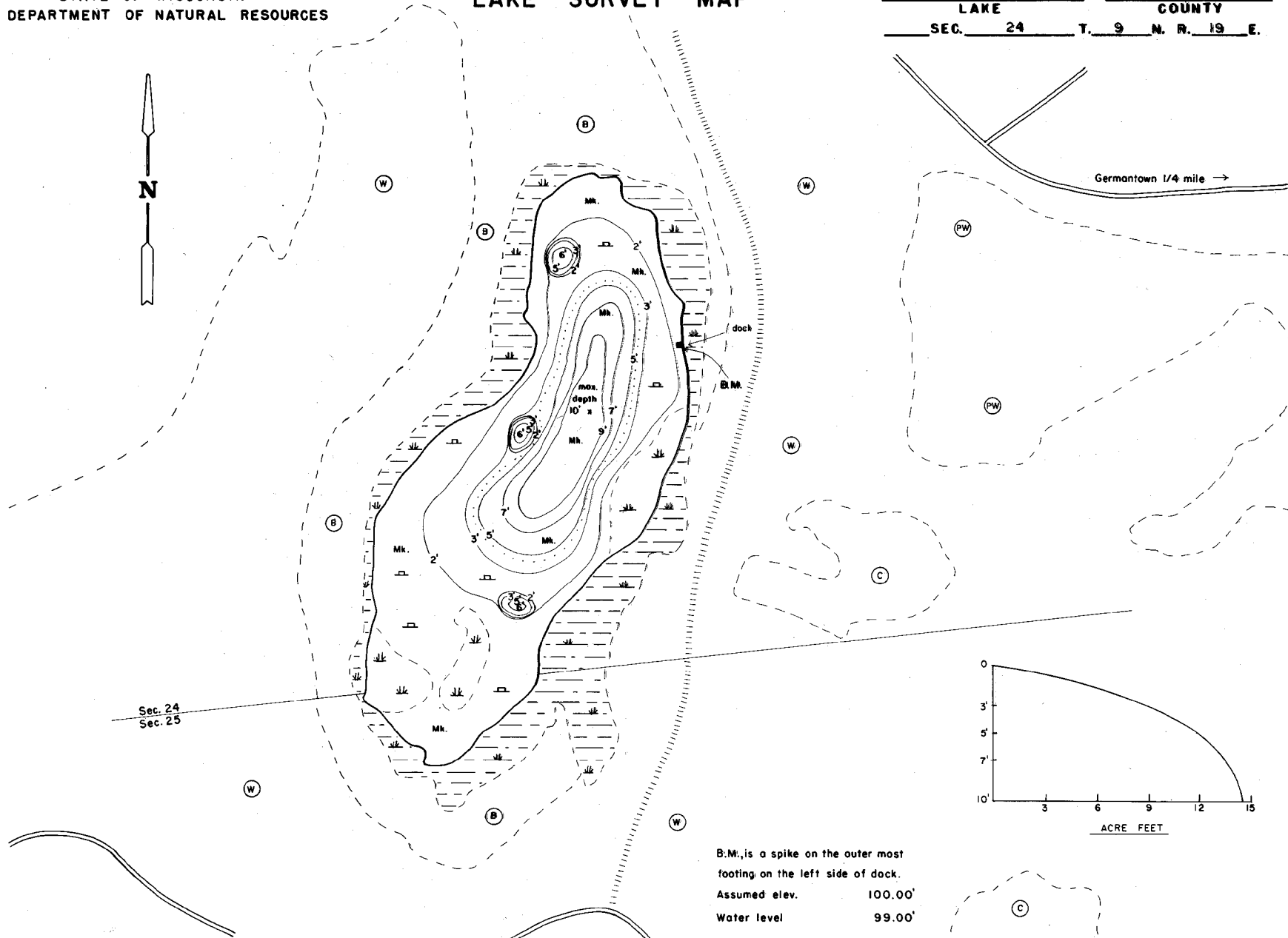

Sec. 24
Sec. 25

Germantown 1/4 mile →

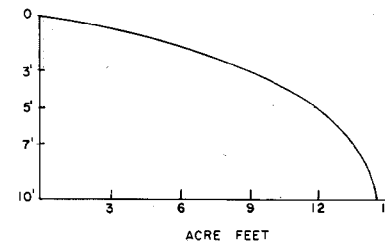

B.M. is a spike on the outer most footing on the left side of dock.
Assumed elev. 100.00'
Water level 99.00'

EQUIPMENT RECORDING SONAR MAPPED JUNE 1970
MONTH YEAR
LAKE BOTTOM SYMBOLS

TOPOGRAPHIC SYMBOLS		LAKE BOTTOM SYMBOLS	
(B) Brush	Steep slope	P. Peat	B Boulders
(PW) Partially wooded	Indefinite shoreline	Mk. Muck	Stumps & Snags
(W) Wooded	Marsh	C. Clay	Rock danger to navigation
(C) Cleared	Spring	M. Marl	T Submergent vegetation
(P) Pastured	Intermittent stream	Sd. Sand	Emergent vegetation
(A) Agricultural	Permanent inlet	St. Silt	Floating vegetation
B.M. Bench Mark	Permanent outlet	Gr. Gravel	Brush shelters
		P. Pebble	



Access Access with Parking Boat Livery

SPECIES OF FISH	Abundance		
	Abundant	Common	Present
Muskie			
N. Pike			
Walleye			
L. M. Bass			
S. M. Bass			
Perch			
Penfish			

WATER AREA 4.95 ACRES
UNDER 3 FT. 71 %
OVER 20 FT. 0 %
MAX. DEPTH 10 FEET.
TOTAL ALK. 7.4 P.P.M.
VOLUME 14.48 ACRE FT.
SHORELINE 0.41 MILES