

LAKE SURVEY MAP

WISCONSIN CONSERVATION DEPARTMENT
BIOLOGY DIVISION
LAKE AND STREAM IMPROVEMENT SECTION

LAKE SABIN FORM F-117
SECTION H2
TOWNSHIP 44 N
RANGE 10 W
TOWN OF GORDON
COUNTY DOUGLAS

11 1/2 Miles To
Mil. To 53

3 Mi. N. To A

3 Mi. N. To N

1/2 Mi. To County Line
1/2 Mi. E. To Y
2 Mi. N. on Y To Catherine Lake

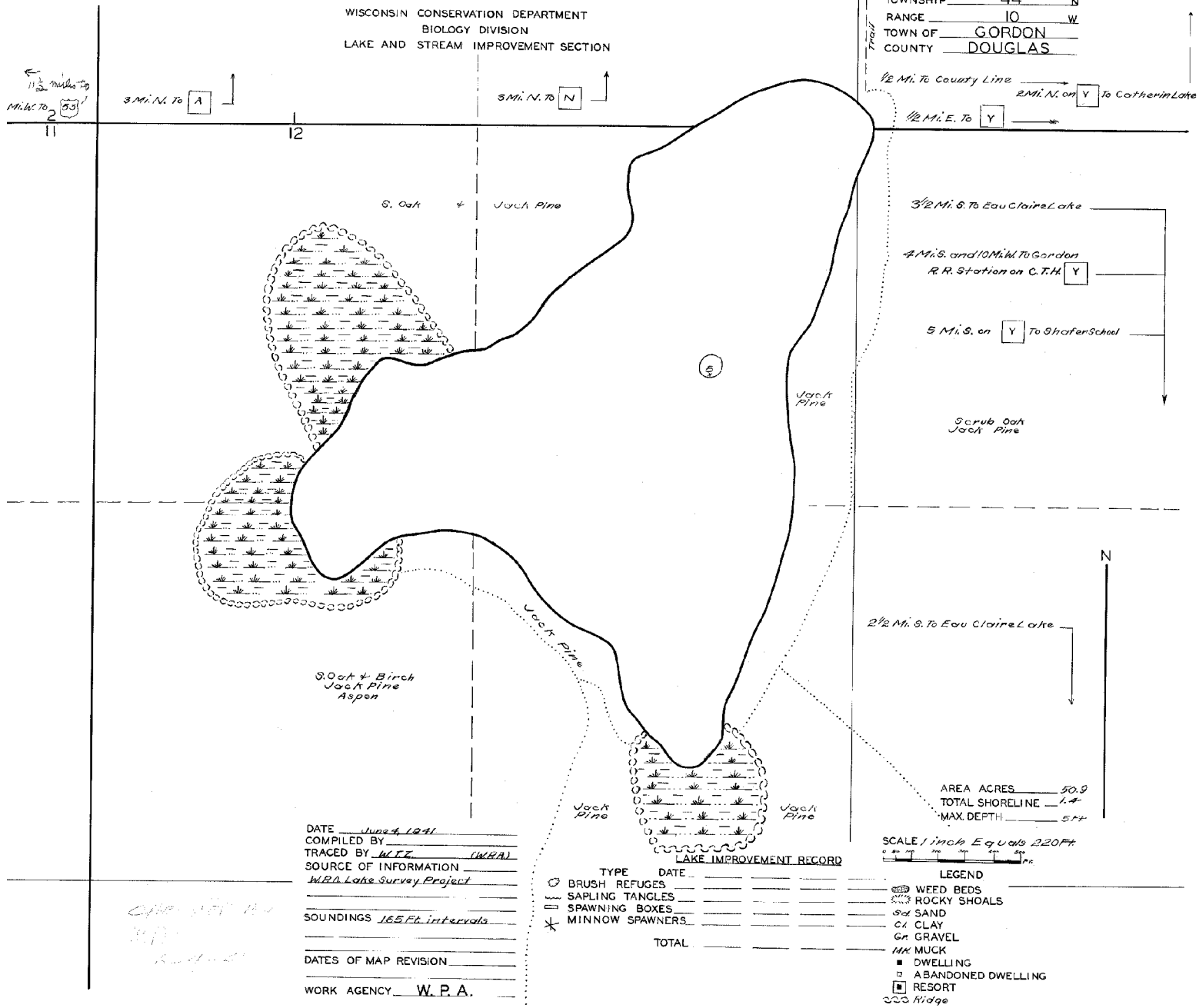

3 1/2 Mi. S. To Eau Claire Lake
4 Mi. S. and 10 Mi. W. To Gordon
R.R. Station on C.T.H. Y
5 Mi. S. on Y To Shafer School
Scrub Oak
Jack Pine

2 1/2 Mi. S. To Eau Claire Lake

AREA ACRES 50.9
TOTAL SHORELINE 1.4
MAX. DEPTH 5.4

SCALE 1 Inch Equals 220 Ft

DATE June 4, 1991
COMPILED BY _____
TRACED BY W.F.Z. (WRA)
SOURCE OF INFORMATION
WRA Lake Survey Project
SOUNDINGS 165 Ft. intervals
DATES OF MAP REVISION _____
WORK AGENCY W. P. A.

TYPE	DATE		
BRUSH REFUGES			
SAPLING TANGLES			
SPAWNING BOXES			
MINNOW SPAWNERS			
TOTAL			

- LEGEND
- WEED BEDS
 - ROCKY SHOALS
 - SAND
 - CLAY
 - GRAVEL
 - MUCK
 - DWELLING
 - ABANDONED DWELLING
 - RESORT
 - Ridge

Handwritten notes:
CAMP SITE 11-12
300'
Ridge