

LAKE MONTGOMERY
 SECTION 11, 12, 13 & 14
 TOWNSHIP 1 N.
 RANGE 20 E.
 TOWN SALEM
 COUNTY KENOSHA

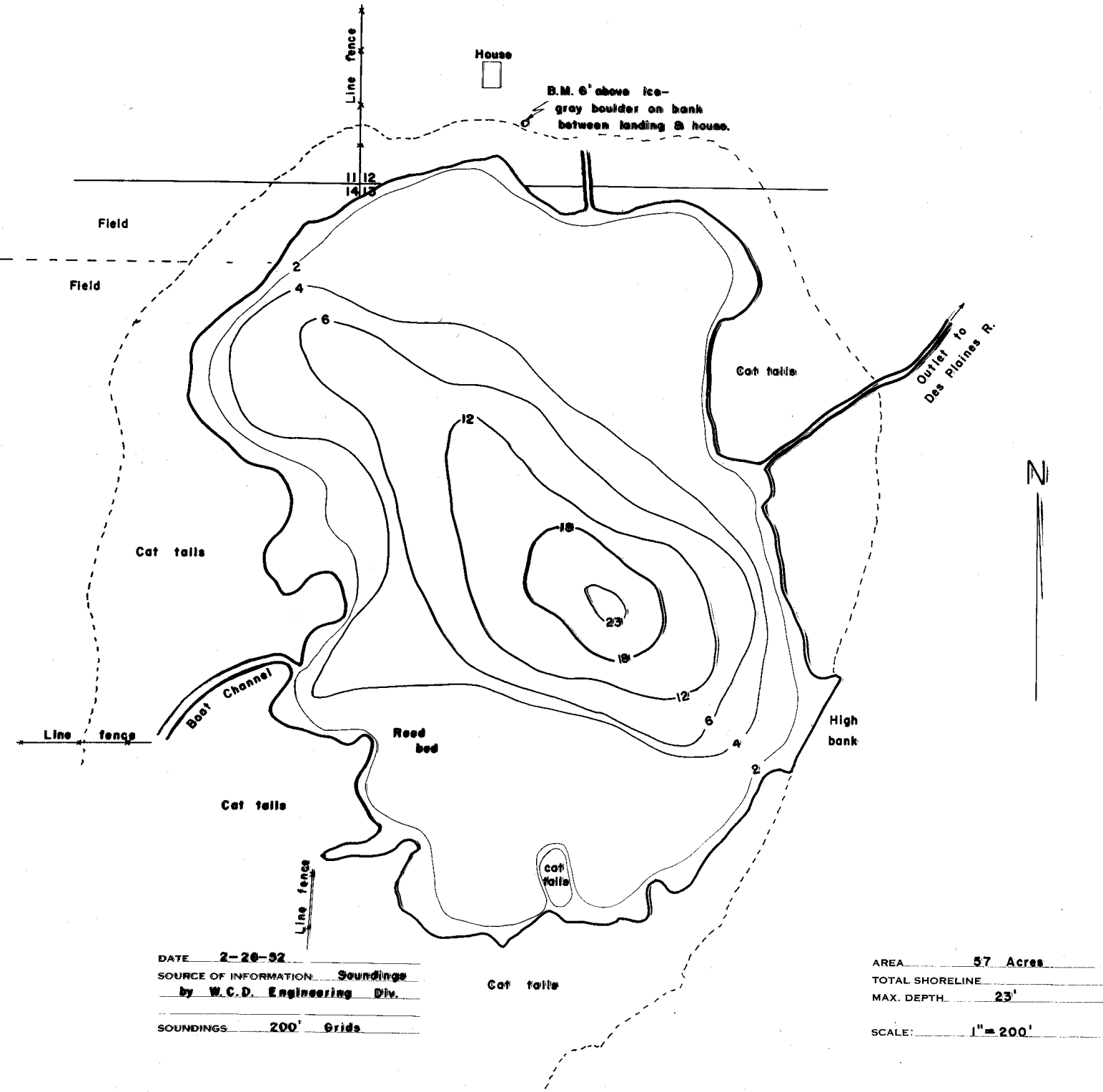

DATE 2-20-52
 SOURCE OF INFORMATION Soundings
by W.C.D. Engineering Div.
 SOUNDINGS 200' Grids

AREA 57 Acres
 TOTAL SHORELINE _____
 MAX. DEPTH 23'
 SCALE: 1" = 200'

Maps are not for navigation
Source-Wisconsin Department of Natural Resources
Hunt Fish Camp Wisconsin .Com 2005