

STATE OF WISCONSIN
DEPARTMENT OF NATURAL RESOURCES

LAKE SURVEY MAP

MILLER LAKE WASHBURN COUNTY
SEC. 1 T. 37 N. R. 12 E.W.

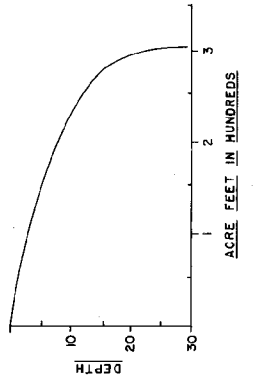
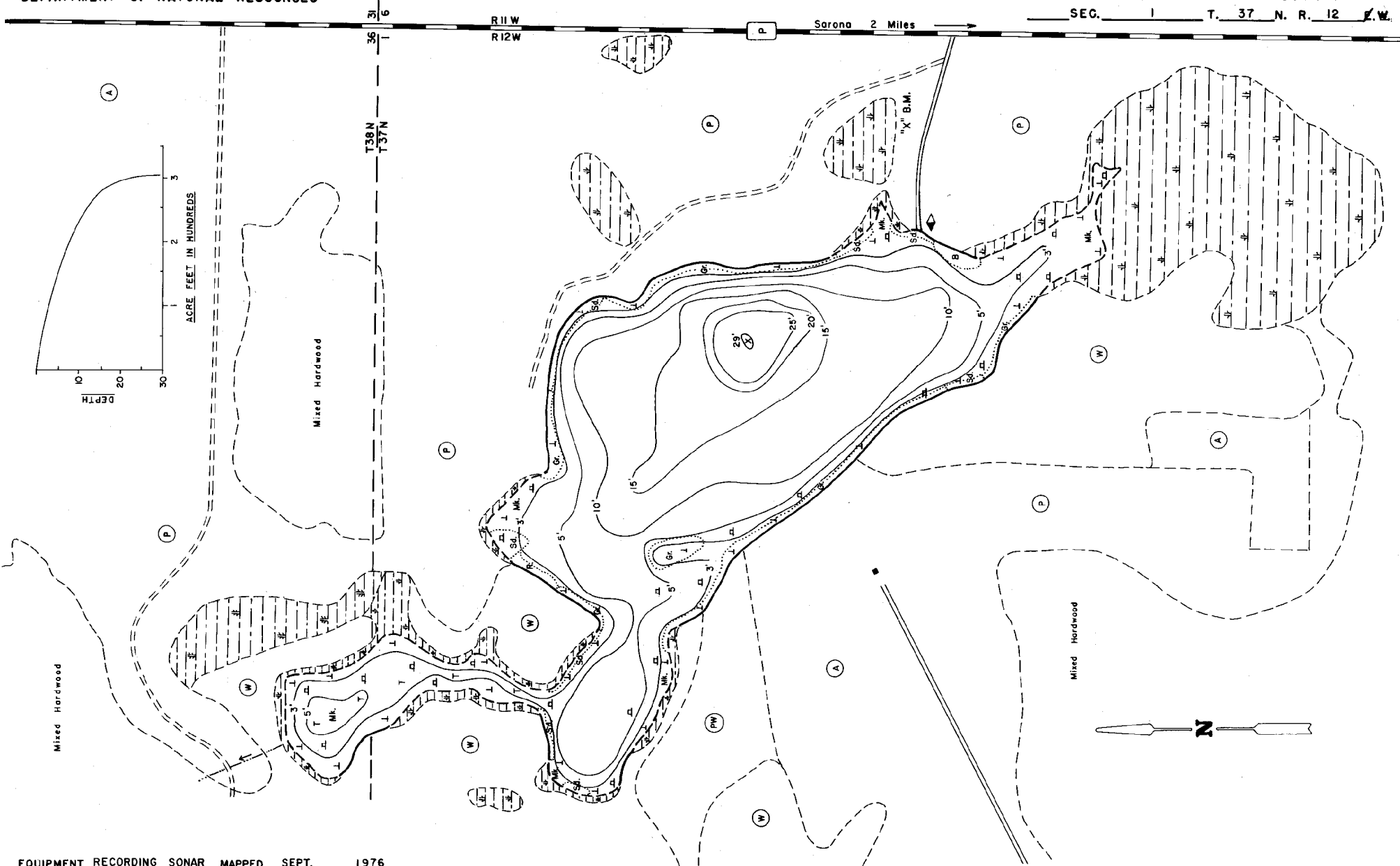

EQUIPMENT RECORDING SONAR MAPPED	SEPT. 1976	LAKE BOTTOM SYMBOLS
MONTH	YEAR	
(B) Brush	(P) Peat	(B) Boulders
(W) Partially wooded	(Mk) Muck	(S) Stumps & Snags
(W) Wooded	(C) Clay	(R) Rock danger to navigation
(C) Cleared	(M) Marl	(T) Submergent vegetation
(P) Pastured	(Sd) Sand	(E) Emergent vegetation
(A) Agricultural	(Sl) Silt	(F) Floating vegetation
B.M. Bench Mark	(Gr) Gravel	(B) Brush shelters
(D) Dwelling	(R) Rubble	
(R) Resort	(Bc) Bedrock	
(C) Camp		

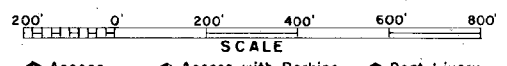

Access Access with Parking Boat Livery
Drawn by: J. Koppe
Field work by: C. Busch, K. Cable, L. Sather

SPECIES OF FISH	ABUNDANCE	
	Abundant	Present
Muskie		
N. Pike	X	
Walleye	X	
L. M. Bass	X	
S. M. Bass	X	
Panfish	X	
Trout		

WATER AREA 35.4 ACRES
UNDER 3 FT. 21 %
OVER 20 FT. 5 %
MAX. DEPTH 29 FEET.
TOTAL ALK. 11 P.P.M.
VOLUME 302.18 ACRE FT.
MAIN SHORELINE 1.7 MI.
ISLAND SHORELINE 0 MI.