

WISCONSIN CONSERVATION DEPARTMENT

LAKE SURVEY MAP

MILES \_\_\_\_\_  
LAKE \_\_\_\_\_  
WASHBURN COUNTY  
SEC. 3 T. 42 N. R. 12 W.

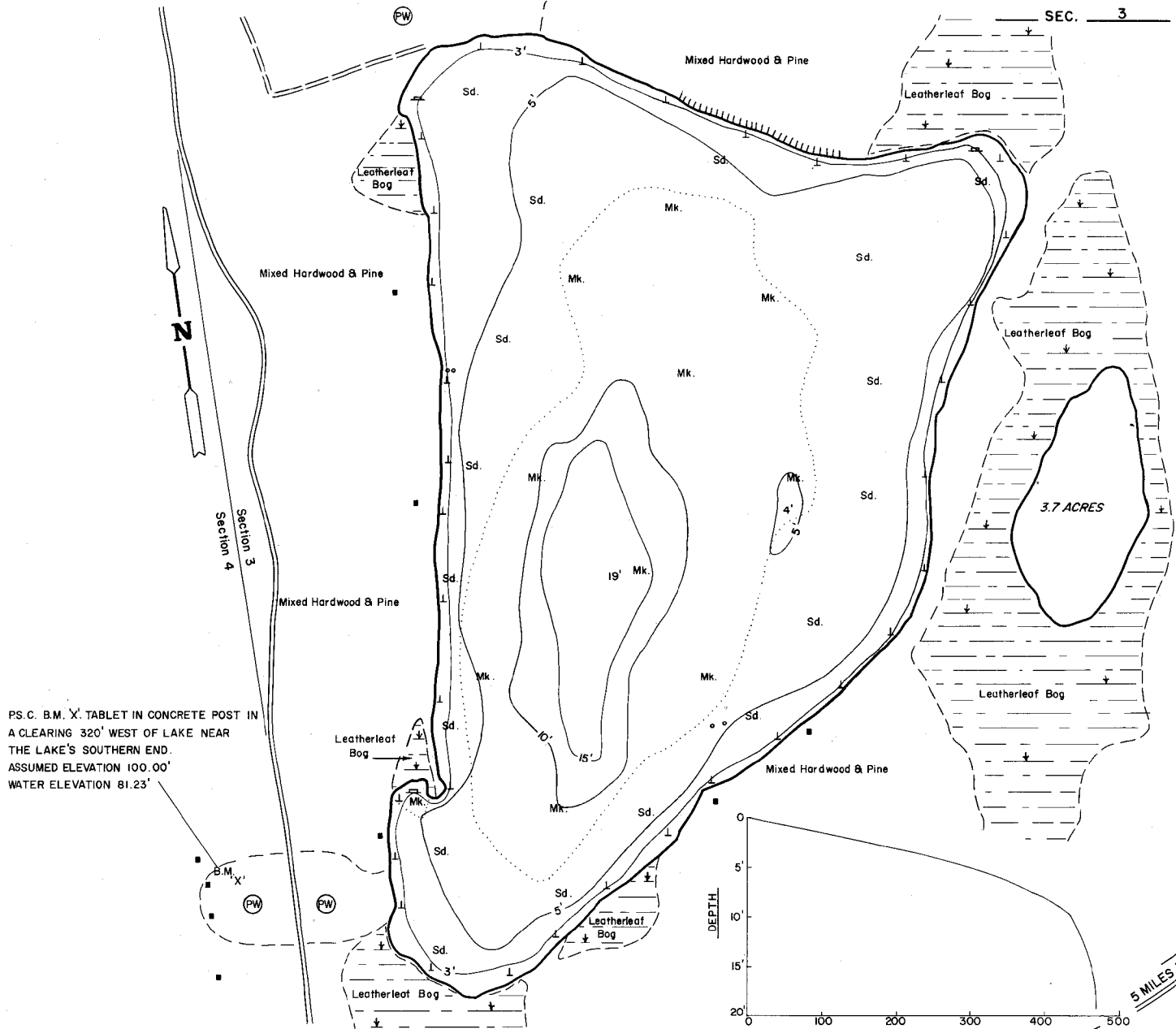

PS.C. B.M. 'X' TABLET IN CONCRETE POST IN A CLEARING 320' WEST OF LAKE NEAR THE LAKE'S SOUTHERN END. ASSUMED ELEVATION 100.00' WATER ELEVATION 81.23'

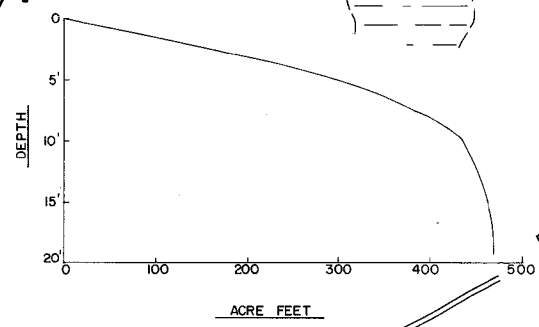

5 MILES TO MINONG

EQUIPMENT RECORDING SONAR MAPPED JUNE 1967  
MO. YR.

- TOPOGRAPHIC SYMBOLS
- (B) Brush
  - (PW) Partially wooded
  - (W) Wooded
  - (C) Cleared
  - (P) Pastured
  - (A) Agricultural
  - B.M. Bench Mark
  - Steep slope
  - Indefinite shoreline
  - Marsh
  - Spring
  - Intermittent stream
  - Permanent inlet
  - Permanent outlet

- LAKE BOTTOM SYMBOLS
- P. Peat
  - Mk. Muck
  - C. Clay
  - M. Marl
  - Gr. Gravel
  - R. Rubble
  - Br. Bedrock
  - T. Submergent vegetation
  - Stumps & Snags

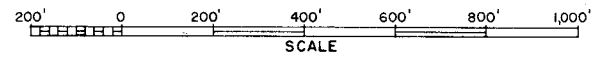

SPECIES OF FISH	Abundance		
	Abundant	Common	Rare
Muskie			
N. Pike		X	
Walleye			
L.M. Bass		X	
S.M. Bass			
Panfish	X		
Trotl			

AREA 64.4 ACRES  
UNDER 3FT. 7.4 %  
OVER 20FT. 0.0 %  
VOLUME 469.9 ACRE FT.  
TOTAL ALK. 8 P.P.M.  
SHORELINE 1.4 MILES

◇ Access      ◆ Access with Parking      ▲ Boat Livery