

STATE OF WISCONSIN
DEPARTMENT OF NATURAL RESOURCES

LAKE SURVEY MAP

MIDDLE SUGARBUSH LAKE
VILAS COUNTY
SEC. 16, 17, 18, 19, 20, 21 T. 41 N. R. 5 E.

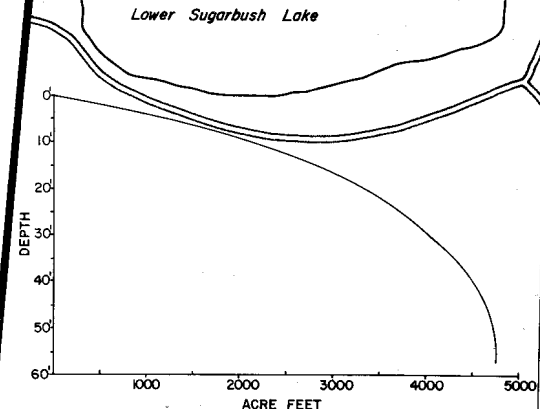
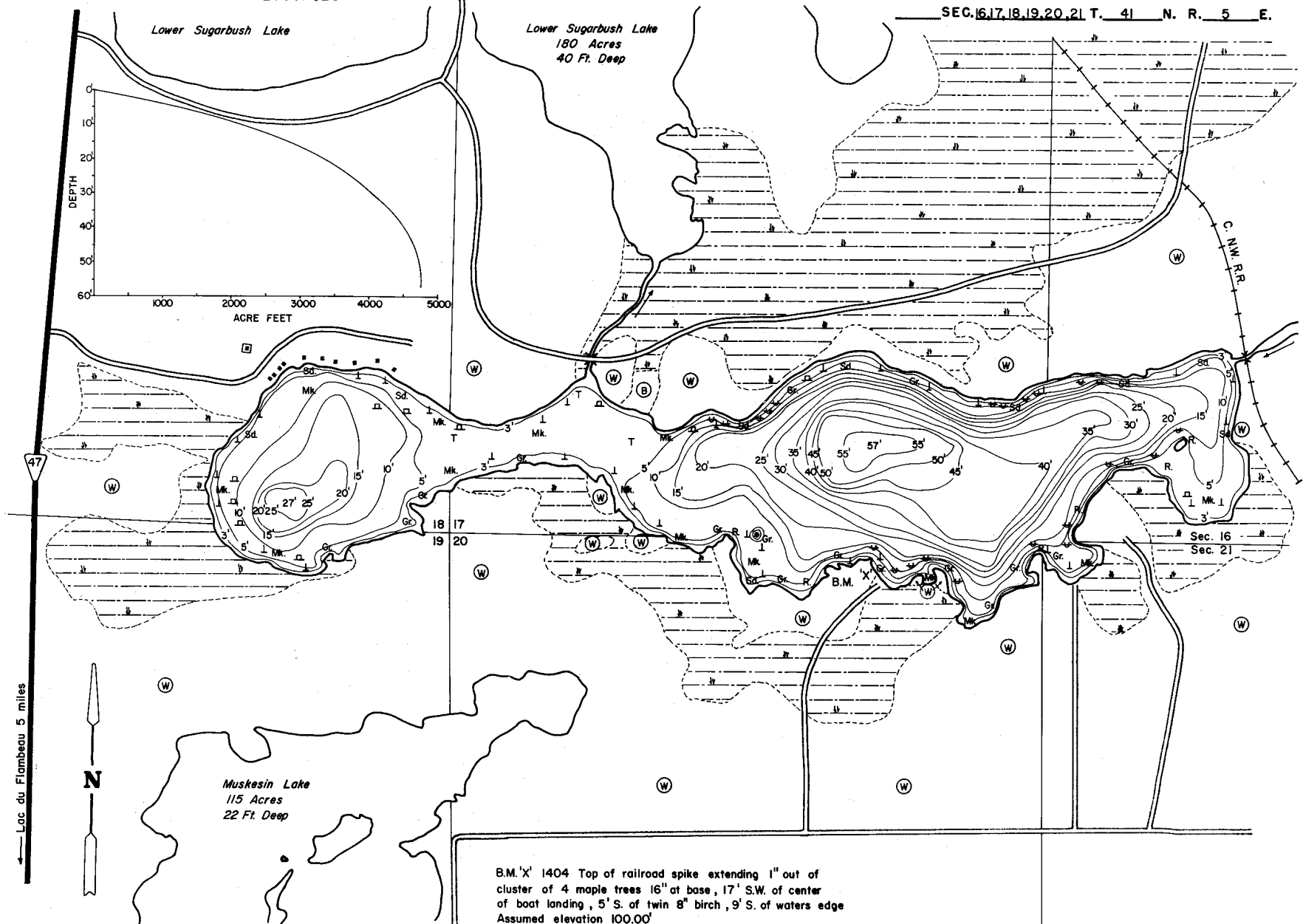

47
← Lac du Flambeau 5 miles



B.M. 'X' 1404 Top of railroad spike extending 1" out of cluster of 4 maple trees 16" at base, 17' S.W. of center of boat landing, 5' S. of twin 8" birch, 9' S. of waters edge
Assumed elevation 100.00'
Water level 95.72'

EQUIPMENT RECORDING SONAR MAPPED JUNE 1968
MONTH YEAR

- TOPOGRAPHIC SYMBOLS
- (B) Brush
 - (PW) Partially wooded
 - (W) Wooded
 - (C) Cleared
 - (P) Pastured
 - (A) Agricultural
 - B.M. Bench Mark
 - Dwelling
- LAKE BOTTOM SYMBOLS
- ||||| Steep slope
 - ~ Indefinite shoreline
 - ~ Marsh
 - ~ Spring
 - ~ Intermittent stream
 - ~ Permanent inlet
 - ~ Permanent outlet
 - ~ Dam
 - P. Peat
 - Mk. Muck
 - C. Clay
 - M. Marl
 - Sd. Sand
 - St. Silt
 - Gr. Gravel
 - R. Rubble
 - B. Boulders
 - ♣ Stumps & Snags
 - ⊙ Rock danger to navigation
 - T Submergent vegetation
 - ⊥ Emergent vegetation
 - ⊔ Floating vegetation
 - ⊕ Brush shelters

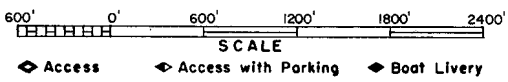

SPECIES OF FISH	Abundance		
	Abundant	Common	Present
Muskie		X	X
N. Pike		X	X
Walleye		X	X
L.M. Bass		X	X
S.M. Bass		X	X
Panfish	X		

WATER AREA 269.2 ACRES
 UNDER 3 FT. 8.3 %
 OVER 20 FT. 34.8 %
 MAX. DEPTH 57 FEET.
 TOTAL ALK. 50 P.P.M.
 VOLUME 4761 ACRE FT.
 SHORELINE 5.0 MILES