

STATE OF WISCONSIN
DEPARTMENT OF NATURAL RESOURCES

LAKE SURVEY MAP

MC NAUGHTON LAKE ONEIDA COUNTY
SEC. 26 35 T. 38 N. R. 7 E.

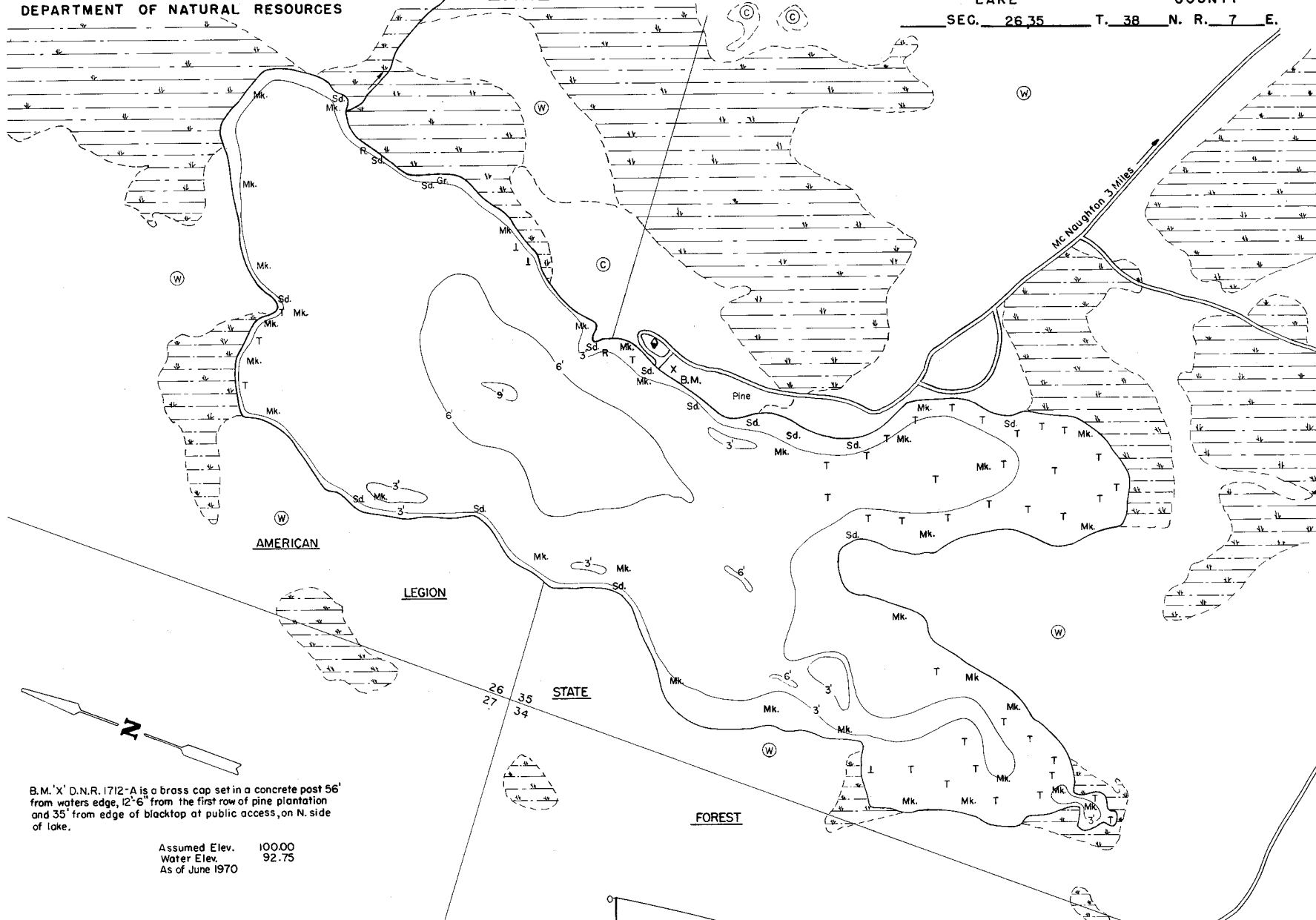

B.M. 'X' D.N.R. 1712-A is a brass cap set in a concrete post 56' from waters edge, 12' 6" from the first row of pine plantation and 35' from edge of backdrop at public access, on N. side of lake.

Assumed Elev. 100.00
Water Elev. 92.75
As of June 1970

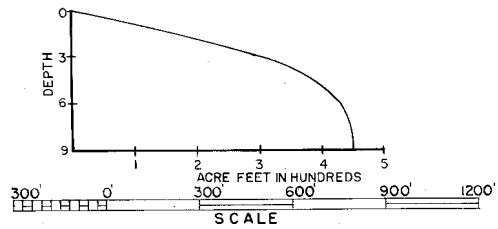

EQUIPMENT RECORDING SONAR MAPPED JULY 1970
MONTH YEAR
LAKE BOTTOM SYMBOLS

- | | | | |
|-----------------------|----------------------------|---------------------|-----------------------------|
| TOPOGRAPHIC SYMBOLS | | LAKE BOTTOM SYMBOLS | |
| (B) Brush | Steep slope | P. Peat | B Boulders |
| (PW) Partially wooded | - - - Indefinite shoreline | Mk. Muck | ☼ Stumps & Snags |
| (W) Wooded | ~ ~ ~ Marsh | C. Clay | ☼ Rock danger to navigation |
| (C) Cleared | o Spring | M. Marl | T Submergent vegetation |
| (P) Pastured | - - - Intermittent stream | Sd. Sand | ↑ Emergent vegetation |
| (A) Agricultural | — Permanent inlet | St. Silt | ☼ Floating vegetation |
| B.M. Bench Mark | — Permanent outlet | Gr. Gravel | ☼ Brush shelters |
| ■ Dwelling | — Dam | R. Rubble | |

SPECIES OF FISH	Abundance		
	Common	Abundant	Present
Muskie			
N. Pike	X		
Walleye			
L. M. Bass			
S. M. Bass			
Panfish			
Ferret	X		

WATER AREA 115.3 ACRES
UNDER 3 FT. 30 %
OVER 20 FT. 0 %
MAX. DEPTH 9 FEET.
TOTAL ALK. 45 P.P.M.
VOLUME 454.7 ACRE FT.
SHORELINE 2.79 MILES

Access Access with Parking Boat Livery
Drawn by: J. Kuehn