

STATE OF WISCONSIN
DEPARTMENT OF NATURAL RESOURCES

LAKE SURVEY MAP

MCKINLEY
LAKE

WASHBURN
COUNTY

SEC. 25.36 T. 40 - N. R. 13 - W.

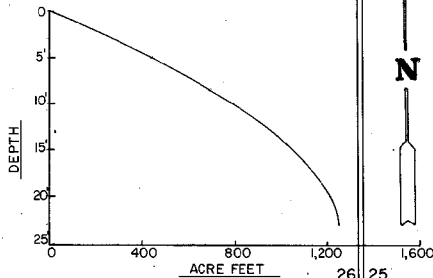
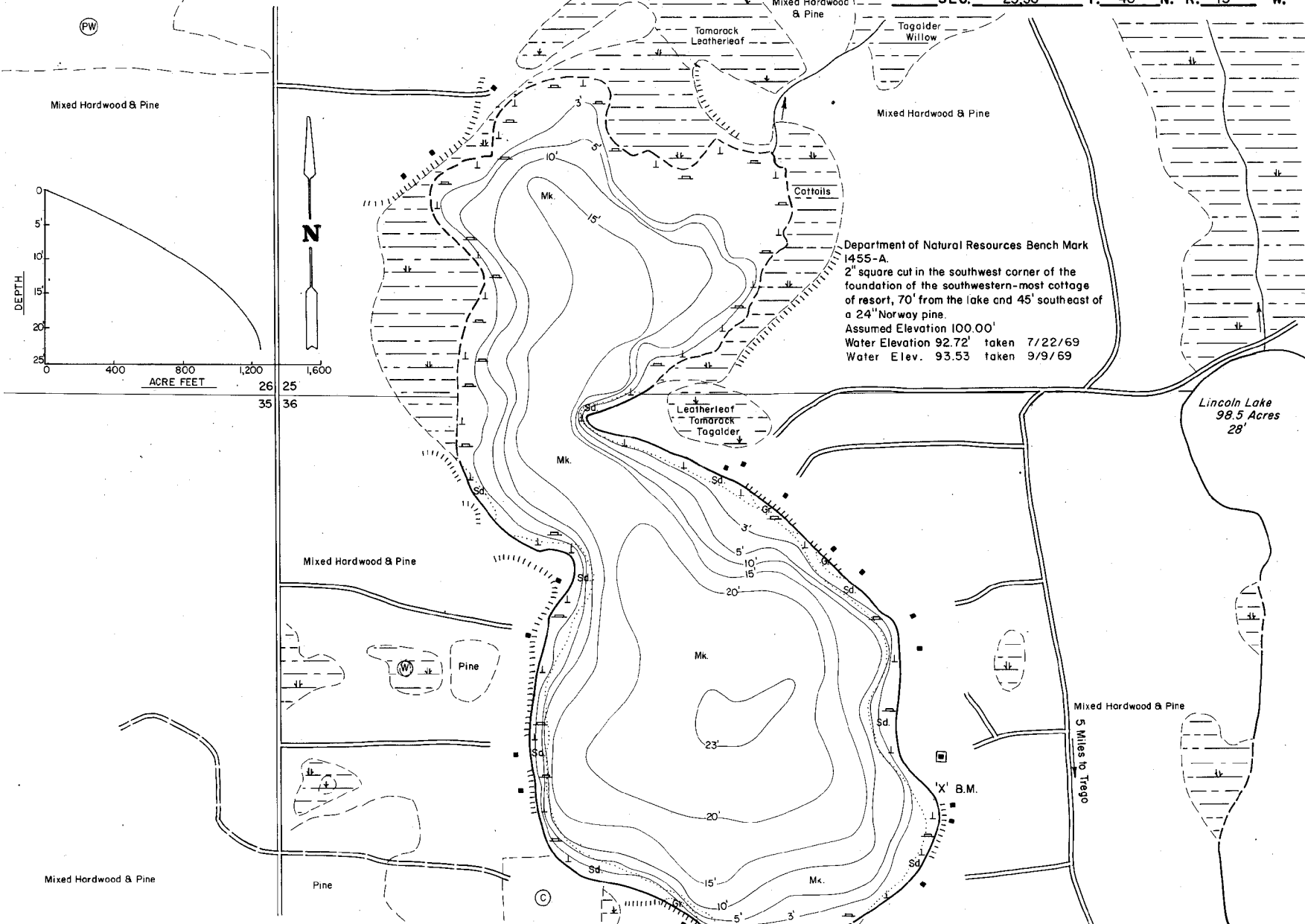

Department of Natural Resources Bench Mark
1455-A.
2' square cut in the southwest corner of the
foundation of the southwestern-most cottage of
resort, 70' from the lake and 45' southeast of
a 24" Norway pine.
Assumed Elevation 100.00'
Water Elevation 92.72' taken 7/22/69
Water Elev. 93.53 taken 9/9/69

Lincoln Lake
98.5 Acres
28'

EQUIPMENT RECORDING SONAR MAPPED OCTOBER 1969

TOPOGRAPHIC SYMBOLS		LAKE BOTTOM SYMBOLS	
(B) Brush	Steep slope	P. Peat	B Boulders
(PW) Partially wooded	----- Indefinite shoreline	Mk. Muck	☼ Stumps & Snags
(W) Wooded	Marsh	C. Clay	☼ Rock danger to navigation
(C) Cleared	o Spring	M. Marl	T Submergent vegetation
(P) Pastured	--- Intermittent stream	Sd. Sand	↓ Emergent vegetation
(A) Agricultural	--- Permanent inlet	Sl. Silt	--- Floating vegetation
B.M. Bench Mark	--- Permanent outlet	Gr. Gravel	⚡ Brush shelters

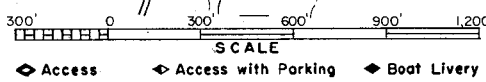

SPECIES OF FISH	Abundance		
	Abundant	Common	Present
Muskie			
N. Pike		X	
Walleye			X
L. M. Bass		X	
S. M. Bass			
Ponfish	X		

WATER AREA 104.9 ACRES
UNDER 3 FT. 19 %
OVER 20 FT. 20 %
MAX. DEPTH 23 FEET.
TOTAL ALK. 50 P.P.M.
VOLUME 1,249.6 ACRE FT.
SHORELINE 2.2 MILES