

STATE OF WISCONSIN  
DEPARTMENT OF NATURAL RESOURCES

LAKE SURVEY MAP

MCCORMICK LAKE ONEIDA COUNTY  
SEC. 5, 6, 31, 32 T. 38 N. R. 6 E.

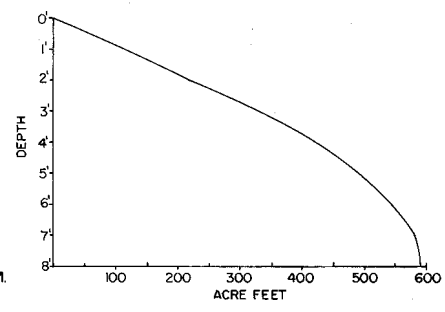
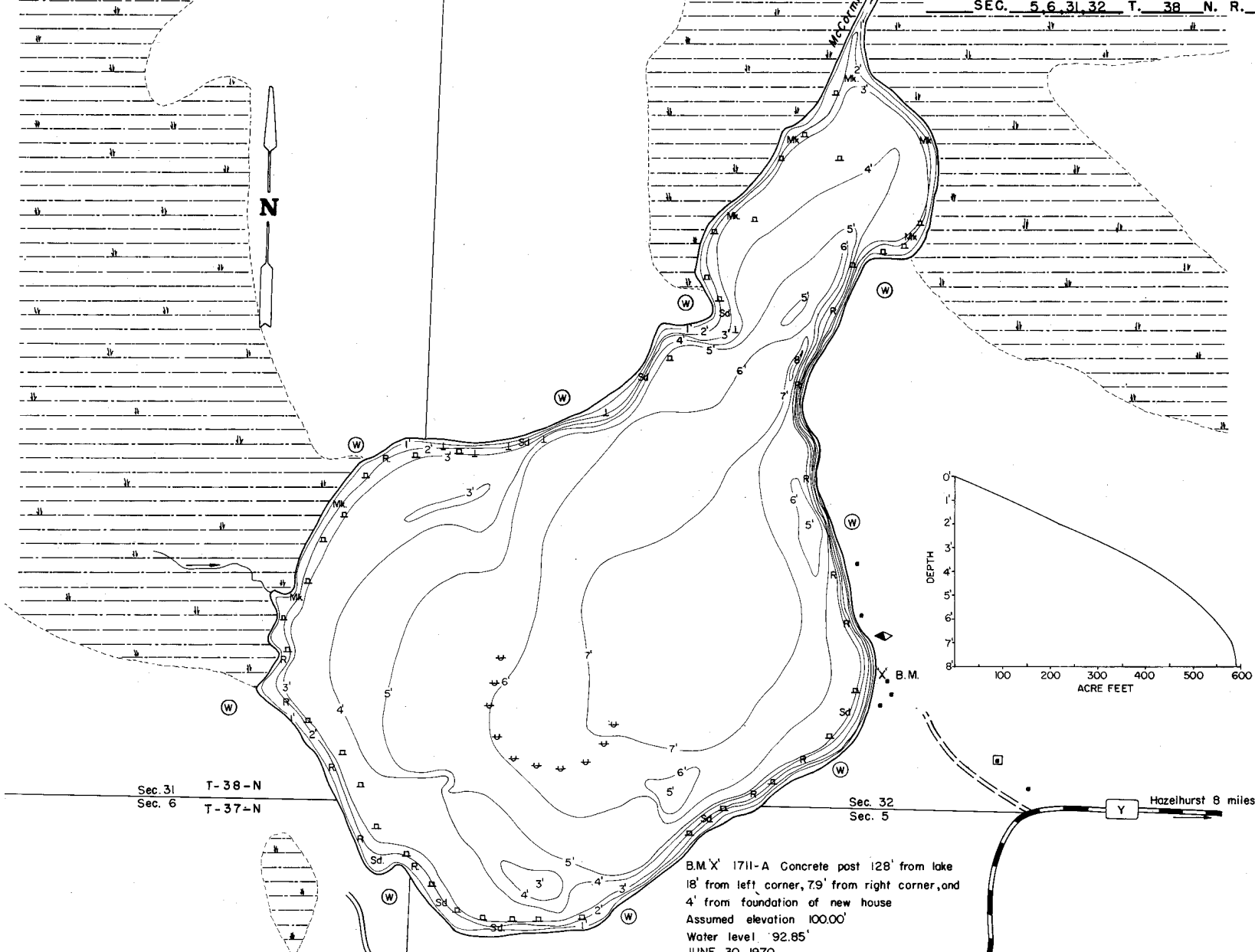

B.M. X 1711-A Concrete post 128' from lake  
18' from left corner, 7.9' from right corner, and  
4' from foundation of new house  
Assumed elevation 100.00'  
Water level 92.85'  
JUNE 30, 1970

EQUIPMENT RECORDING SONAR MAPPED MAY 1970

- | TOPOGRAPHIC SYMBOLS   |                        | LAKE BOTTOM SYMBOLS |                             |
|-----------------------|------------------------|---------------------|-----------------------------|
| (B) Brush             | Steep slope            | P. Peat             | B Boulders                  |
| (PW) Partially wooded | ~ Indefinite shoreline | Mk. Muck            | * Stumps & Snags            |
| (W) Wooded            | ~ Marsh                | C. Clay             | ⊙ Rock danger to navigation |
| (C) Cleared           | ~ Spring               | M. Marl             | T Submergent vegetation     |
| (P) Pastured          | ~ Intermittent stream  | Sd. Sand            | 1 Emergent vegetation       |
| (A) Agricultural      | ~ Permanent inlet      | St. Silt            | ~ Floating vegetation       |
| B.M. Bench Mark       | ~ Permanent outlet     | Gr. Gravel          | + Brush shelters            |
| ■ Dwelling            | ~ Dam                  | R. Rubble           |                             |



- Access Access with Parking Boat Livery

| SPECIES OF FISH        | Abundance |         |
|------------------------|-----------|---------|
|                        | Common    | Present |
| Occasional Winter Kill |           | X       |
| Muskie                 |           | X       |
| N. Pike                |           | X       |
| Walleye                |           | X       |
| L. M. Bass             | X         | X       |
| S. M. Bass             | X         | X       |
| Panfish                | X         | X       |

WATER AREA 118.4 ACRES  
UNDER 3 FT. 9.5 %  
OVER 20 FT. 0 %  
MAX. DEPTH 8 FEET.  
TOTAL ALK. 33 P.P.M.  
VOLUME 589 ACRE FT.  
SHORELINE 2.14 MILES