

STATE OF WISCONSIN  
DEPARTMENT OF NATURAL RESOURCES

LAKE SURVEY MAP

MANN LAKE  
VILAS COUNTY  
SEC. 31,32 T. 41 N. R. 7 E.

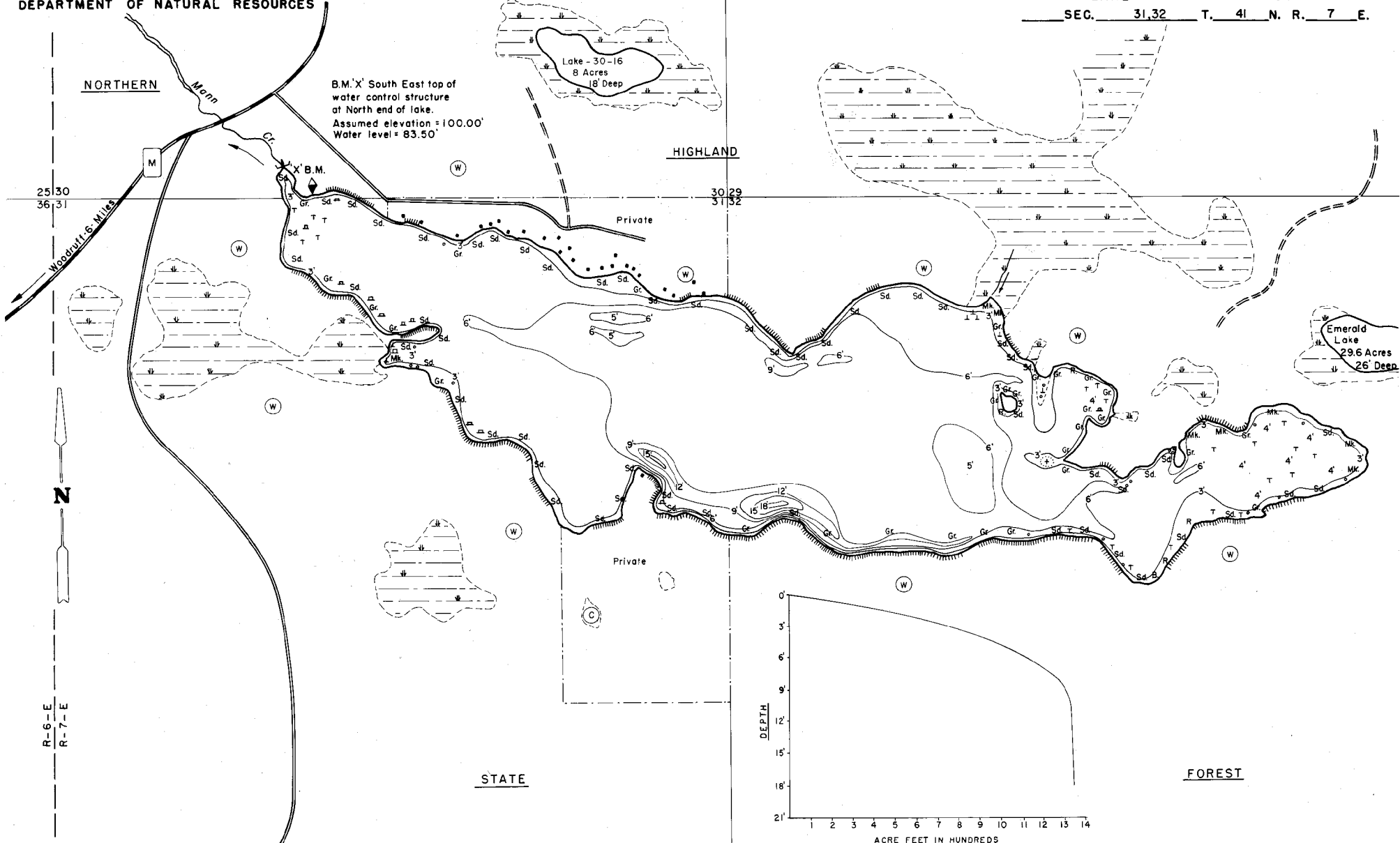

EQUIPMENT RECORDING SONAR MAPPED AUG 1973  
MONTH YEAR

- | TOPOGRAPHIC SYMBOLS   |                            | LAKE BOTTOM SYMBOLS |                             |
|-----------------------|----------------------------|---------------------|-----------------------------|
| (B) Brush             | Steep slope                | P. Peat             | B Boulders                  |
| (PW) Partially wooded | - - - Indefinite shoreline | Mk. Muck            | ⊕ Stumps & Snags            |
| (W) Wooded            | Marsh                      | C. Clay             | ⊗ Rock danger to navigation |
| (C) Cleared           | Spring                     | M. Marl             | T Submergent vegetation     |
| (P) Pastured          | Intermittent stream        | Sd. Sand            | ⊥ Emergent vegetation       |
| (A) Agricultural      | Permanent inlet            | St. Silt            | △ Floating vegetation       |
| B.M. Bench Mark       | Permanent outlet           | Gr. Gravel          | ⬆ Brush shelters            |
| ■ Dwelling            | Dam                        | R. Rubble           |                             |
| □ Resort              | D.N.R. State owned land    | Br. Bedrock         |                             |
| □ Camp                |                            |                     |                             |

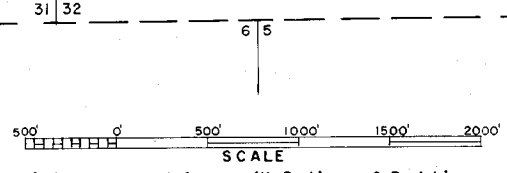

Drawn by: G. Thuesen  
Field work by: J. Smith

SPECIES OF FISH	ABUNDANT	
	Present	Present
Muskie		
N. Pike	X	
Walleye		
L. M. Bass		X
S. M. Bass		
Panfish	X	
Trout		

WATER AREA 261.07 ACRES  
UNDER 3 FT. 9.07 %  
OVER 20 FT. 0 %  
MAX. DEPTH 18 FEET.  
TOTAL ALK. 55 P.P.M.  
VOLUME 1338.66 ACRE FT.  
MAIN SHORELINE 4.75 MI.  
ISLAND SHORELINE 0.19 MI.