

STATE OF WISCONSIN  
DEPARTMENT OF NATURAL RESOURCES

LAKE SURVEY MAP

MAIDEN LAKE  
OCONTO COUNTY  
SEC. 5-7-8-1B T. 32 N. R. 16 E.W.

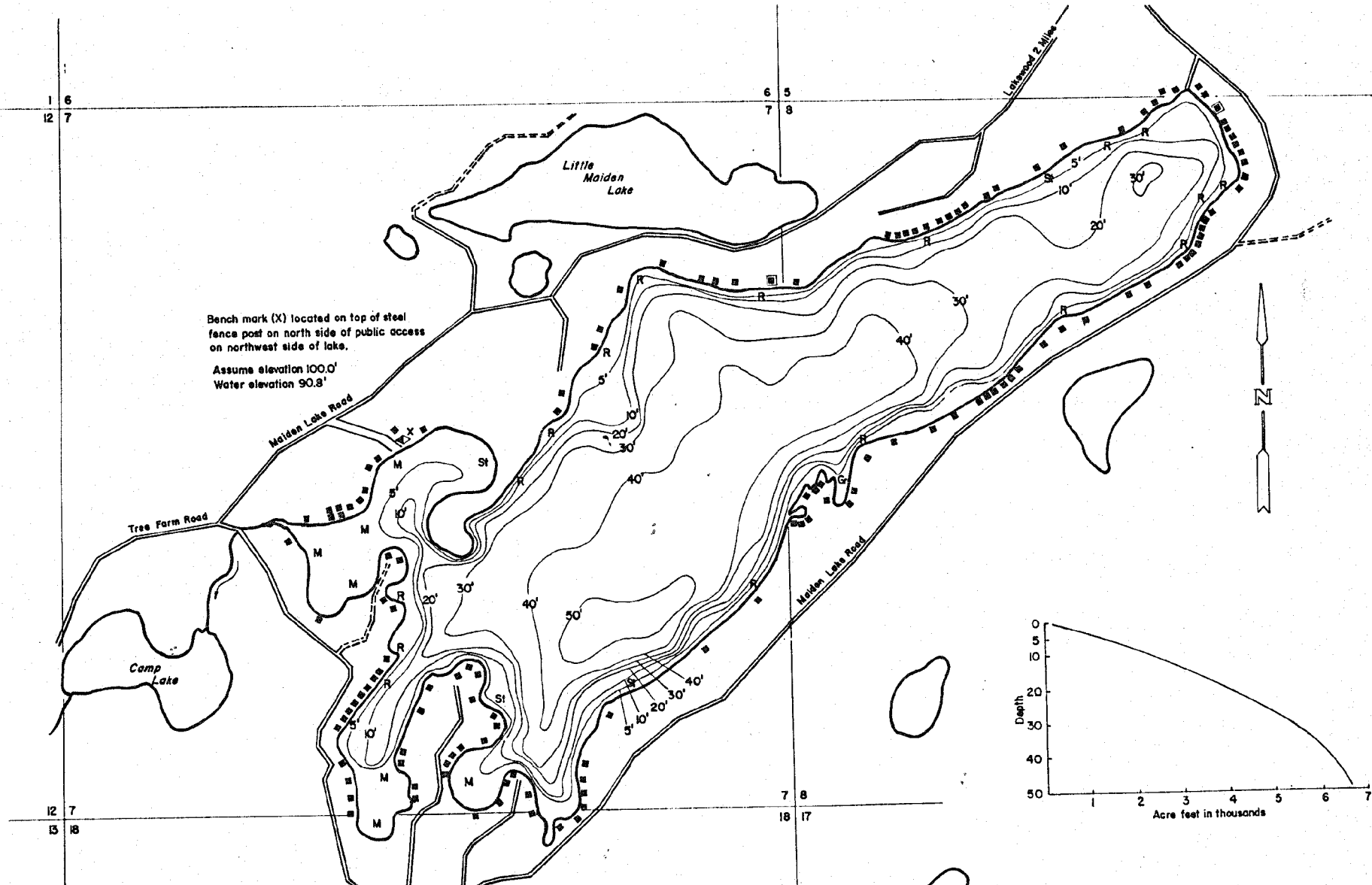

EQUIPMENT	RECORDING SONAR	MAPPED	JUNE MONTH	1978 YEAR
<b>TOPOGRAPHIC SYMBOLS</b>				
(B) Brush	(//) Steep slope	P. Peat	B. Boulders	
(PW) Partially wooded	(~) Indefinite shoreline	Mt. Muck	St. Stumps & Snags	
(W) Wooded	(M) Marsh	C. Clay	⚠ Rock danger to navigation	
(C) Cleared	(S) Spring	M. Marl	T Submergent vegetation	
(P) Pastured	(~) Intermittent stream	Sd. Sand	I Emergent vegetation	
(A) Agricultural	(=) Permanent inlet	St. Sill	F Floating vegetation	
B.M. Bench Mark	(=) Permanent outlet	Gr. Gravel	⚡ Brush shelters	
(D) Dwelling	(D) Dam	R. Rubble		
(R) Resort	(D.N.R.) State owned land	Bc. Bedrock		



◊ Access   ◊ Access with Parking   ◊ Boat Livery  
Drawn by: W. Berwig  
Field work by: J. O'Brien-R. Thrun

SPECIES OF FISH	Abundance	
	(X)	(%)
Muskie		
N Pike	X	
Walleye	X	
L.M. Bass	X	
S.M. Bass	X	
Panfish	X	
Trout		

WATER AREA	269	ACRES
UNDER 5 FT.	19	%
OVER 20 FT.	39	%
MAX. DEPTH	52	FEET.
TOTAL ALK.	90.3	P.P.M.
VOLUME	6545.5	ACRE FT.
MAIN SHORELINE	5.6	MI.
ISLAND SHORELINE		MI.