

STATE OF WISCONSIN
DEPARTMENT OF NATURAL RESOURCES

LAKE SURVEY MAP

LITTLE STONE LAKE
WASHBURN COUNTY
SEC. 13, 24 T. 39 N. R. 10 W.

B.M. 'X' Square cut in base of pump at
wyside N. of county "Hy A", 105' N. of
centerline of county "Hy A" and 145' N. of
waters edge at access of lake
Access elevation 100.00'
Water level 93.63'

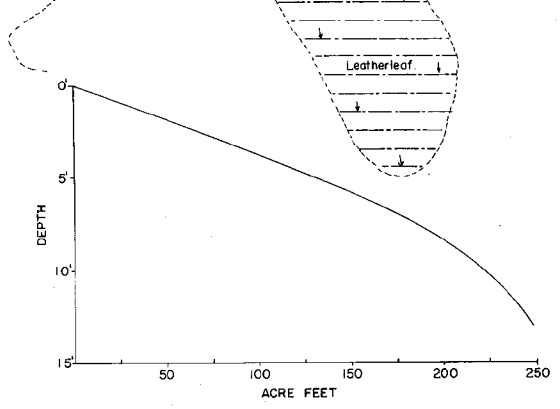
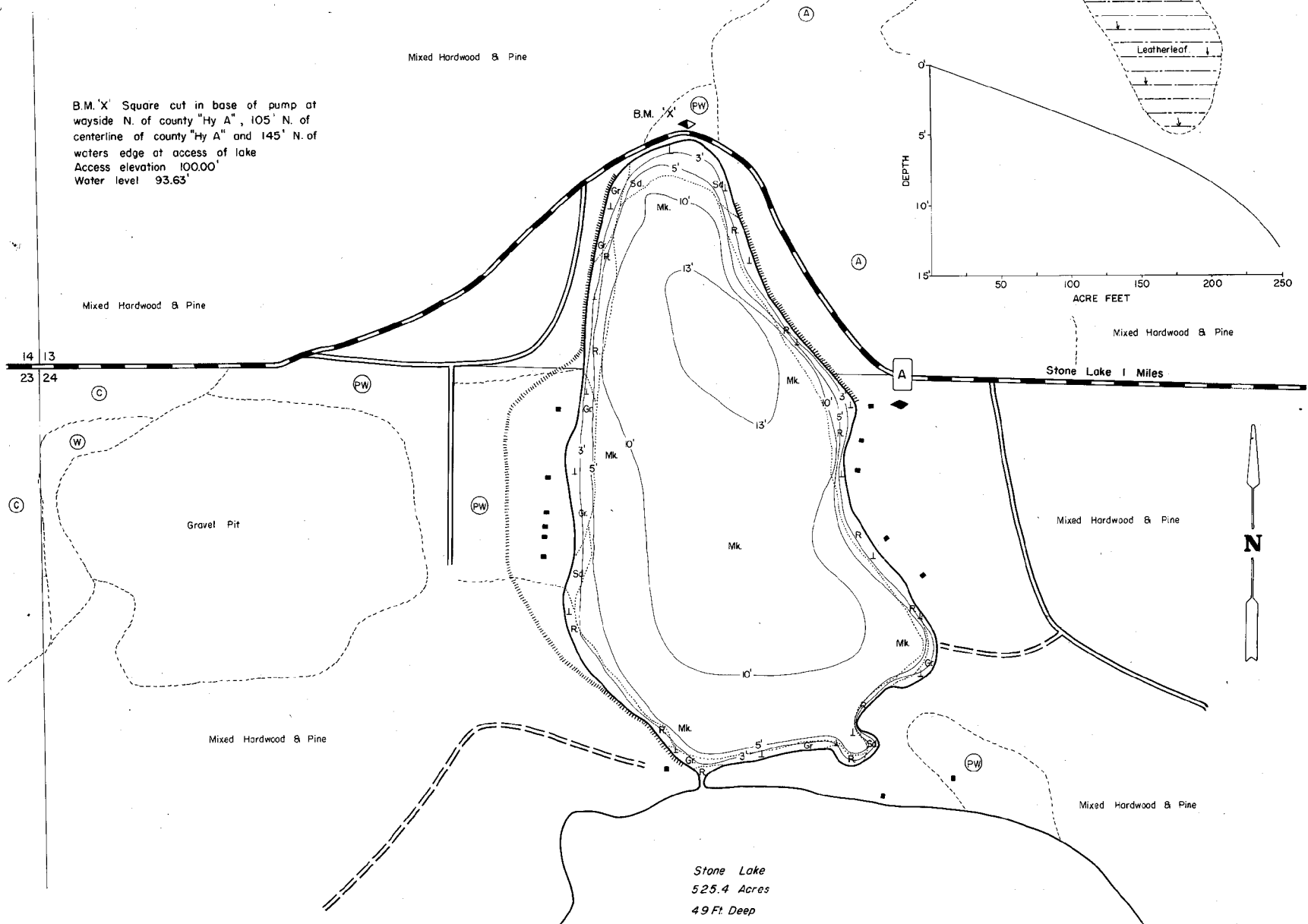

EQUIPMENT RECORDING SONAR MAPPED JUNE 1969

- | TOPOGRAPHIC SYMBOLS | | LAKE BOTTOM SYMBOLS | |
|-----------------------|----------------------------|---------------------|-------------------------------|
| (B) Brush | () Steep slope | P. Peat | B Boulders |
| (PW) Partially wooded | (---) Indefinite shoreline | Mk. Muck | (*) Stumps & Snags |
| (W) Wooded | (---) Marsh | C. Clay | (*) Rock danger to navigation |
| (C) Cleared | (---) Spring | M. Marl | (T) Submergent vegetation |
| (P) Pastured | (---) Intermittent stream | Sd. Sand | (I) Emergent vegetation |
| (A) Agricultural | (---) Permanent inlet | St. Silt | (F) Floating vegetation |
| B.M. Bench Mark | (---) Permanent outlet | Gr. Gravel | (*) Brush shelters |
| (■) Dwelling | (---) Dam | R. Rubble | |



Access Access with Parking Boat Livery
Drawn by: C. Holt

SPECIES OF FISH

Species	Abundant		Common		Present	
	X		X		X	
Muskie						
N. Pike					X	
Walleye			X			
L.M. Bass			X			
S.M. Bass			X			
Panfish			X			
Trout			X			

WATER AREA 27.0 ACRES
UNDER 3 FT. 5 %
OVER 20 FT. 0 %
MAX. DEPTH 13 FEET.
TOTAL ALK. 16 P.P.M.
VOLUME 248.9 ACRE FT.
SHORELINE 0.91 MILES