

STATE OF WISCONSIN  
DEPARTMENT OF NATURAL RESOURCES

LAKE SURVEY MAP

LITTLE SAND LAKE  
SAWYER COUNTY  
SEC. 19, 20 T. 39 N. R. 9 W.

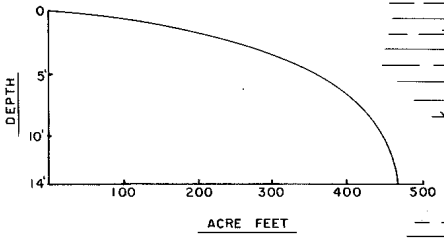
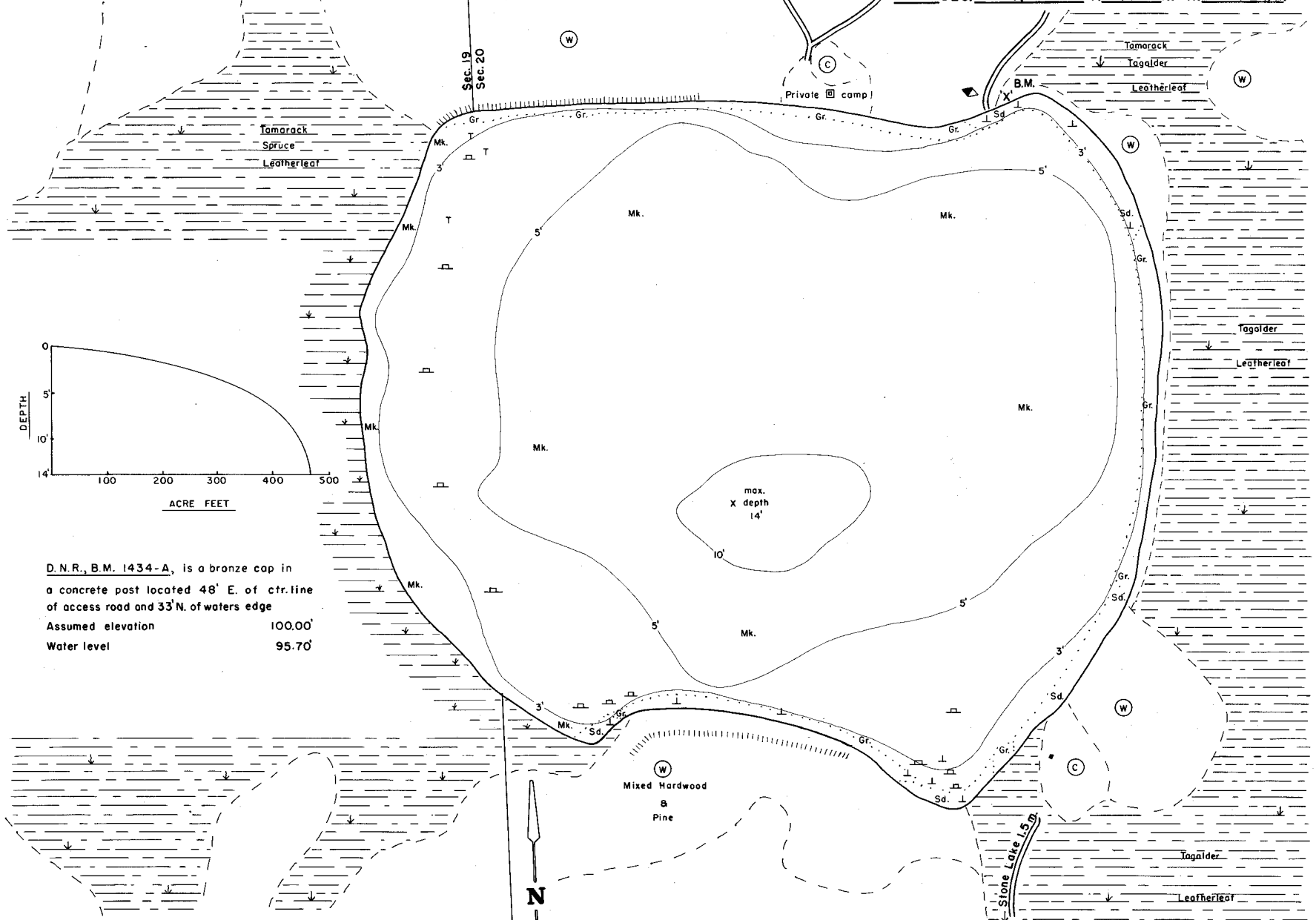

D.N.R., B.M. 1434-A, is a bronze cap in a concrete post located 48' E. of ctr. line of access road and 33' N. of waters edge  
Assumed elevation 100.00'  
Water level 95.70'

EQUIPMENT RECORDING SONAR MAPPED AUG. 1969  
MONTH YEAR

- | TOPOGRAPHIC SYMBOLS   |                            | LAKE BOTTOM SYMBOLS |                             |
|-----------------------|----------------------------|---------------------|-----------------------------|
| (B) Brush             | Steep slope                | P. Peat             | B Boulders                  |
| (PW) Partially wooded | - - - Indefinite shoreline | Mk. Muck            | ⊙ Stumps & Snags            |
| (W) Wooded            | Marsh                      | C. Clay             | ⊙ Rock danger to navigation |
| (C) Cleared           | ⊙ Spring                   | M. Marl             | ⊙ Submergent vegetation     |
| (P) Pastured          | ~ ~ ~ Intermittent stream  | Sd. Sand            | ⊙ Emergent vegetation       |
| (A) Agricultural      | ⊙ Permanent inlet          | S1. Silt            | ⊙ Floating vegetation       |
| B.M. Bench Mark       | ⊙ Permanent outlet         | Gr. Gravel          | ⊙ Brush shelters            |

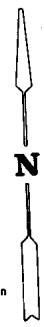

◆ Access ◆ Access with Parking ◆ Boat Livery

SPECIES OF FISH

Species	Winterkill		
	Abundant	Common	Present
Muskie			
N. Pike			
Walleye			
L. M. Bass	X		
S. M. Bass			
Panfish	X		

WATER AREA 78.0 ACRES

UNDER 3 FT. 11 %

OVER 20 FT. 0 %

MAX. DEPTH 14 FEET.

TOTAL ALK. 14 P.P.M.  
VOLUME 459.6 ACRE FT.  
SHORELINE 1.33 MILES