

STATE OF WISCONSIN
DEPARTMENT OF NATURAL RESOURCES

LAKE SURVEY MAP

LITTLE HORSESHOE LAKE
POLK COUNTY
SEC. 22 T. 34 N. R. 15 W.

Silver Lake
27.5 Acres
26 Ft. Deep

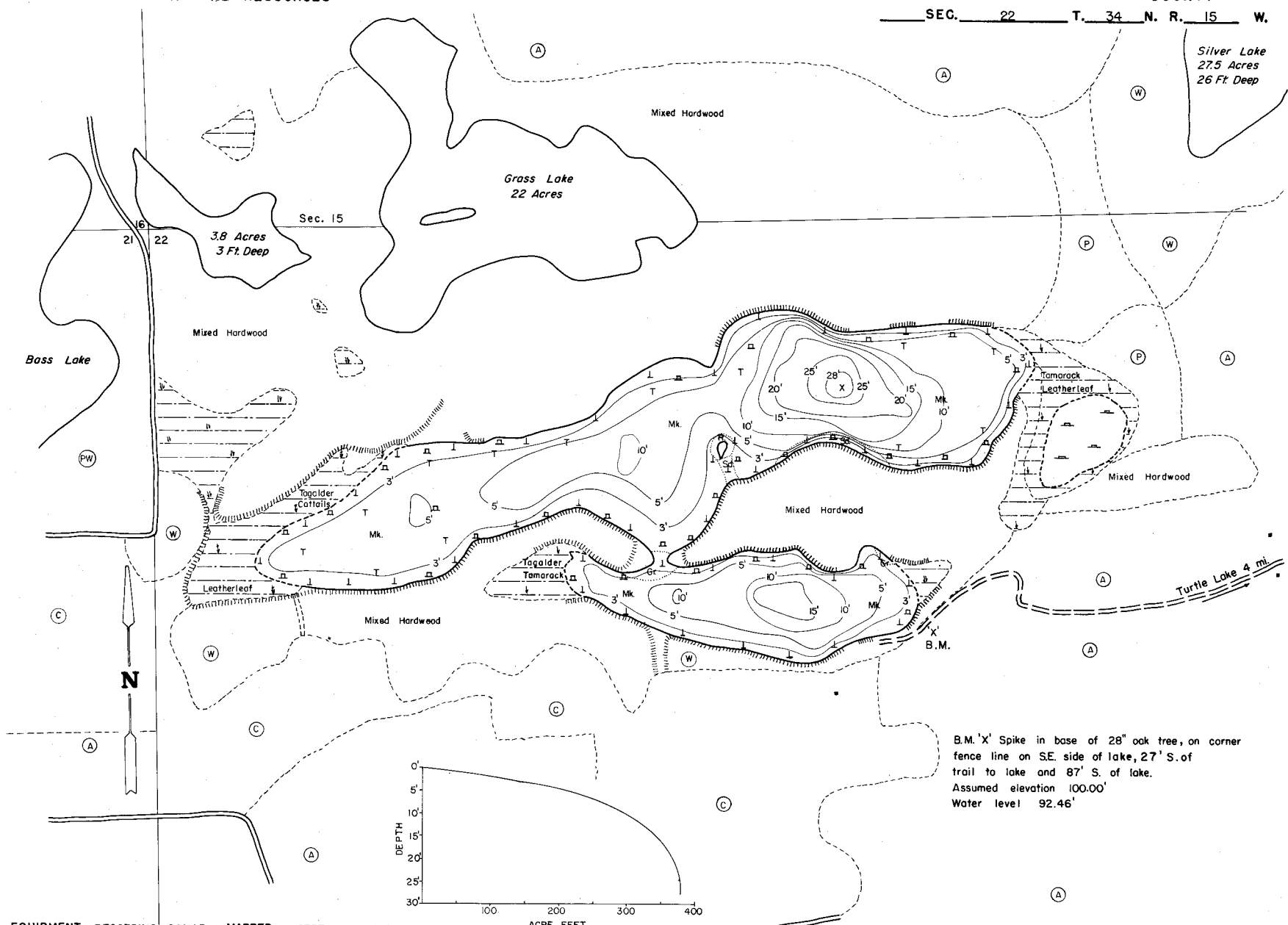

B.M. 'X' Spike in base of 28" oak tree, on corner fence line on SE. side of lake, 27' S. of trail to lake and 87' S. of lake.
Assumed elevation 100.00'
Water level 92.46'

EQUIPMENT RECORDING SONAR MAPPED SEPT 1969
MONTH YEAR
LAKE BOTTOM SYMBOLS

- | | | |
|--|---|--|
| <p>TOPOGRAPHIC SYMBOLS</p> <ul style="list-style-type: none"> (B) Brush (PW) Partially wooded (W) Wooded (C) Cleared (P) Pastured (A) Agricultural B.M. Bench Mark ■ Dwelling | <ul style="list-style-type: none"> (P) Peat Mk. Muck C. Clay M. Marl Sd. Sand St. Silt Gr. Gravel R. Rubble | <ul style="list-style-type: none"> B Boulders ☼ Stumps & Snags ⚡ Rock danger to navigation T Submergent vegetation ↓ Emergent vegetation ⬇ Floating vegetation ⬆ Brush shelters |
|--|---|--|



◆ Access ◆ Access with Parking ◆ Boat Livery
Drawn by: C. Halt

SPECIES OF FISH	Abundance		
	Abundant	Common	Present
Muskie			
N. Pike	X		
Walleye	X		
L.M. Bass	X		
S.M. Bass	X		
Panfish	X		

WATER AREA 53.9 ACRES
UNDER 3 FT. 21 %
OVER 20 FT. 6 %
MAX. DEPTH 28 FEET.
TOTAL ALK. 11 P.P.M.
VOLUME 3806 ACRE FT.
SHORELINE 220 MILES