

STATE OF WISCONSIN
DEPARTMENT OF NATURAL RESOURCES

LAKE SURVEY MAP

LITTLE CRAWLING STONE LAKE
VILAS COUNTY
SEC. 19, 20, 29, 30 T. 40 N. R. 5 E.

LAC DU FLAMBEAU INDIAN RESERVATION

Crawling Stone Lake
1466 Acres
87 Ft. Deep

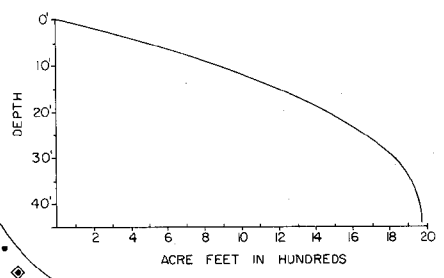
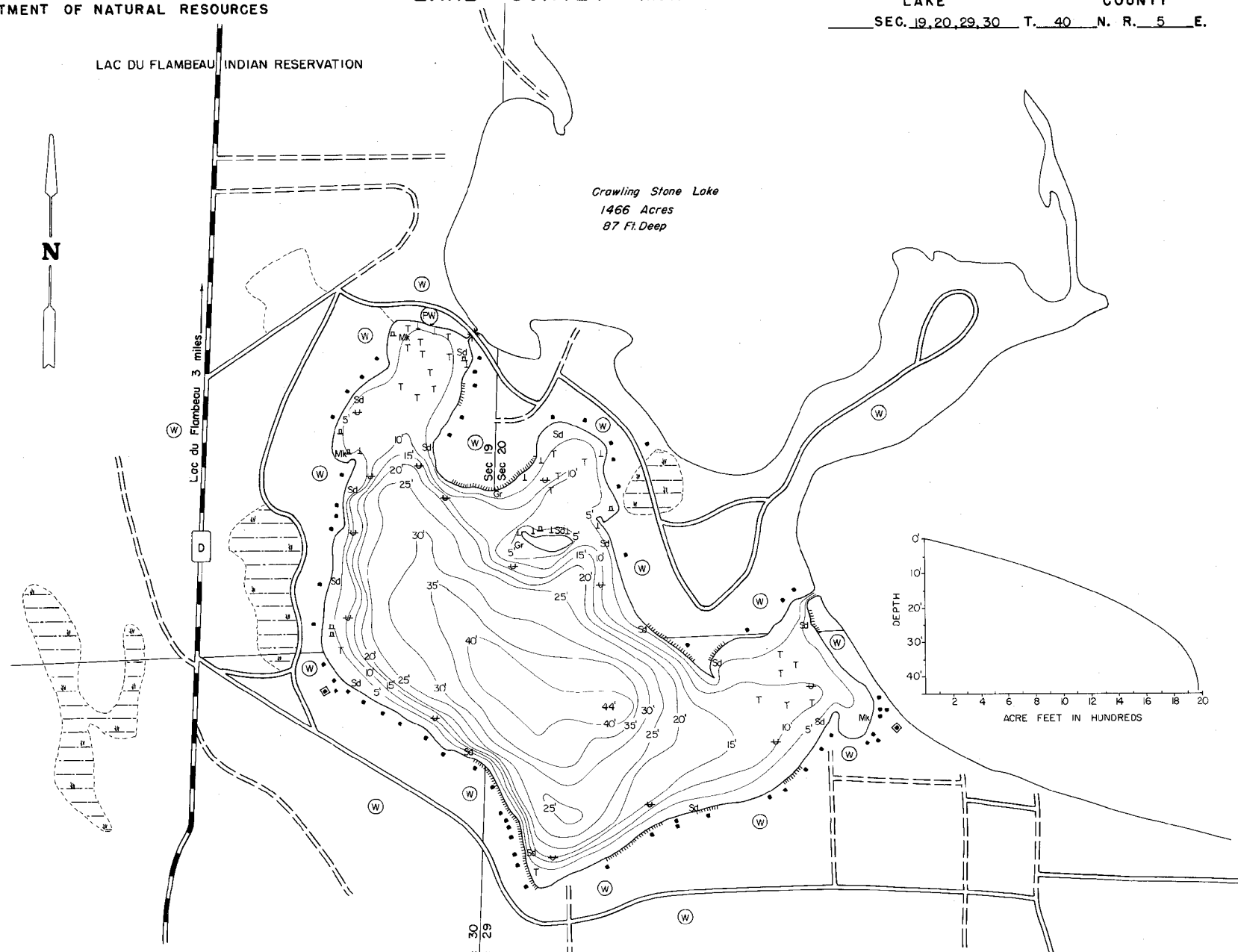
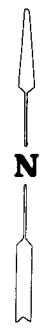

EQUIPMENT RECORDING SONAR MAPPED JUNE 1971

- | TOPOGRAPHIC SYMBOLS | | LAKE BOTTOM SYMBOLS | |
|-----------------------|----------------------|---------------------|---------------------------|
| (B) Brush | Steep slope | P. Peat | B Boulders |
| (PW) Partially wooded | Indefinite shoreline | Mk. Muck | Stumps & Snags |
| (W) Wooded | Marsh | C. Clay | Rock danger to navigation |
| (C) Cleared | Spring | M. Marl | T Submergent vegetation |
| (P) Pastured | Intermittent stream | Sd. Sand | Emergent vegetation |
| (A) Agricultural | Permanent inlet | St. Silt | Floating vegetation |
| B.M. Bench Mark | Permanent outlet | Gr. Gravel | Brush shelters |
| ■ Dwelling | Dam | R. Rubble | |



Access Access with Parking Boat Livery
Drawn by: C. Holt

SPECIES OF FISH	Abundant		Common		Present	
	X		X		X	
Muskie					X	
N. Pike					X	
Walleye					X	
L.M. Bass					X	
S.M. Bass					X	
Panfish					X	
Trout					X	

WATER AREA 106.9 ACRES
UNDER 3 FT. 10 %
OVER 20 FT. 44 %
MAX. DEPTH 44 FEET.
TOTAL ALK. 24 P.P.M.
VOLUME 1971 ACRE FT.
SHORELINE 23 MILES