

STATE OF WISCONSIN
DEPARTMENT OF NATURAL RESOURCES

LAKE SURVEY MAP

LITTLE ARBOR VITAE LAKE
VILAS COUNTY
SEC. 28,32,33,34 T. 40 N. R. 7 E.



Mielke Lake
23 Acres
52' Max. Depth

B.M. 'X' 1015 F. is a aluminum tablet stamped D.N.R.
set at public boat landing in a 6' concrete post 1' above
ground, 154' S.W. of S.T.H. 70, 103' S. of access
23' E. of shore on N.E. end of lake.
Assumed Elevation 100.00'
Water level 90.96'

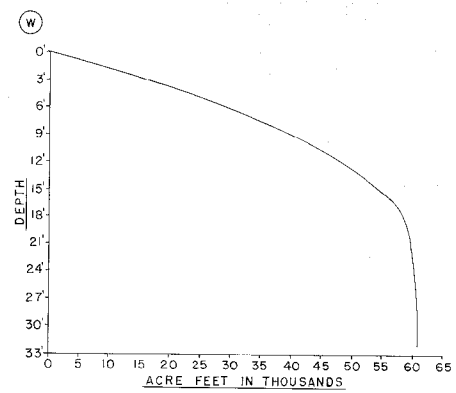
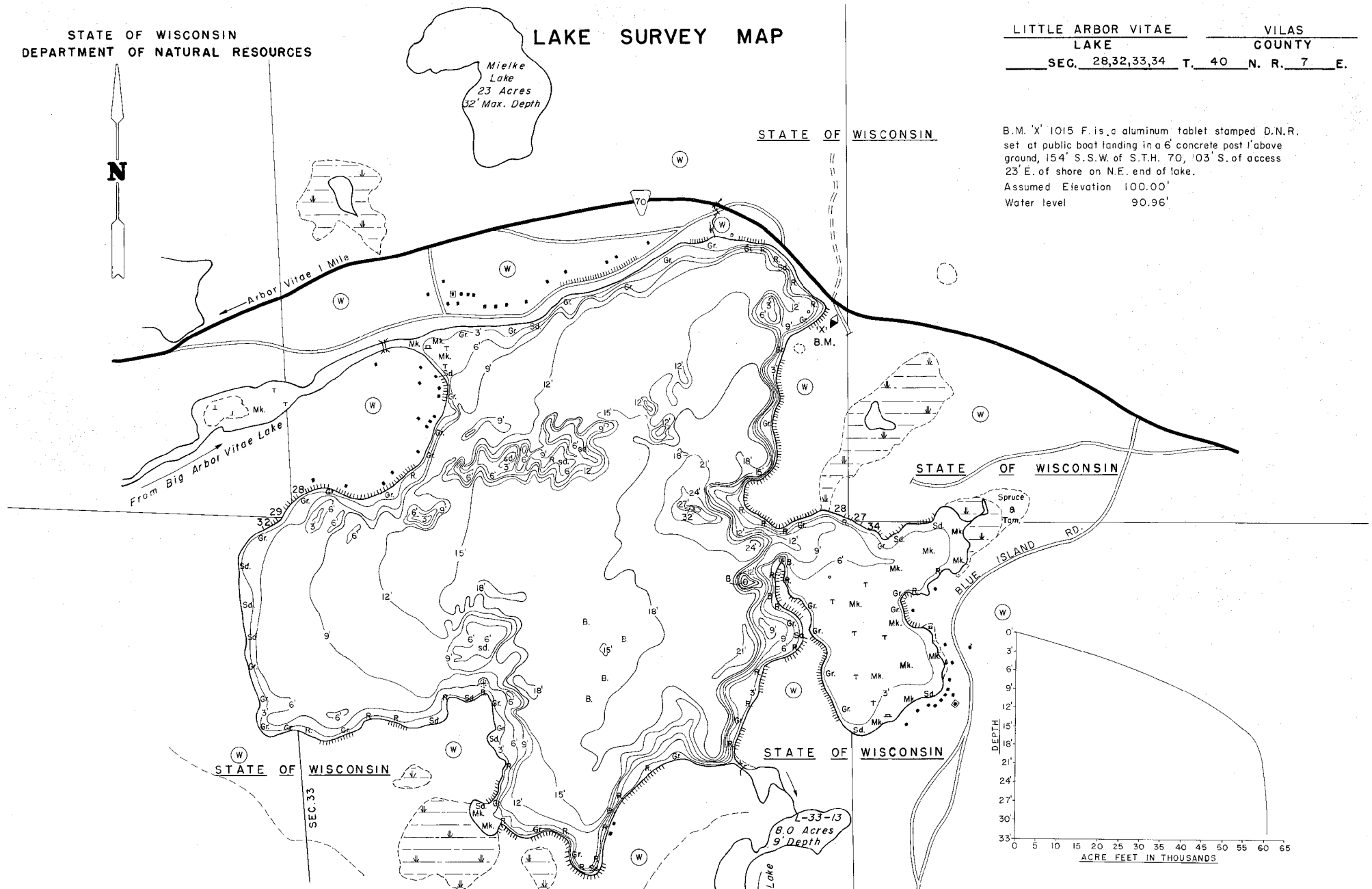

EQUIPMENT RECORDING SONAR MAPPED JUNE 1976
MONTH YEAR
LAKE BOTTOM SYMBOLS

- | | | | |
|-----------------------|--------------------------|------------|-----------------------------|
| (B) Brush | Steep slope | P. Peat | B Boulders |
| (PW) Partially wooded | --- Indefinite shoreline | Mk. Muck | ⊕ Stumps & Snags |
| (W) Wooded | ⊕ Marsh | C. Clay | ⚠ Rock danger to navigation |
| (C) Cleared | ⊕ Spring | M. Marl | T Submergent vegetation |
| (P) Pastured | --- Intermittent stream | Sd. Sand | ⊥ Emergent vegetation |
| (A) Agricultural | --- Permanent inlet | Sj. Silt | ⊕ Floating vegetation |
| B.M. Bench Mark | --- Permanent outlet | Gr. Gravel | ⊕ Brush shelters |
| ■ Dwelling | ⊕ Dam | R. Rubble | |
| ⊕ Resort | D.N.R. State owned land | Rc Redrock | |

600' 0' 600' 1200' 1800' 2400'
SCALE
◆ Access ◆ Access with Parking ◆ Boat Livery

SPECIES OF FISH	Abundance		
	Abundant	Common	Present
Muskie			X
N. Pike	X		
Walleye	X		
L.M. Bass			X
S.M. Bass			X
Panfish	X		

WATER AREA 534 ACRES
UNDER 3 FT. 10.3 %
OVER 20 FT. 6.1 %
MAX. DEPTH 32 FEET.
TOTAL ALK. 55 P.P.M.
VOLUME 6051.69 ACRE FT.
MAIN SHORELINE 7.1 MI.