

STATE OF WISCONSIN
DEPARTMENT OF NATURAL RESOURCES

LAKE SURVEY MAP

LEWIS LAKE SAWYER COUNTY
SEC. 25, 36 T. 42 N. R. 7 W.

B.M. 'X' D.N.R. 1362 - A Square cut in 4'x5' boulder 54' N of house, 65' W of water, on W. side of lake
Assumed elevation 10000'
Water level 95.34'

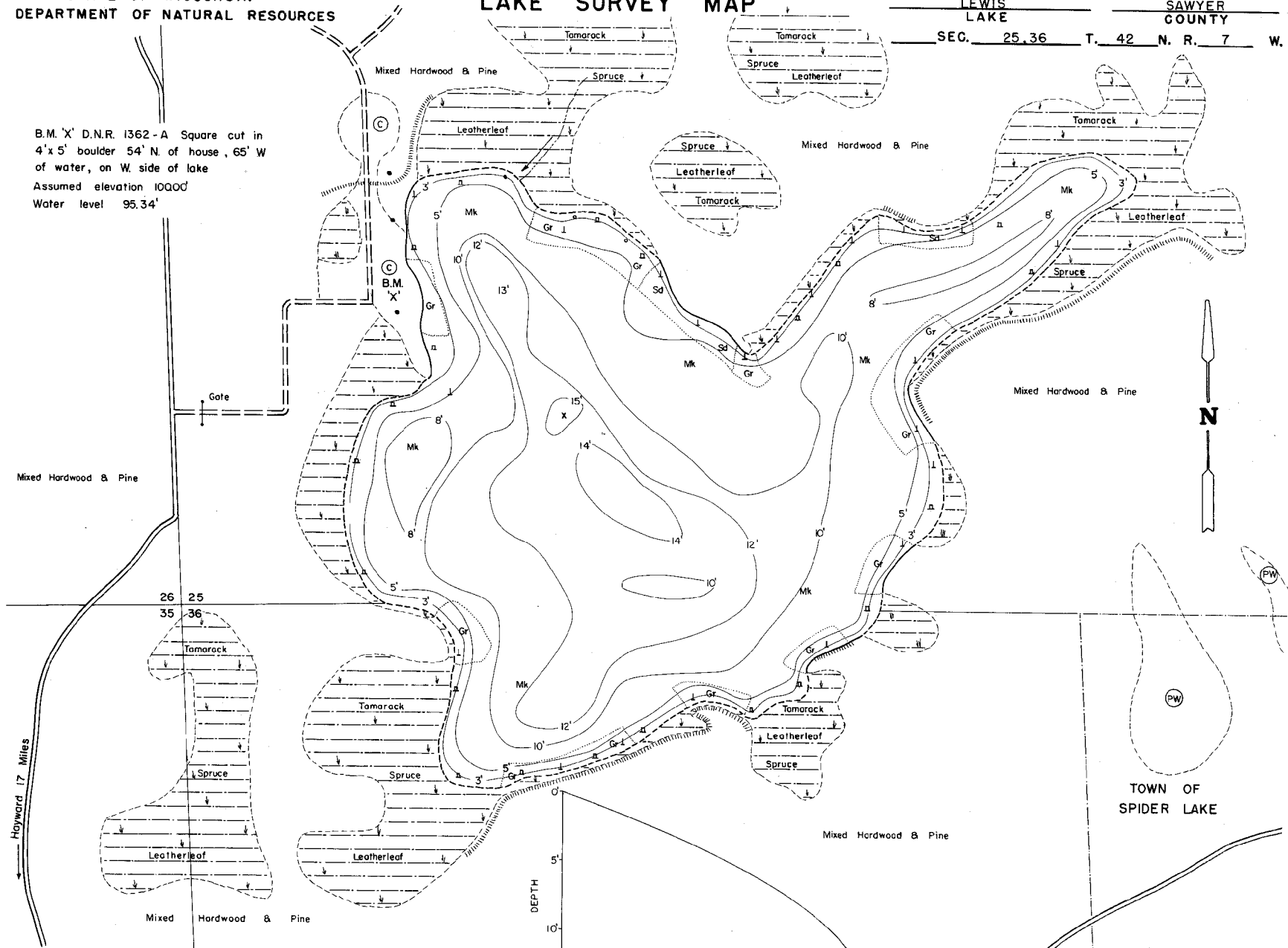

EQUIPMENT RECORDING SONAR MAPPED OCT 1972
MONTH YEAR

TOPOGRAPHIC SYMBOLS		LAKE BOTTOM SYMBOLS	
(B) Brush	Sleep slope	P. Peat	B Boulders
(PW) Partially wooded	- - - Indefinite shoreline	Mk. Muck	⚡ Stumps & Snags
(W) Wooded	▨ Marsh	C. Clay	⚠ Rock danger to navigation
(C) Cleared	⦿ Spring	M. Marl	T Submergent vegetation
(P) Pastured	~ Intermittent stream	Sd. Sand	⌋ Emerging vegetation
(A) Agricultural	▬ Permanent inlet	St. Silt	⌋ Floating vegetation
B.M. Bench Mark	▬ Permanent outlet	Gr. Gravel	⚡ Brush shelters
■ Dwelling	▬ Dam	R. Rubble	

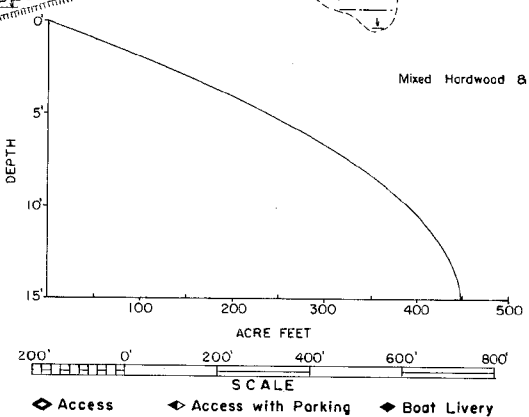

SPECIES OF FISH	ABUNDANCE		
	Abundant	Common	Present
Muskie			
N. Pike			
Walleye		X	
L.M. Boss		X	
S.M. Boss		X	

WATER AREA 51.7 ACRES
UNDER 3 FT. 7 %
OVER 20 FT. 0 %
MAX. DEPTH 15 FEET.
TOTAL ALK. 11 P.P.M.
VOLUME 449 ACRE FT.

TOWN OF SPIDER LAKE