

STATE OF WISCONSIN  
DEPARTMENT OF NATURAL RESOURCES

LAKE SURVEY MAP

WINTER LAKE SAWYER COUNTY  
SEC. 3, 4, 26, 27, 33, 34 T. 38, 39 N. R. 5 W.  
SHEET 2 OF 2

Sheet 1  
Sheet 2

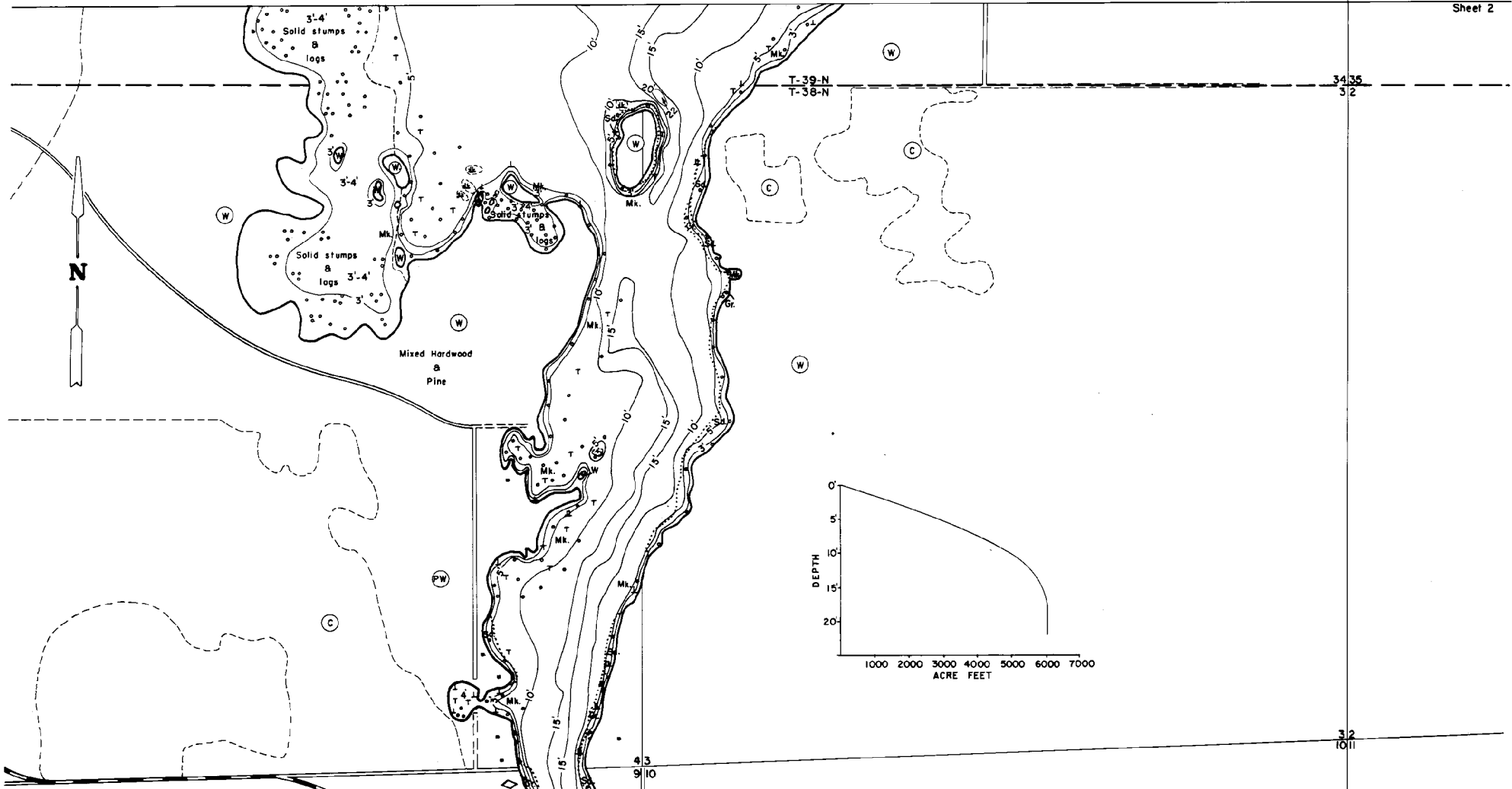

EQUIPMENT RECORDING SONAR MAPPED SEPT 1973  
MONTH YEAR  
LAKE BOTTOM SYMBOLS

- |   |  |   |
|---|--|---|
| <ul style="list-style-type: none"> <li>⊙ Brush</li> <li>⊙ Partially wooded</li> <li>⊙ Wooded</li> <li>⊙ Cleared</li> <li>⊙ Pastured</li> <li>⊙ Agricultural</li> <li>B.M. Bench Mark</li> <li>■ Dwelling</li> <li>■ Resort</li> </ul> | <ul style="list-style-type: none"> <li>      Steep slope</li> <li>— Indefinite shoreline</li> <li>Marsh</li> <li>Spring</li> <li>Intermittent stream</li> <li>Permanent inlet</li> <li>Permanent outlet</li> <li>Dam</li> <li>D.N.R. State owned land</li> </ul> | <ul style="list-style-type: none"> <li>P. Peat</li> <li>Mk. Muck</li> <li>C. Clay</li> <li>M. Marl</li> <li>Sd. Sand</li> <li>Sl. Silt</li> <li>Gr. Gravel</li> <li>R. Rubble</li> <li>R. Redcock</li> <li>B Boulders</li> <li>St Stumps &amp; Snags</li> <li>Rock danger to navigation</li> <li>T Submergent vegetation</li> <li>Emergent vegetation</li> <li>Floating vegetation</li> <li>Brush shelters</li> </ul> |
|---|--|---|

B.M.'X' 1068-B is a Bronze tablet stamped Public Service Commission of Wisconsin, set in the top of center downstream pier. Assumed elevation = 104.03 Water level = 101.61'

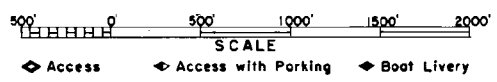

SPECIES OF FISH	Abundance		
	Common	Present	Present
Muskie	X		
N. Pike	X		
Walleye	X		
L. M. Bass	X		
S. M. Bass	X		
Panfish	X		

WATER AREA 676.1 ACRES  
UNDER 3 FT. 17 %  
OVER 20 FT. .03 %  
MAX. DEPTH 22 FEET.  
TOTAL ALK. 52 P.P.M.  
VOLUME 6023.6 ACRE FT.  
MAIN SHORELINE 10.42 MI.