

STATE OF WISCONSIN
DEPARTMENT OF NATURAL RESOURCES

LAKE SURVEY MAP

WAUSAU MARATHON
LAKE COUNTY
SEC. AS SHOWN T. 28, 29 N. R. 7 E.
SHEET 1 OF 6

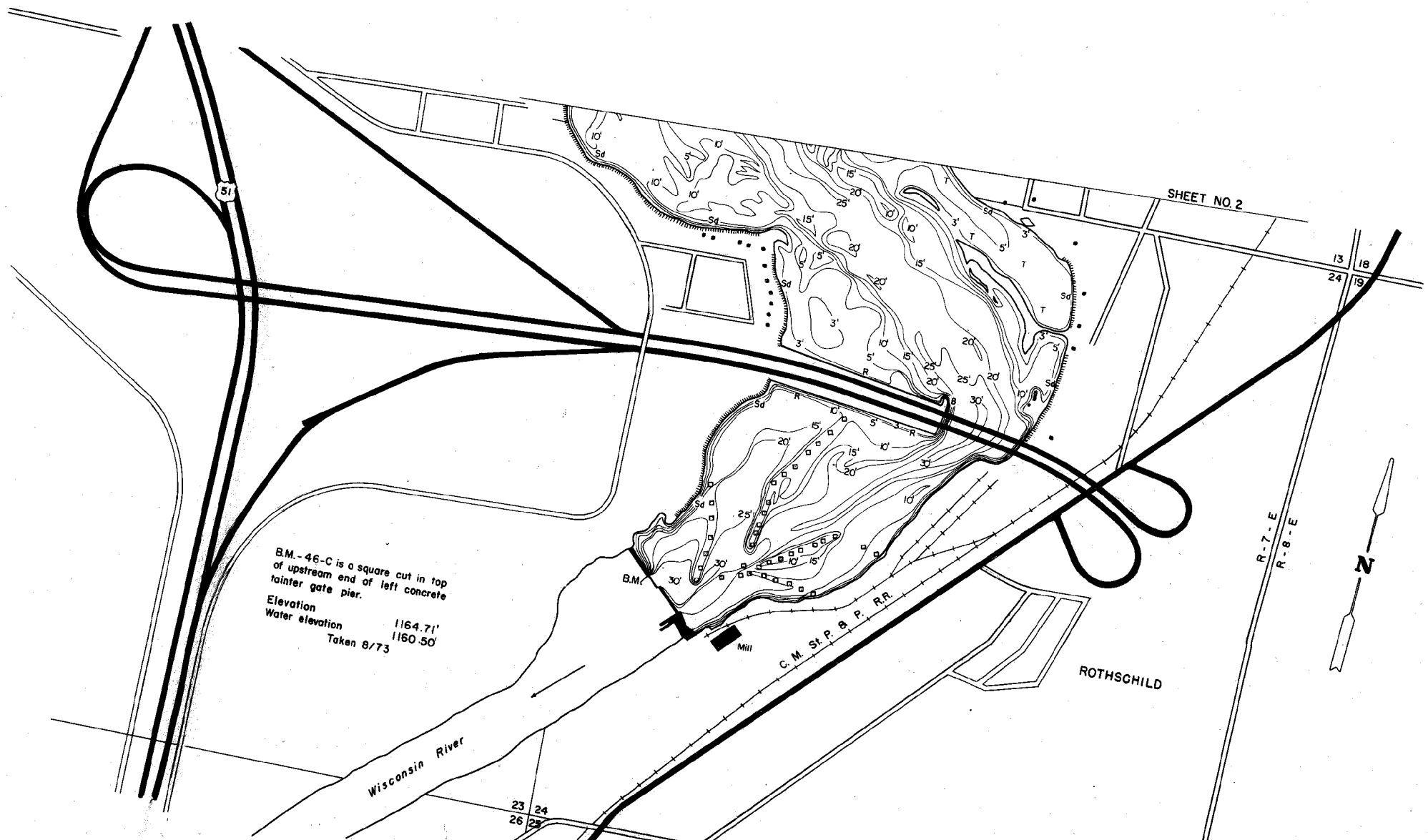

- EQUIPMENT RECORDING SONAR MAPPED OCT. 1973
- | TOPOGRAPHIC SYMBOLS | | LAKE BOTTOM SYMBOLS | |
|-----------------------|-------------------------|---------------------|-----------------------------|
| (B) Brush | Steep slope | P. Peat | B Boulders |
| (PW) Partially wooded | — Indefinite shoreline | Mk. Muck | ⌘ Stumps & Snags |
| (W) Wooded | Marsh | C. Clay | ⊛ Rock danger to navigation |
| (C) Cleared | Spring | M. Marl | T Submergent vegetation |
| (P) Pastured | Intermittent stream | Sd. Sand | ⊥ Emergent vegetation |
| (A) Agricultural | Permanent inlet | St. Silt | ⊥ Floating vegetation |
| B.M. Bench Mark | Permanent outlet | Gr. Gravel | ⊥ Brush shelters |
| ■ Dwelling | Dam | R. Rubble | |
| □ Resort | D.N.R. State owned land | Bc. Bedrock | |

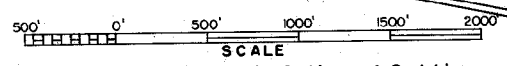

Drawn by: C. Holt

SPECIES OF FISH	ABUNDANCE		
	Abundant	Common	Present
Mustie			X
N. Pike		X	
Walleye		X	
L. M. Bass		X	
S. M. Bass		X	
Panfish		X	
Trout			X

WATER AREA 1918.0 ACRES

UNDER 3 FT. 23 %
OVER 20 FT. 8 %

MAX. DEPTH 30 FEET

TOTAL ALK. 34 P.P.M

VOLUME 13,916 ACRE FT.

MAIN SHORELINE 30.58 MI.

ISLAND SHORELINE 43.32 MI.