

STATE OF WISCONSIN  
DEPARTMENT OF NATURAL RESOURCES

LAKE SURVEY MAP

THIRTY LAKE BARRON COUNTY  
SEC. 19.30 T. 36 N. R. 12 W.

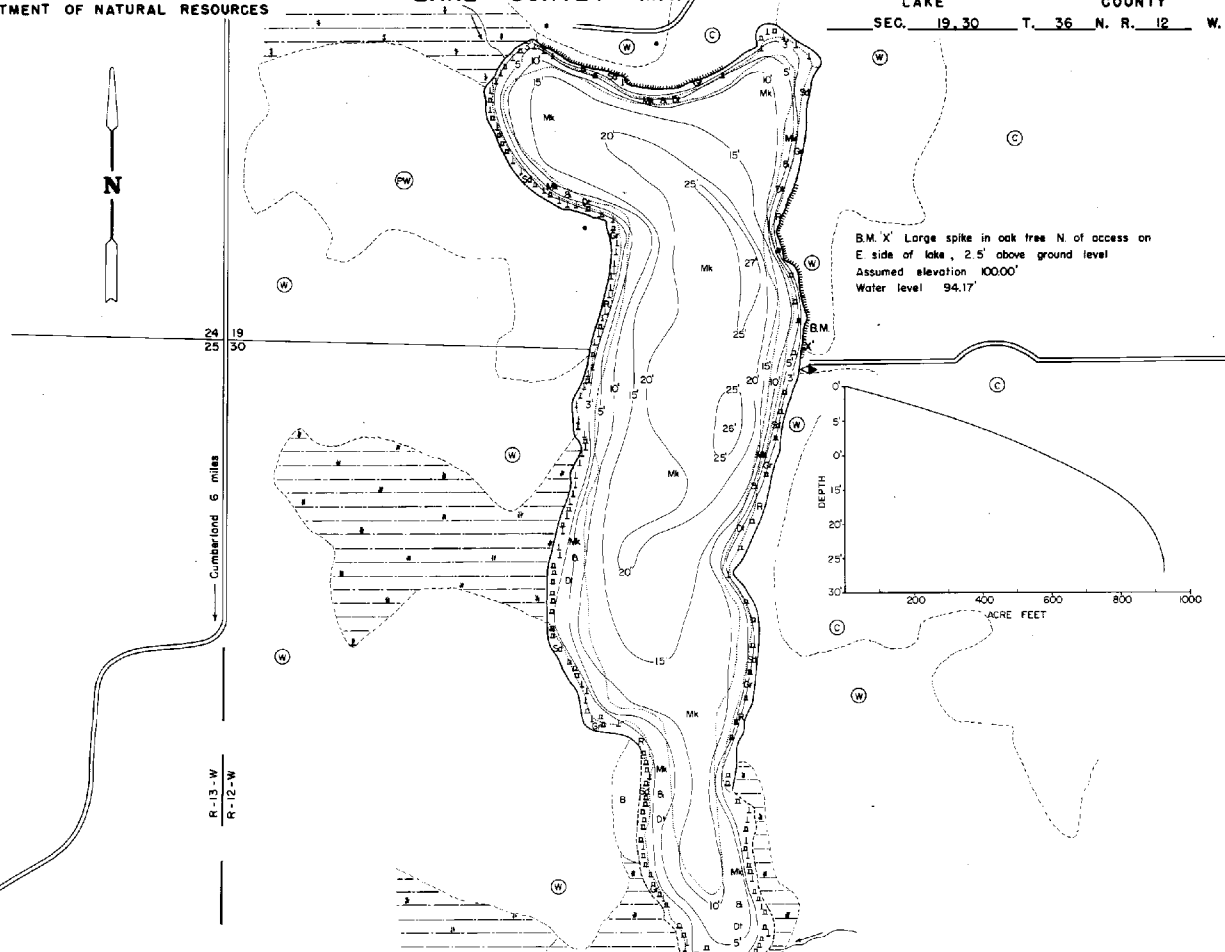

B.M. X' Large spike in oak tree N. of access on E side of lake, 2.5' above ground level  
Assumed elevation 100.00'  
Water level 94.17'

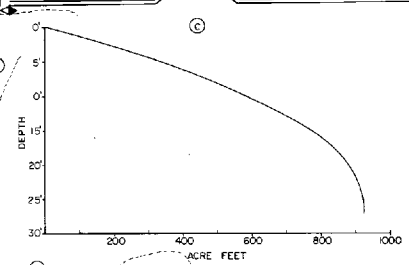

EQUIPMENT	SONAR & POLE	MAPPED	MONTH	YEAR
TOPOGRAPHIC SYMBOLS			JULY	1972
Brash			LAKE BOTTOM SYMBOLS	
Partially wooded			P. Peat	B. Boulders
Wooded			Mk. Muck	Rock danger to navigation
Cleared			C. Clay	Submergent vegetation
Pastured			M. Marl	Emergent vegetation
Agricultural			Sd. Sand	Floating vegetation
B.M. Bench Mark			St. Silt	Brush shelters
Dwelling			G. Gravel	
Resort			R. Rubble	
Camp			Bc. Bedrock	
			Dl. Debris	

300' 0' 300' 600' 900' 1200'  
SCALE  
Access Access with Parking Boat Livery  
Drawn by: C. Holt  
Field work by: M. Clark

SPECIES OF FISH	ABUNDANT	PRESENT
Muskie		
N. Pike	X	
Walleye		
L.M. Bass	X	
S.M. Bass		
Panfish	X	
Trout		

WATER AREA 73.5 ACRES  
UNDER 3 FT. 13 %  
OVER 20 FT. 18 %  
MAX. DEPTH 27 FEET.  
TOTAL ALK. 10 P.P.M.  
VOLUME 924 ACRE FT.  
SHORELINE 2.03 MILES

Maps are not for navigation  
Source-Wisconsin Department of Natural Resources  
Hunt Fish Camp Wisconsin .Com 2005