

STATE OF WISCONSIN
DEPARTMENT OF NATURAL RESOURCES

LAKE SURVEY MAP

SIXTEEN LAKE PRICE COUNTY
SEC. 16 T. 36 N. R. 1 W.

B.M. 'X' White circle on top of E. culvert
N. of County Trunk Highway 'J' at the
lake outlet.
Assumed elevation 100.00'
Water elevation 100.80'

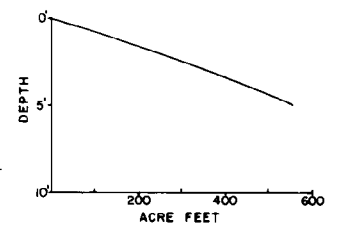
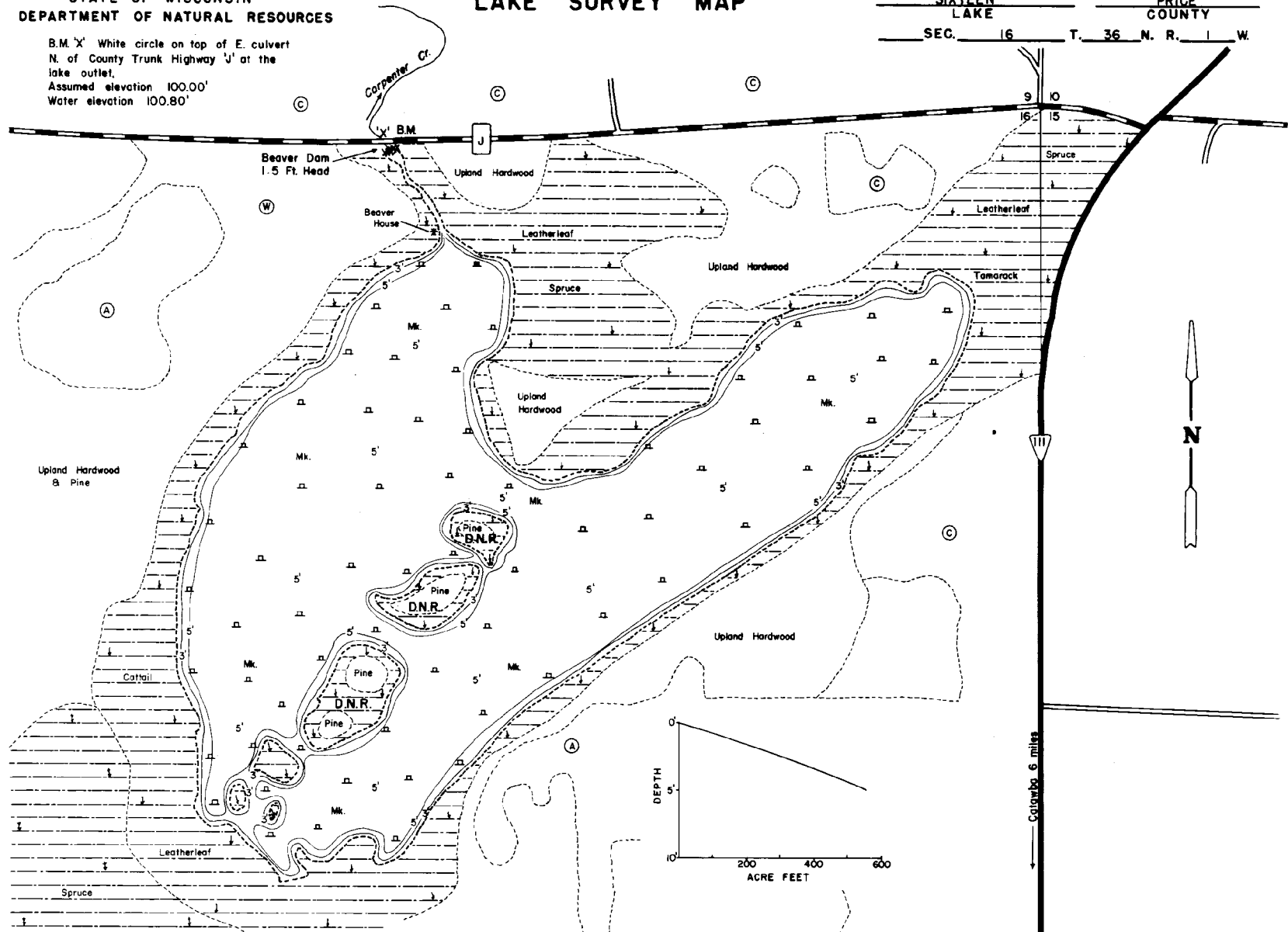

EQUIPMENT RECORDING SONAR MAPPED SEPT 1968
MONTH YEAR

- | TOPOGRAPHIC SYMBOLS | | LAKE BOTTOM SYMBOLS | |
|----------------------|-------------------------------|---------------------|-------------------------------|
| (B) Brush | () Steep slope | P. Peat | B. Boulders |
| (W) Partially wooded | (---) Indefinite shoreline | Mk. Muck | S. Stumps & Snags |
| (W) Wooded | (---) Marsh | C. Clay | (X) Rock danger to navigation |
| (C) Cleared | (---) Spring | M. Marl | (T) Submergent vegetation |
| (P) Pastured | (---) Intermittent stream | Sd. Sand | (I) Emergent vegetation |
| (A) Agricultural | (---) Permanent inlet | Sl. Silt | (F) Floating vegetation |
| B.M. Bench Mark | (---) Permanent outlet | Gr. Gravel | (B) Brush shelters |
| (D) Dwelling | (---) Dam | R. Rubble | |
| (R) Resort | (---) D.N.R. State owned land | Bc. Bedrock | |



Access Access with Parking Boat Livery

Drawn by: C. Hall
Field work by: C. Busch, C. Olson, I. Sether

SPECIES OF FISH	Abundance		
	Abundant	Common	Present
Muskie			
N. Pike			
Walleye			
L. M. Bass			
S. M. Bass			
Panfish			
Trout			
Y.			

WATER AREA 119.3 ACRES
UNDER 3 FT. 5 %
OVER 20 FT. 0 %
MAX. DEPTH 5 FEET.
TOTAL ALK. 9 P.P.M.
VOLUME 5572 ACRE FT.
SHORELINE 2.4 MILES
SHORELINE 3.2 MILES WITH IS.