

STATE OF WISCONSIN
DEPARTMENT OF NATURAL RESOURCES

LAKE SURVEY MAP

LAKE OF THE FALLS IRON
LAKE COUNTY
SEC. 31.6 T.-42,43-N. R.-3-E. 31

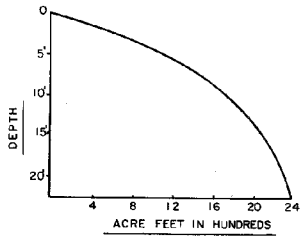
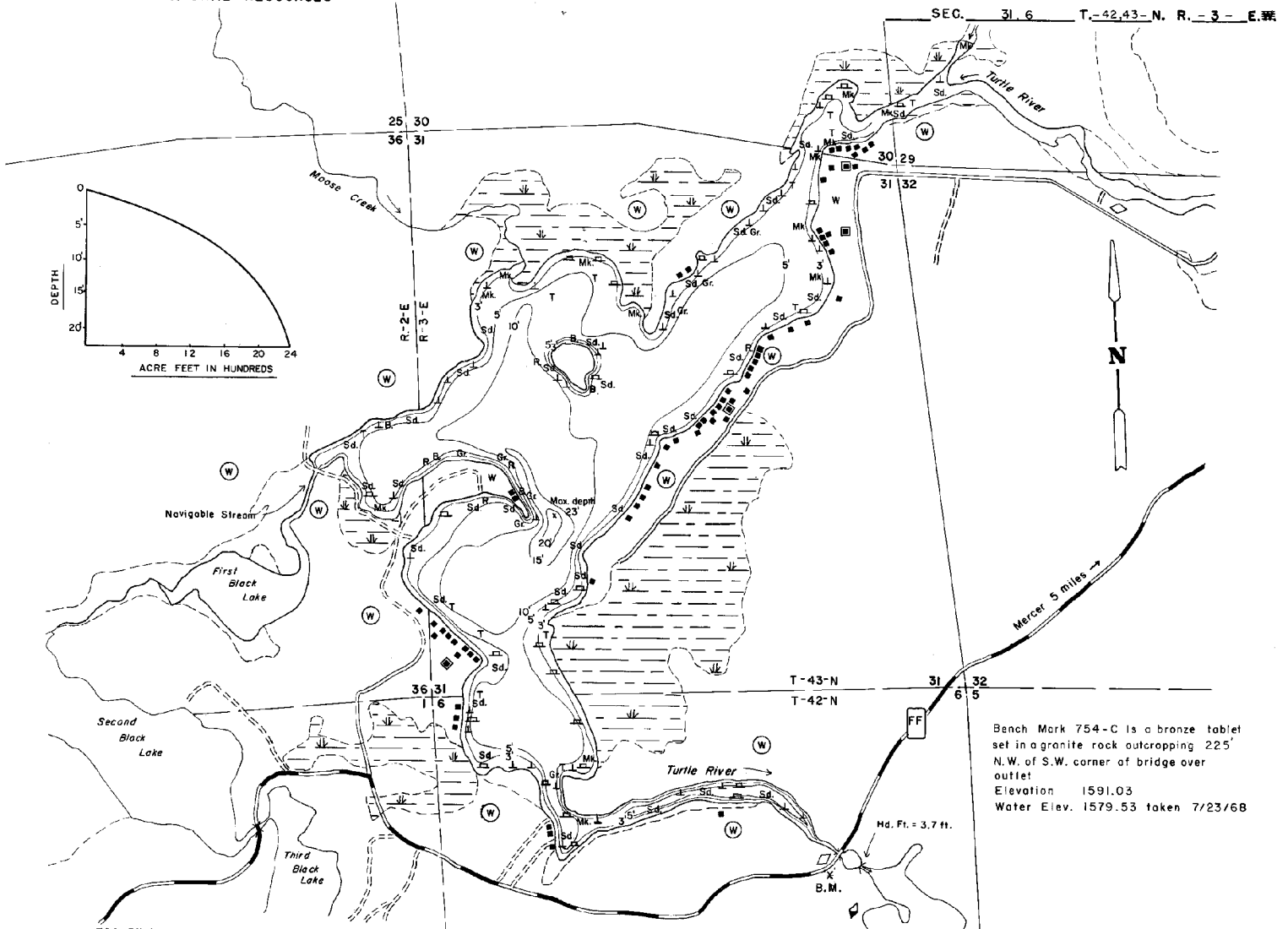

Bench Mark 754-C is a bronze tablet set in a granite rock outcropping 225' N.W. of S.W. corner of bridge over outlet
Elevation 1591.03
Water Elev. 1579.53 taken 7/23/68

EQUIPMENT RECORDING	SONAR MAPPED	JULY 1968	LAKE BOTTOM SYMBOLS
MONTH	YEAR	MONTH	YEAR
(B) Brush	Steep slope	P. Peat	B Boulders
(PW) Partially wooded	----- Indefinite shoreline	Mk Muck	* Stumps & Snags
(W) Wooded	----- Marsh	C. Clay	⊗ Rock danger to navigation
(C) Cleared	----- Spring	M. Marl	T Submergent vegetation
(P) Pastured	----- Intermittent stream	Sd. Sand	⊥ Emergent vegetation
(A) Agricultural	----- Permanent inlet	Sl. Silt	⊥ Floating vegetation
B.M. Bench Mark	----- Permanent outlet	Gr. Gravel	⊥ Brush shelters
■ Dwelling	----- Dam	R. Rubble	
□ Resort	----- D.N.R. State owned land	Bc Bedrock	
□ Camp			

700 0 700' 1400' 2100' 2800'
SCALE
◆ Access ◆ Access with Parking ◆ Boat Livery
Drawn by: T. Ginder
Field work by: J. Smith, P. Michelson

SPECIES OF FISH	Abundance		
	Common	Present	Present
Muskie	X		
N. Pike	X		
Walleye	X		
L. M. Bass	X		
S. W. Bass	X		
Panfish	X		
Trout			

WATER AREA 338.4 ACRES
UNDER 3 FT. 12 %
OVER 20 FT. 25 %
MAX. DEPTH 23 FEET.
TOTAL ALK. 31 P.P.M.
VOLUME 2341.70 ACRE FT.
SHORELINE 6.7 MILES

Maps are not for navigation
Source-Wisconsin Department of Natural Resources
Hunt Fish Camp Wisconsin .Com 2005