

WISCONSIN CONSERVATION DEPARTMENT

LAKE SURVEY MAP

LAKE LAKE LORRAINE
SECTION 9
TOWNSHIP 3-N
RANGE 15-E
TOWN RICHMOND
COUNTY WALWORTH

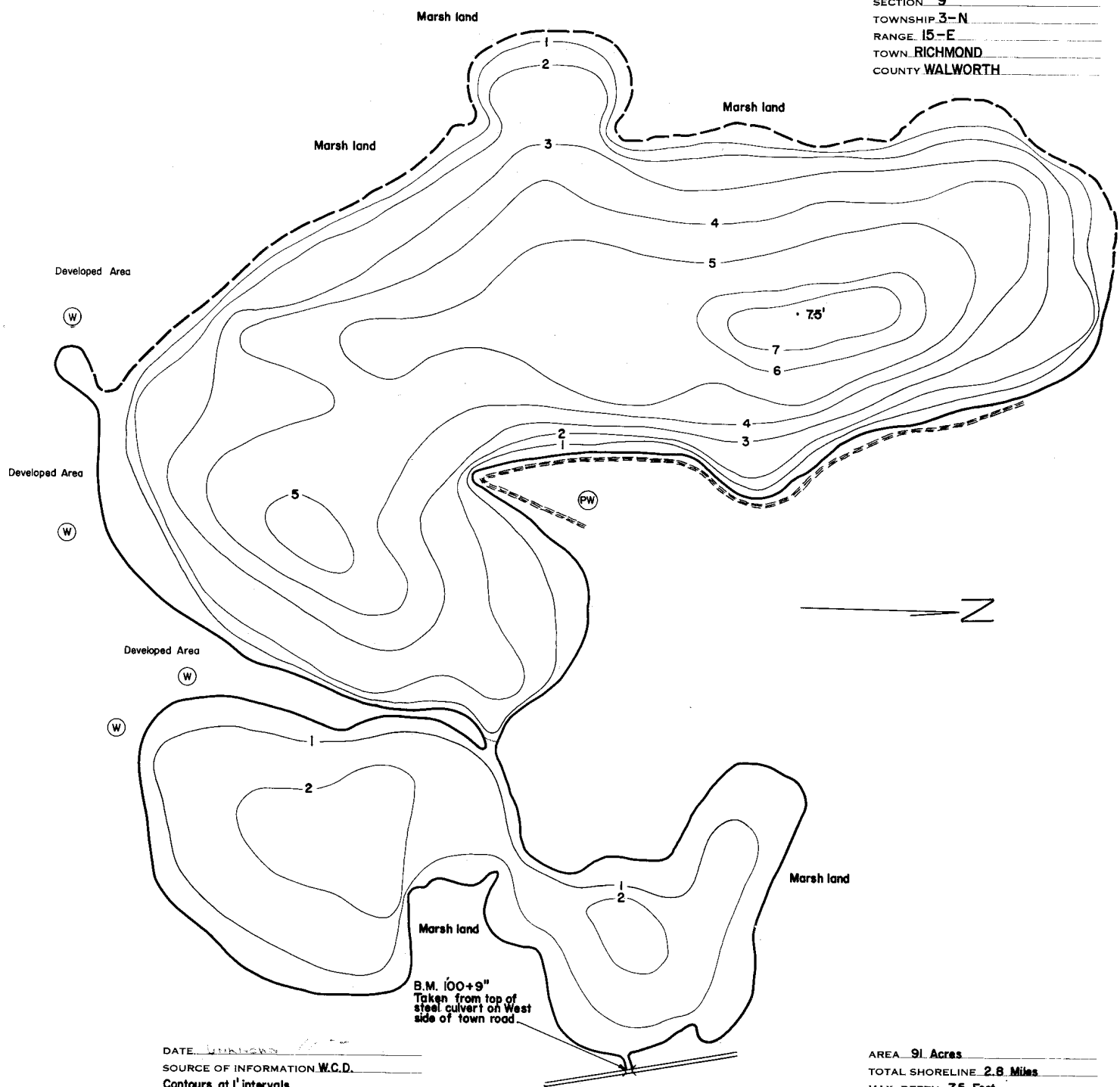

DATE 10/15/05
SOURCE OF INFORMATION W.C.D.
Contours at 1' intervals

AREA 91 Acres
TOTAL SHORELINE 2.8 Miles
MAX. DEPTH 7.5 Feet