

STATE OF WISCONSIN
DEPARTMENT OF NATURAL RESOURCES

LAKE SURVEY MAP

LAKE BELLEVUE LAKE
DANE COUNTY
SEC. 33, 34 T. - 5- N. R. - 8- E.W.

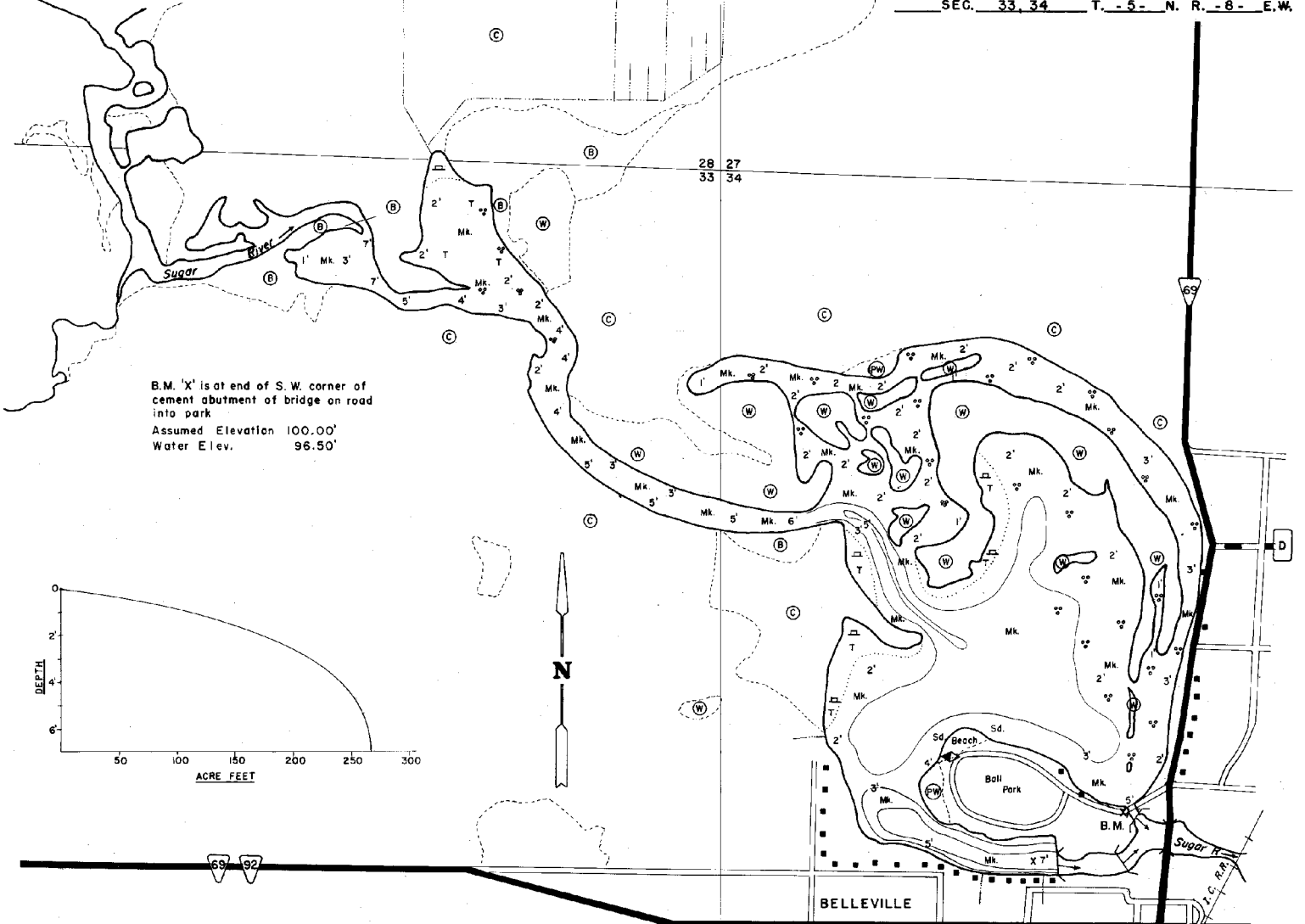

B.M. 'X' is at end of S.W. corner of cement abutment of bridge on road into park
Assumed Elevation 100.00'
Water Elev. 96.50'

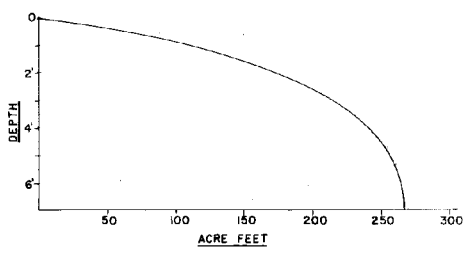

EQUIPMENT	RANGE POLE	MAPPED	JULY 1970	1970
TOPOGRAPHIC SYMBOLS		MONTH	LAKE BOTTOM	YEAR
(B) Brush	Steep slope	P. Peat	B Boulders	Stumps & Snags
(Pw) Partially wooded	~ Indefinite shoreline	Mk. Muck	⚠ Rock danger to navigation	
(W) Wooded	Marsh	C. Clay	T Submergent vegetation	
(C) Cleared	Spring	M. Marl	↑ Emergent vegetation	
(P) Pastured	Intermittent stream	Sd. Sand	↓ Floating vegetation	
(A) Agricultural	Permanent inlet	Sl. Silt	⌘ Brush shelters	
B.M. Bench Mark	Permanent outlet	Gc. Gravel		
■ Dwelling	⌘ Dam	R. Rubble		
□ Resort	D.N.R. State owned land	Bc. Bedrock		
⊠ Camp				

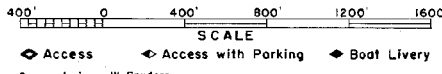

Drawn by: W. Snyders
Field work by: M. J. Gappo, J. Bakken

SPECIES OF FISH	Abundance	
	Number	Percent
Muskie		
N. Pike	X	
Walleye		
L.M. Bass	X	
S.M. Bass		
Panfish	X	
Trout		

WATER AREA 111.6 ACRES
UNDER 3 FT. 68 %
OVER 20 FT. 0 %
MAX. DEPTH 7 FEET.
TOTAL ALK. 252 P.P.M.
VOLUME 268.7 ACRE FT.
SHORELINE 4.3 MILES
" WITH ISL. 7.1 MILES

Maps are not for navigation
Source-Wisconsin Department of Natural Resources
Hunt Fish Camp Wisconsin .Com 2005