

LAKE SURVEY MAP

WISCONSIN CONSERVATION DEPARTMENT
BIOLOGY DIVISION
LAKE AND STREAM IMPROVEMENT SECTION

LAKE JORDON
SECTION 26-27-34-35
TOWNSHIP 14 N
RANGE 7 E
TOWN OF JACKSON
COUNTY ADAMS

FORM FI-117

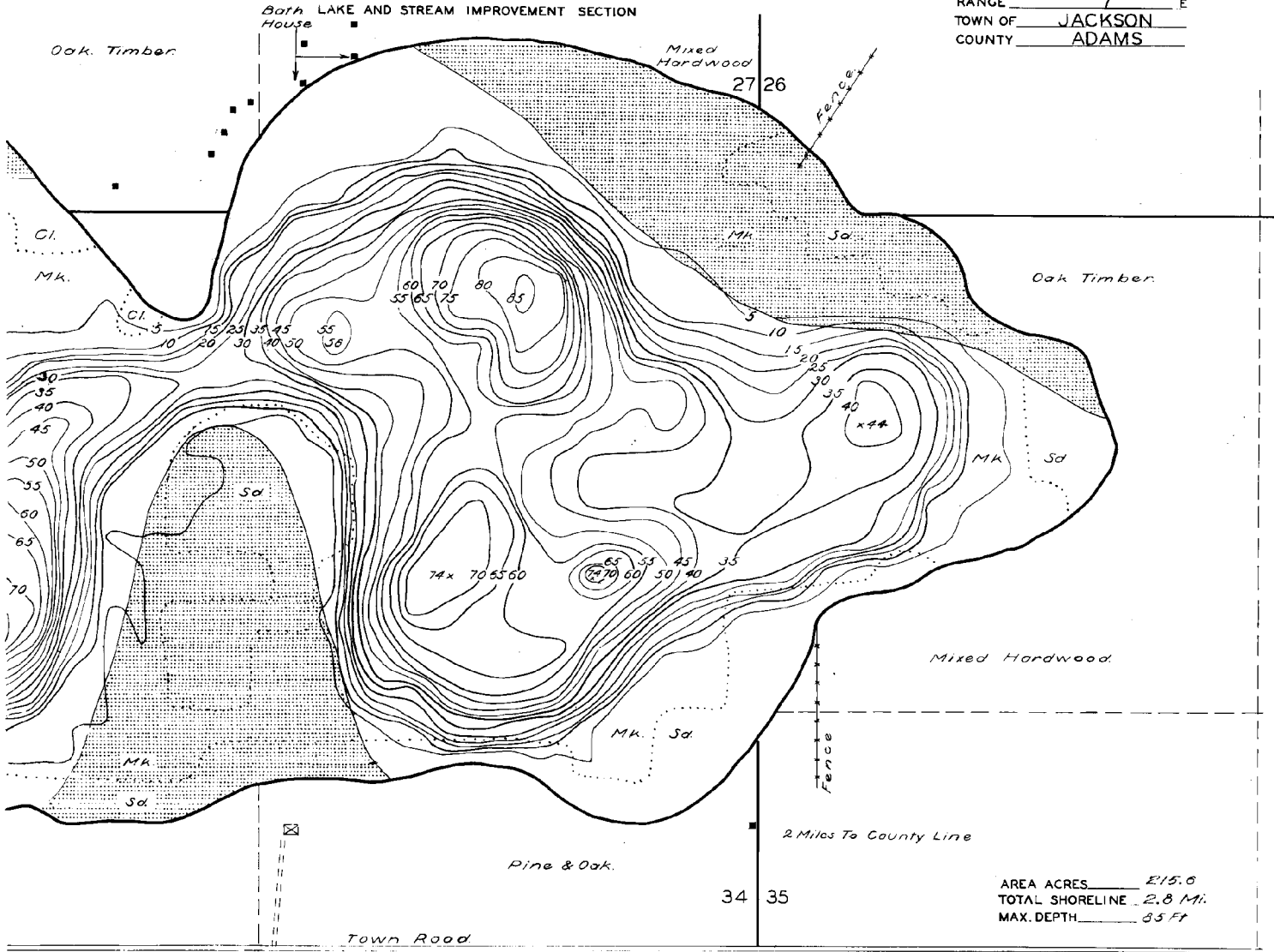

AREA ACRES 215.6
TOTAL SHORELINE 2.8 MI.
MAX. DEPTH 35 FT

DATE May 20 1941
COMPILED BY _____
TRACED BY W. L. M. (W.P.A.)
SOURCE OF INFORMATION
W.P.A. Lake Survey Project
SOUNDINGS At 100 Ft Intervals
DATES OF MAP REVISION _____
WORK AGENCY W. P.A.

LAKE IMPROVEMENT RECORD	
TYPE	DATE
◇ BRUSH REFUGES	<u>28</u>
✱ SAPLING TANGLES	<u>161</u>
□ SPAWNING BOXES	<u>38</u>
* MINNOW SPAWNERS	<u>59</u>
TOTAL	<u>306</u>

Lake Improvement From Arrow To Arrow

SCALE 1 inch Equals 200 Ft.
0 100 200 300 400 500 600

- LEGEND
- ☉ WEED BEDS
 - ☼ ROCKY SHOALS
 - Sd SAND
 - Cl CLAY
 - Gr GRAVEL
 - M MUCK
 - DWELLING
 - ABANDONED DWELLING
 - RESORT
 - ▣ FARM

Maps are not for navigation
Source-Wisconsin Department of Natural Resources
Hunt Fish Camp Wisconsin .Com 2005