

STATE OF WISCONSIN
DEPARTMENT OF NATURAL RESOURCES

LAKE SURVEY MAP

IKE WALTON LAKE
VILAS COUNTY
SEC. 7, 12, 13, 18, 19, 24 T. 41 N. R. 5, 6 E.
SHEET 1 of 2

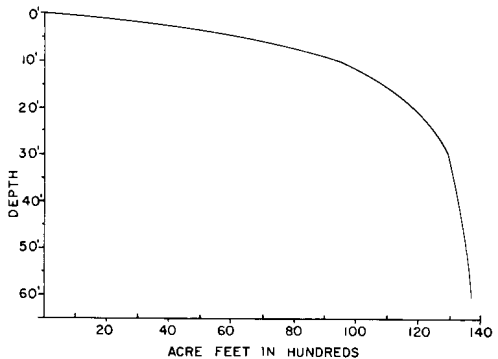
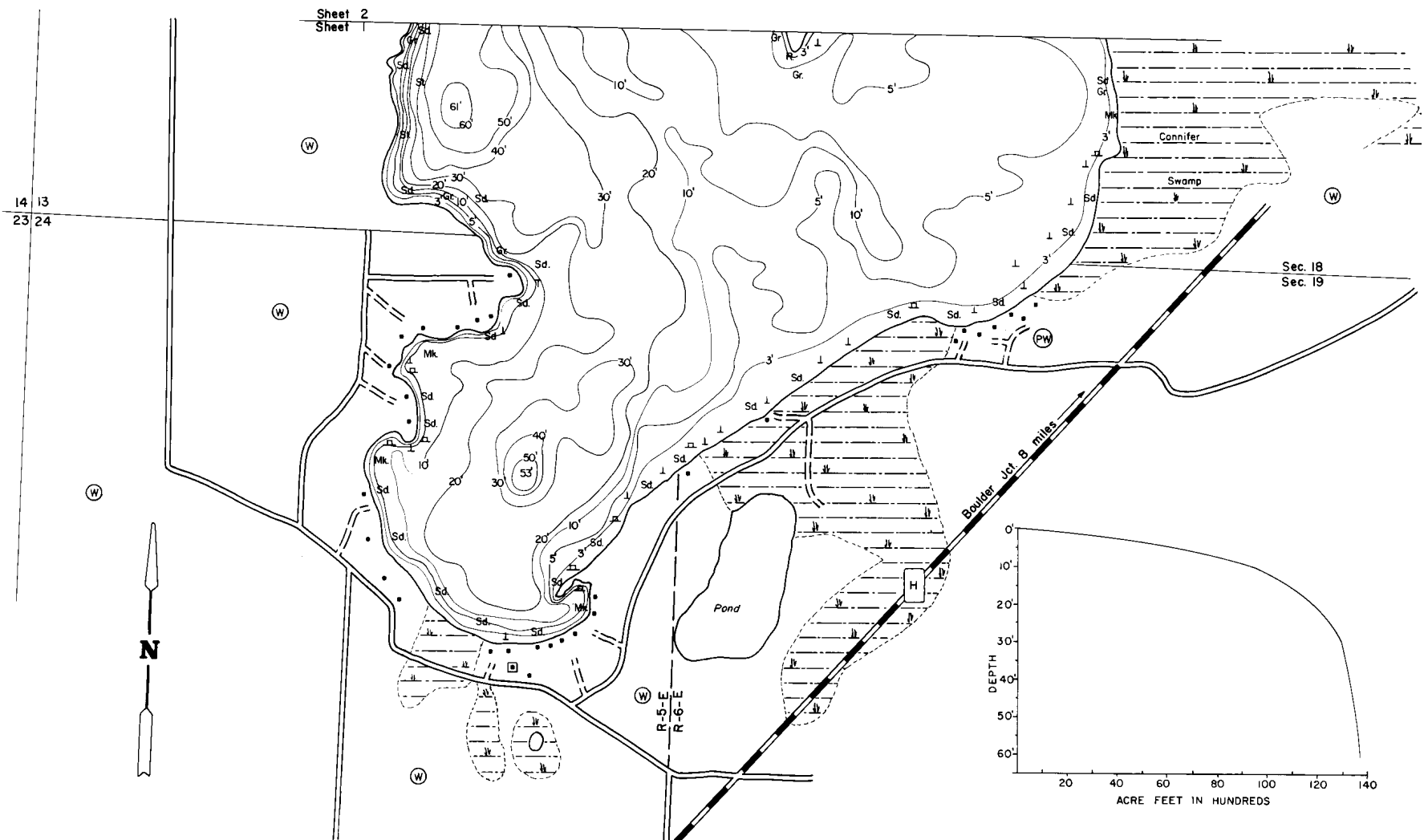

EQUIPMENT RECORDING SONAR MAPPED MONTH YEAR
JULY 1967

- | TOPOGRAPHIC SYMBOLS | | LAKE BOTTOM SYMBOLS | |
|---------------------|----------------------------|---------------------|---------------------------|
| (B) Brush | Steep slope | P. Peat | B Boulders |
| (PW) Partly wooded | - - - Indefinite shoreline | Mk. Muck | Stumps & Snags |
| (W) Wooded | Marsh | C. Clay | Rock danger to navigation |
| (C) Cleared | Spring | M. Marl | T Submergent vegetation |
| (P) Pastured | Intermittent stream | Sd. Sand | Emergent vegetation |
| (A) Agricultural | Permanent inlet | St. Silt | Floating vegetation |
| B.M. Bench Mark | Permanent outlet | Gr. Gravel | Brush shelters |
| ■ Dwelling | Dam | R. Rubble | |

ALL SURROUNDING PROPERTY OWNED BY LAC DU FLAMBEAU INDIAN RESERVATION



Access Access with Parking Boat Livery
Drawn by: C. Halt

SPECIES OF FISH	Abundance		
	Abundant	Common	Present
Muskie			X
N. Pike			X
Walleye		X	
L. M. Bass		X	
S. M. Bass		X	
Panfish		X	

WATER AREA 1423.5 ACRES
UNDER 3 FT. 4 %
OVER 20 FT. 11 %
MAX. DEPTH 61 FEET.
TOTAL ALK. 20 P.P.M.
VOLUME 13,658.3 ACRE FT.
SHORELINE 984 MILES