

STATE OF WISCONSIN
DEPARTMENT OF NATURAL RESOURCES

LAKE SURVEY MAP

HOWELL LAKE FOREST COUNTY
SEC. 13 T.-40-N. R.-12-E.

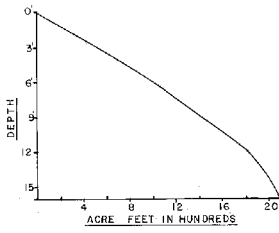
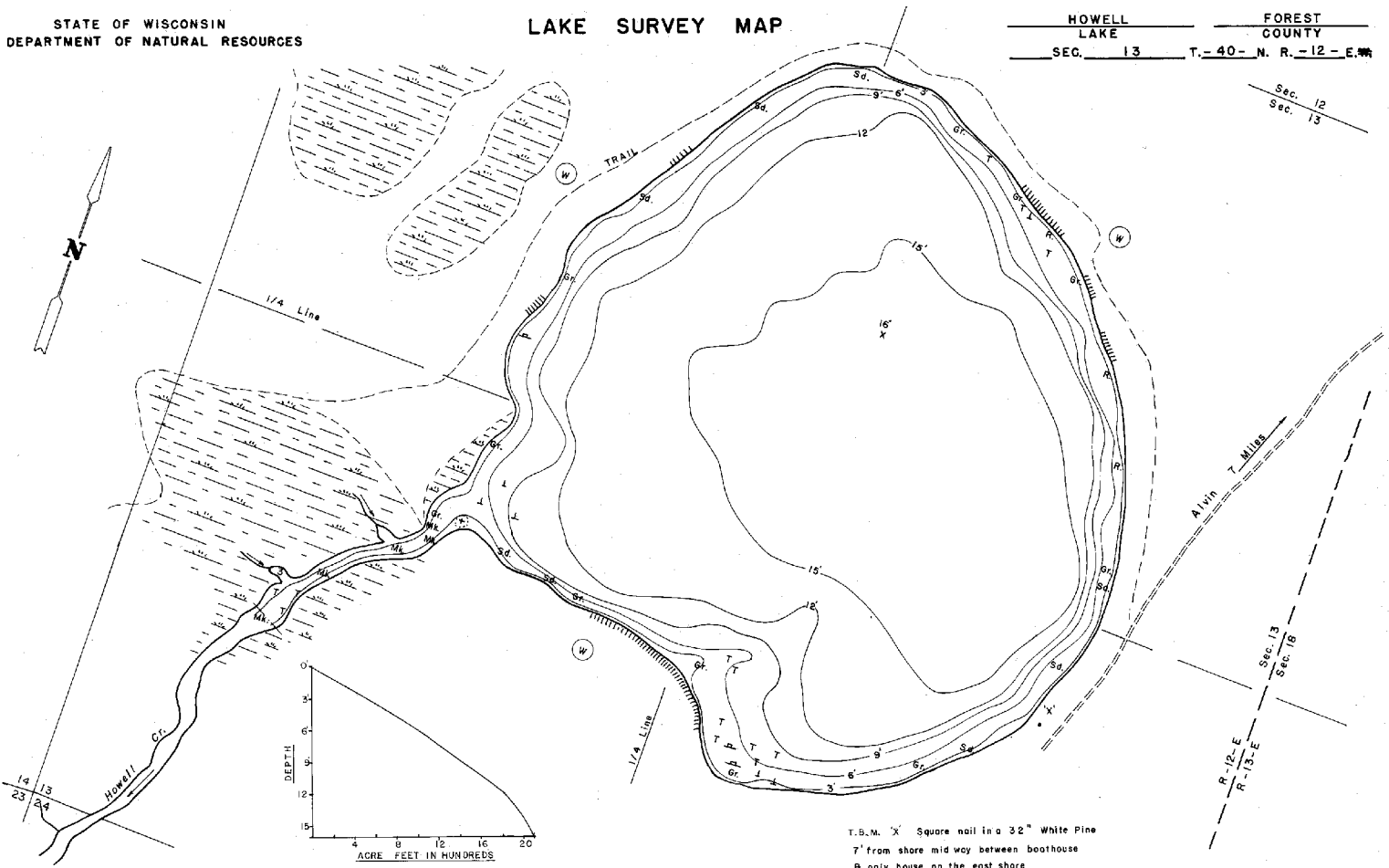

T.B.M. 'X' Square nail in a 32" White Pine
7' from shore mid way between boathouse
B only house on the east shore
Assumed Elevation 100.00'
Water Level 97.42'

EQUIPMENT RECORDING SONAR MAPPED AUGUST 1978
MONTH YEAR

- | TOPOGRAPHIC SYMBOLS | | LAKE BOTTOM SYMBOLS | |
|---------------------|----------------------------|---------------------|-------------------------------|
| (B) Brush | () Steep slope | P. Peat | B. Boulders |
| (PW) Partly wooded | (---) Indefinite shoreline | Mk. Muck | (S) Stumps & Snags |
| (W) Wooded | (M) Marsh | C. Clay | (R) Rock danger to navigation |
| (C) Cleared | (S) Spring | M. Marl | (V) Submergent vegetation |
| (P) Pastured | (---) Intermittent stream | Sd. Sand | (E) Emergent vegetation |
| (A) Agricultural | (---) Permanent inlet | St. Silt | (F) Floating vegetation |
| B.M. Bench Mark | (---) Permanent outlet | Gr. Gravel | (B) Brush shelters |
| (H) Dwelling | (L) Dam | R. Rubble | |
| (R) Resort | (D.N.R.) State owned land | Bc Bedrock | |
| (C) Camp | | | |

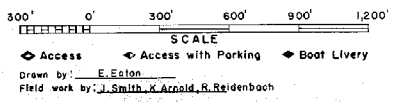

SPECIES OF FISH	STATUS		
	Abundant	Common	Present
Muskie			
N. Pike	X		
Walleye	X		
L. Micropterus	X		
S. M. Bass	X		
Panfish	X		
Trout			

WATER AREA 176.8 ACRES
UNDER 3 FT. 5 %
OVER 20 FT. 0 %
MAX. DEPTH 16 FEET
TOTAL ALK. 59 P.P.M.
VOLUME 2,037.2 ACRE FT.
MAIN SHORELINE 2.39 MI.
ISLAND SHORELINE MI

Maps are not for navigation
Source-Wisconsin Department of Natural Resources
Hunt Fish Camp Wisconsin .Com 2005