

STATE OF WISCONSIN
DEPARTMENT OF NATURAL RESOURCES

LAKE SURVEY MAP

HEMLOCK LAKE BARRON COUNTY
SEC. 25, 26, 27, 34, 35, 36 T. -36 - N. R. -10- W.

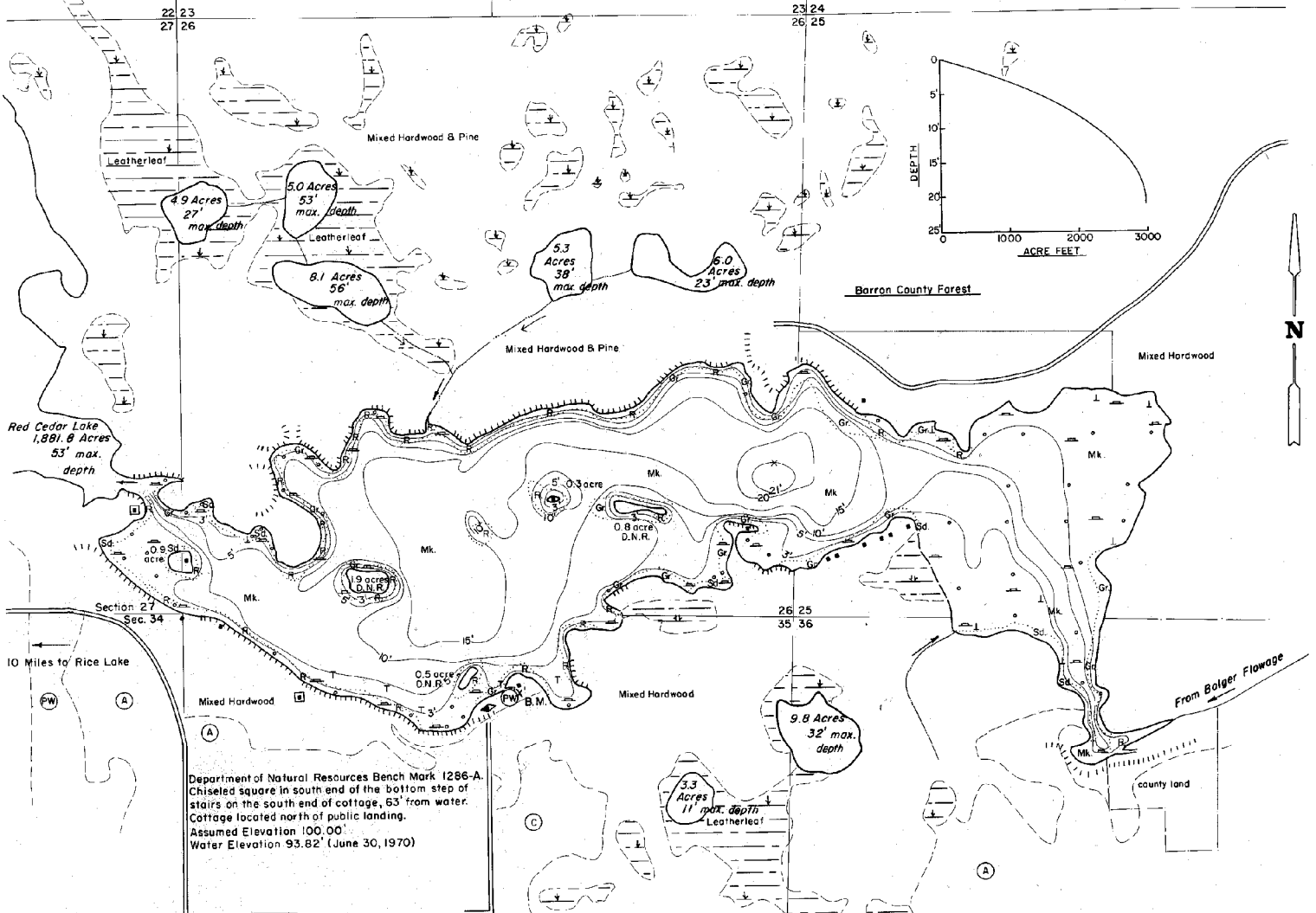

Department of Natural Resources Bench Mark 1286-A.
Chiseled square in south end of the bottom step of stairs on the south end of cottage, 63' from water.
Cottage located north of public landing.
Assumed Elevation 100.00'
Water Elevation 93.82' (June 30, 1970)

- EQUIPMENT RECORDING SONAR MAPPED JULY 1970
- TOPOGRAPHIC SYMBOLS
- (B) Brush
 - (PW) Partially wooded
 - (W) Wooded
 - (C) Cleared
 - (P) Pastured
 - (A) Agricultural
 - B.M. Bench Mark
 - Dwelling
 - Resort
 - Comp.
- LAKE BOTTOM SYMBOLS
- P. Peat
 - Mk. Muck
 - C. Clay
 - M. Marl
 - Sd. Sand
 - Sl. Silt
 - Gr. Gravel
 - R. Rubble
 - Br. Bedrock
 - B. Boulders
 - Stumps & Snags
 - Rock danger to navigation
 - T. Submergent vegetation
 - I. Emergent vegetation
 - Flooding vegetation
 - Brush shelters

600' 0 600' 1,200' 1,800' 2,400'

SCALE

◆ Access ◆ Access with Parking ◆ Boat Livery

Drawn by: J. Roth
Field work by: C. Busch, C. Stocks, L. Sather

SPECIES OF FISH	ABUNDANCE	
	Abundant	Present
Muskie		X
N. Pike	X	X
Walleye	X	X
L.M. Bass	X	X
S.M. Bass	X	X
Panfish	X	
Trot		

WATER AREA 357.4 ACRES

UNDER 3 FT. 27 %

OVER 20 FT. 2 %

MAX. DEPTH 21 FEET.

TOTAL ALK. 45 P.P.M.

VOLUME 2,965.0 ACRE FT.

SHORELINE 6.86 MILES

6.22 MILES OF SHORELINE EXCLUDING ISLANDS

Maps are not for navigation
Source-Wisconsin Department of Natural Resources
Hunt Fish Camp Wisconsin .Com 2005